

**A RESOLUTION OF INTENTION TO CREATE
RURAL IMPROVEMENT DISTRICT 2001-6 TO INCLUDE THE LOTS IN
THE VANDENBERGH VILLAGE AND VANDENBERGH VILLAGE EAST SUBDIVISIONS**

WHEREAS, Lewis and Clark County has developed a functional classification system for the road system within the jurisdiction; and

WHEREAS, revenues generated by the tax levy for roads are not sufficient to adequately maintain the entire road system without adversely affecting other County services; and

WHEREAS, the Board of County Commissioners has prioritized the maintenance and improvement expenditures on those portions of the road system that serve the general public and which facilitate economic activity, being those roads that are classified as arterial or collector in function; and

WHEREAS, the roads serving the Vandenberg Village and Vandenberg Village East Subdivisions are functionally classified as local roads; and

WHEREAS, the Board of County Commissioners has the authority to propose Rural Improvement Districts for the purpose of funding road improvements and/or maintenance, pursuant to Section 7-12-2101, et. seq., MCA.

NOW, THEREFORE, BE IT RESOLVED by the Lewis and Clark County Board of County Commissioners that it does hereby establish its intention to create the Vandenberg Village Rural Improvement District No. 2001-6 for the purpose of equitably funding road improvements and maintenance within said district.

BE IT FURTHER RESOLVED that the district shall include the lots developed as Vandenberg Village and Vandenberg Village East Subdivisions, and Parcel 1 and Parcel 2 on Certificate of Survey No. 507671/O, as identified on Exhibit "A", attached hereto and made a part hereof.

BE IT FURTHER RESOLVED that the engineer for the improvements is Stahly Engineering and Associates.

BE IT FURTHER RESOLVED that the improvements include reconstruction of selected areas with an asphalt mat (as necessary), surface preparation, and a single application (single shot) of chipseal surfacing. The improvements for Anderson Drive include reshaping and compaction of gravel surfaces.

BE IT FURTHER RESOLVED that the estimated annual costs for said improvements are \$8,250.50 for a period of ten (10) years. All funds collected for the improvement district shall be spent solely for the road improvements within the proposed district.

BE IT FURTHER RESOLVED that all properties within the district would benefit equally and would be assessed a flat fee for the improvements. Each lot or tract of record shall be assessed a flat fee of approximately \$103.13 per year for a period of ten (10) years, as shown and described on Exhibit "B".

BE IT FURTHER RESOLVED that a district for maintenance of the improvements shall be established, and that the boundaries of said maintenance district and the method of assessment for such maintenance shall be the same as the previously described improvement district.

BE IT FURTHER RESOLVED that the anticipated maintenance of the improvements may include routine pavement patching, crack sealing, sanding, street sweeping, snow plowing, signage, and grading (gravel sections). Additional maintenance activities could include resurfacing, drainage control, dust control, and other maintenance and repair as necessary to preserve the road surfaces.

BE IT FURTHER RESOLVED that the estimated annual costs for the anticipated maintenance are \$3,760.00. Each geocode shall be assessed approximately \$47.00 per year for said maintenance. This assessment will not provide for an adequate reserve for future chipseal applications or other maintenance. If a different level of maintenance is desired in the future, a description, cost estimate, and an assessment schedule would be developed and proposed through the required rate hearing procedure. All funds collected for the maintenance district shall be spent solely for the road maintenance activities within the proposed district.

BE IT FURTHER RESOLVED that the districts shall remain in effect in perpetuity or until such action by the Board of County Commissioners otherwise dissolves the districts.

BE IT FURTHER RESOLVED that any owner of property within the proposed districts may make protest against the creation of the districts, pursuant to Section 7-12-2109, MCA.

DATED this 20 day of March, 2001.

BOARD OF COUNTY COMMISSIONERS
LEWIS AND CLARK COUNTY

Karolin J. Locandri
Karolin J. Locandri, Chair

ATTEST:

Paulette J. DeHart
Paulette J. DeHart, Clerk of Board

Attachments: Exhibit "A"
Exhibit "B"

VandenberghRIDIntent.Doc

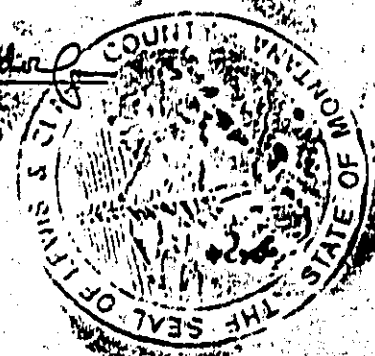

INDEXED
RECORDED

625927
PAULETTE DEHART CLK & REC
LEWIS & CLARK CO
MONTANA
01 MAR 22 PM 1:10
BOOK M24 PAGE 4937
BY Shuler, M. Shuler
mofee

EXHIBIT "A"

Proposed RID for the Vandenberg Village
and Vandenberg Village East Subdivisions

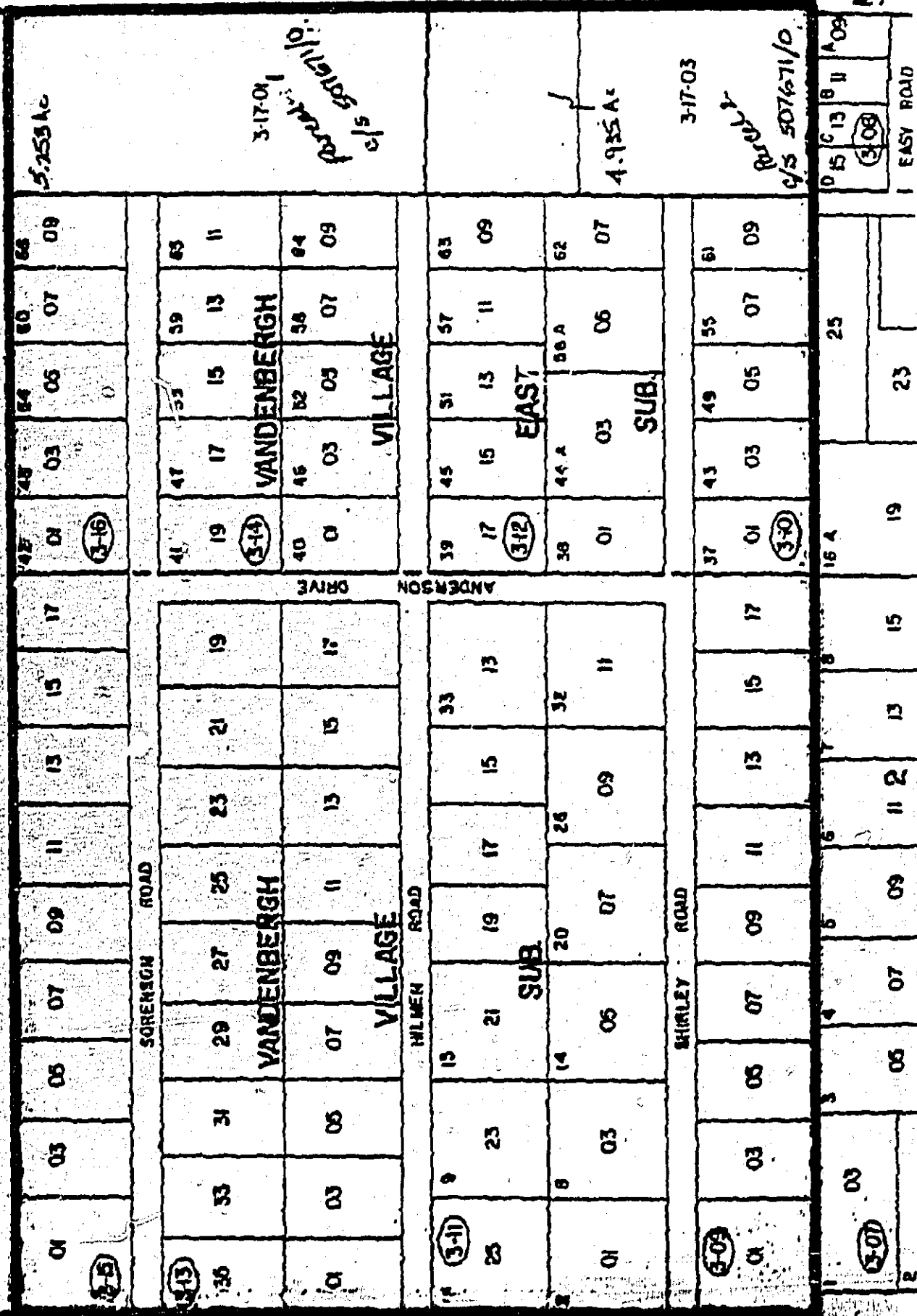

M	1
A	09
B	11
C	13
D	15
(3-08)	
EASY ROAD	

16 A	19	23
25		
15	13	11
13	15	17
11	13	15
09	11	13
07	09	11
05	07	09
03	05	07
01	03	05
37	43	49
39	45	51
38	44 A	50 A
36	42 A	48 A
35	41	47
34	39	45
33	37	43
32	36	42
31	35	41
30	34	40
29	33	39
28	32	38
27	31	37
26	30	36
25	29	35
24	28	34
23	27	33
22	26	32
21	25	31
20	24	30
19	23	29
18	22	28
17	21	27
16	20	26
15	19	25
14	18	24
13	17	23
12	16	22
11	15	21
10	14	20
09	13	19
08	12	18
07	11	17
06	10	16
05	09	15
04	08	14
03	07	13
02	06	12
01	05	11
3-11	3-12	3-13
3-14	3-15	3-16
3-17	3-18	3-19
3-20	3-21	3-22
3-23	3-24	3-25
3-26	3-27	3-28
3-29	3-30	3-31
3-32	3-33	3-34
3-35	3-36	3-37
3-38	3-39	3-40
3-41	3-42	3-43
3-44	3-45	3-46
3-47	3-48	3-49
3-50	3-51	3-52
3-53	3-54	3-55
3-56	3-57	3-58
3-59	3-60	3-61
3-62	3-63	3-64
3-65	3-66	3-67
3-68	3-69	3-70
3-71	3-72	3-73
3-74	3-75	3-76
3-77	3-78	3-79
3-80	3-81	3-82
3-83	3-84	3-85
3-86	3-87	3-88
3-89	3-90	3-91
3-92	3-93	3-94
3-95	3-96	3-97
3-98	3-99	3-100

EXHIBIT 'B' PROPOSED RID FOR VANDENBERGH VILLAGE & VANDENBERGH EAST LEGAL 1

EXHIBIT 'B' GEOCODE	PROPERTY OWNER	LEGAL 1	OLD PIN	ANNUAL ASSESSMENTS 7	IMPROVEMENT MAINTENANCE
199532309010000	HULTIN JAME E & DONNIE B	VANDENBERGH VILL-LT 1	000011839	\$103.13	\$47.00
199532309030000	BRIGHT GARY RICHARD	VANDENBERGH VILLAGE SUB BLK 1 W135' LT 7	000012549	\$103.13	\$47.00
199532309050000	COUNTRYMAN KIMBERLY A	VANDENBERG VILLAGE E70' LT 7 W70' LT 13	000011783	\$103.13	\$47.00
199532309070000	OLSEN DEAN D & DVANE K	VANDENBERGH VILLAGE BLK 1 E135' LT 13	000011674	\$103.13	\$47.00
199532309090000	SPARKS ALVIN D & LILLIAN M	VANDENBERGH VILLAGE BLK 1 E135' LT 19	000011650	\$103.13	\$47.00
199532309110000	BURGER STEVEN M & NACE RICKI S (JTROS)	VANDENBERGH VILLAGE SUB BLK 1	000011879	\$103.13	\$47.00
199532309130000	VONADA ROBERT J & MARTINEAU JAN	VANDENBERG VILLAGE BLK 1 E135 FT LT 25	000011573	\$103.13	\$47.00
199532309150000	BOURQUIN ARTHUR E	VANDENBERGH VILLAGE BLK 1 W2 LT 31	000011442	\$103.13	\$47.00
199532309170000	HOPKINS MARK JR & MARY E	VANDENBERGH VILLAGE BLK 1 E2 LT 31	000011826	\$103.13	\$47.00
199532310010000	HIGGINS THOMAS F & SHERRI M	VANDENBERGH VILLAGE EAST LT 37	000012457	\$103.13	\$47.00
199532310030000	PELLETIER RAYMOND & MYRA M	VANDENBERGH VILLAGE EAST LT 43	000012317	\$103.13	\$47.00
199532310050000	MCGREGOR JOHN SCOTT	VANDENBERGH VILLAGE EAST LT 49	000013241	\$103.13	\$47.00
199532310070000	GREENWOOD RONALD L & DONNA L	VANDENBERGH VILLAGE EAST LT 55	000013242	\$103.13	\$47.00
199532310090000	FLYNN FRANKLIN C & MARGARET A	VANDENBERGH VILLAGE EAST LT 61	000011718	\$103.13	\$47.00
199532311010000	BOWEN LARRY C & JUDY A	VANDENBERGH VILLAGE SUB LT 2	000012073	\$103.13	\$47.00
199532311030000	QUICK DAVID S & BECKY R	VANDENBERGH VILLAGE SUB BLK 1 LT 8	000012341	\$103.13	\$47.00
199532311050000	PAYNE DAVID M & GERRI J	VANDENBERGH VILLAGE SUB BLK 1 LT 14	000011677	\$103.13	\$47.00
199532311070000	FITZPATRICK WILLIAM G & LOIS A	VANDENBERGH VILLAGE SUB BLK 1 LT 20	000012169	\$103.13	\$47.00
199532311090000	WADE GLEN G & ANNETTE M	VANDENBERGH VILLAGE BLK 1 LT 26	000012010	\$103.13	\$47.00
199532311110000	BENYO JUDITH ANNE	VANDENBERGH VILLAGE SUB BLK 1 LT 32	000012312	\$103.13	\$47.00
199532311130000	WATNE BRANNDON L & KELLY M (JTROS)	VANDENBERGH VILLAGE BLK 1 LT 33	000011449	\$103.13	\$47.00
199532311150000	HAYES THOMAS	VANDENBERG VILLAGE BLK 1 E135' OF LT 27	000012366	\$103.13	\$47.00
199532311170000	MANSON CHARLES H & KATHLEEN M	E70' LT 21 W70' LT 27	000012072	\$103.13	\$47.00
199532311190000	SANDERS PAUL E & PAULA F	VANDENBERGG VILLAGE W 135 FT LT 21	000012502	\$103.13	\$47.00
199532311210000	KOENIG KELLY & PAMELA (JTROS)	VANDENBERGH VILLAGE SUB BLK 1 LT 15	000011974	\$103.13	\$47.00
199532311230000	STRICKLAND WILLIAM H & CHERYL	VANDENBERGH VILL-BLK 1 LT 9	000011359	\$103.13	\$47.00
199532311250000	WILSON JACK	VANDENBERG VILLAGE LOT 3	000012571	\$103.13	\$47.00
199532312010000	GORDON DONALD E & KATHLEEN C	VANDENBERGH VILLAGE EAST LT 38	000011704	\$103.13	\$47.00
199532312030000	RETZ E DEAN & SUSAN	VANDENBERGH VILLAGE EAST LT 44A	000011868	\$103.13	\$47.00
199532312050000	RICKER ROBERT P & GAIL T	VANDENBERGH VILLAGE EAST LT 56A	000011869	\$103.13	\$47.00
199532312070000	CHRISTENSEN KENNETH D & MARLY	VANDENBERGH VILLAGE EAST LT 62	000012376	\$103.13	\$47.00
199532312090000	SMITH DEWEY L & TAMMERA L (JTROS)	VANDENBERGH VILLAGE EAST SUB LT 63	000012025	\$103.13	\$47.00
199532312110000	SMITH WILLIAM A & SUZANNE H	LT 57	000011733	\$103.13	\$47.00
199532312130000	ROOPE KENNETH C & BEVERLY C	LT 51	000012152	\$103.13	\$47.00
199532312150000	BROWN BARRON K & BONNIE L	LT 45	000011459	\$103.13	\$47.00
199532312170000	MANGER MICHAEL J & LINDA C	LT 39	000012243	\$103.13	\$47.00
199532313010000	WEAVER JAMES R & JANE	W135' LT 4	000012394	\$103.13	\$47.00
199532313030000	GREANEY JAMES R & VICKY L	E70' LT 4 W70' LT 10	000011709	\$103.13	\$47.00
199532313050000	DUNDAS JAMES L & VIRGINIA A	E135' LT 10	000011429	\$103.13	\$47.00
199532313070000	HELM SCOTT M & CORA G	VANDENBERG VILLAGE BLK 1 W 135 FT LT 16	000011695	\$103.13	\$47.00
199532313090000	KUNTZ LARRY L JAMIE A & RAY	VANDENBERG VILLAGE E70' LT 16 270' LT 22	000011973	\$103.13	\$47.00
199532313110000	PARKER GLEN L & DOLORES M	E135' LT 22	000012185	\$103.13	\$47.00

EXHIBIT 'B' GEOCODE	PROPOSED RID FOR VANDENBERGH VILLAGE & VANDENBERGH EAST PROPERTY OWNER	LEGAL	OLD PW	ANNUAL ASSESSMENTS	
				IMPROVEMENT	MAINTENANCE
199532313130000	CHURCHWELL ROBERT E	W135' LT 26	000011522	\$103.13	\$47.00
199532313150000	NETTICK ERNEST D & MARY ELLEN	E70' LT 28 W70' LT 34	000012139	\$103.13	\$47.00
199532313170000	DROWN STEFANIE L	E149' LT 34	000011904	\$103.13	\$47.00
199532313190000	HALL TIM D	E149' LT 35	000012404	\$103.13	\$47.00
199532313210000	SLATER MARGERY A	E70' LT 29 W70' LT 35	000012370	\$103.13	\$47.00
199532313230000	COOK RALPH E & NELDA A	VANDENBERGH VILLAGE BLK 1 W135' LT 29	000011546	\$103.13	\$47.00
199532313250000	RUDE ARTHUR G & MARIAN I	VANDENBERGH VILLAGE BLK 1 W135' LT 23	000012534	\$103.13	\$47.00
199532313270000	DEMATO RICK & KATHERNE A JTWROS	VANDENBERG VILLAGE LTS E70'17 & W70' 23	000011521	\$103.13	\$47.00
199532313290000	WILER FRANK H	VANDENBERGH VILLAGE BLK 1 W 135' LT 17	000011929	\$103.13	\$47.00
199532313310000	BARBOUR TROY & KRISTAN	VANDENBERGH VILLAGE BLK 1 E135' LT 11	000011825	\$103.13	\$47.00
199532313330000	SCHULTZ MARK EDWARD	VANDENBERG VILLAGE BLK 1 E70 FT LT 5 &	000012329	\$103.13	\$47.00
199532313350000	SANDERSON NORWAN L & MYRNA F	VANDENBERGH VILLAGE SUB BLK 1 W135' LT 5	000012307	\$103.13	\$47.00
1995323134010000	KVAPP STEVEN J & REGINA	LT 40	000012201	\$103.13	\$47.00
1995323134030000	OTTOSON BARRY	VANDENBERGH VILLAGE EAST LOT 46	000011470	\$103.13	\$47.00
1995323134050000	BROWN JOHN L & PATRICIA L	LT 52	000011728	\$103.13	\$47.00
1995323134070000	BUCHANAN LYNN A & ANITA E	LT 58	000011469	\$103.13	\$47.00
1995323134090000	PETERS GERALD R & THELLIS C	LT 64	000011663	\$103.13	\$47.00
1995323134110000	DWYER PATRICK H	VANDENBERGH VILLAGE E LT 65	000011737	\$103.13	\$47.00
1995323134130000	TODD BETTY ANN	VANDENBERGH VILLAGE 3 LT 59	000011887	\$103.13	\$47.00
1995323134150000	BERGER RICHARD JAY & KAREN S	VANDENBERGH VILLAGE E LT 53	000011645	\$103.13	\$47.00
1995323134170000	YAGER DENNIS R & NANCY L	VANDENBERGH VILLAGE E LT 47	000011972	\$103.13	\$47.00
1995323134190000	RING RANDY B & ELEANORA M	VANDENBERGH VILLAGE E LT 41	000011888	\$103.13	\$47.00
1995323135010000	ROSE ALBERT F & EILEEN M	VANDENBERGH VILLAGE SUB BLK 1 LT 6	000012279	\$103.13	\$47.00
1995323135030000	VASHRO MICHAEL ALAN & GWENDOLY	VANDENBERGH VILLAGE BLK 1 W135' LT 12	000017606	\$103.13	\$47.00
1995323135050000	BUCHANAN DONALD A	E70' LT 12 W70' LT 18	000011488	\$103.13	\$47.00
1995323135070000	HORN KENNETH P & JANE K	VANDENBERGH VILLAGE BLK 1 W135' LT 18	000011818	\$103.13	\$47.00
1995323135090000	BARNES JAMES A & IMOGENE J	VANDENBERG VILLAGE BLK 1 W135 FT LT 24	000011396	\$103.13	\$47.00
1995323135110000	HIGGS W JOHN & MARY M	E70' LT 24 W70' LT 30	000012266	\$103.13	\$47.00
1995323135130000	KUMP MARK M & ANITA D	VANDENBERGH VILLAGE BLK E135' LT 30	000012444	\$103.13	\$47.00
1995323135150000	HANSON MARCELLA M	W134' LT 36	000011744	\$103.13	\$47.00
1995323135170000	SNELL ALAN VANCE & USA LEE	VANDENBERGH VILLAGE BLK 1 E135' LT 36	000011422	\$103.13	\$47.00
1995323136010000	KELLY MICHAEL THOMAS & LORETTA	VANDENBERGH VILLAGE E LT 42	000011742	\$103.13	\$47.00
1995323136030000	LESTIKO AUSTIN E & CAROL	VANDENBERGH VILLAGE E LT 48	000012016	\$103.13	\$47.00
1995323136050000	FROHRIECH JERRY R & CARRIE S	VANDENBERGH VILLAGE E LT 54	000012570	\$103.13	\$47.00
1995323136070000	BURNS RONALD E	VANDENBERGH VILLAGE E LT 60	000011406	\$103.13	\$47.00
1995323136090000	COVERDELL HARLAN F & LOIS O	VANDENBERGH VILLAGE E LT 66	000011551	\$103.13	\$47.00
1995323137010000	COVERDELL HARLAN F	PARCEL 1 PER C/S #507671/0	000012276	\$103.13	\$47.00
1995323137030000	ROMAN CATHOLIC BISHOP OF HELEN	PARCEL 2 PER C/S #507671/0	000024250	\$103.13	\$47.00