

RESOLUTION 2011- 15⁶

RESOLUTION TO CREATE AN AMENDED COUNTY RURAL IMPROVEMENT DISTRICT FOR TILLY COURT NUMBER 2011-2

WHEREAS, the Board of County Commissioners passed Resolution 2011-143 declaring an intention to create Rural Improvement District 2011-2 for Tilly Court; and

WHEREAS, three property owners protested the creation of the proposed district, an amount insufficient to account for more than 50% of the cost of the proposed program per MCA §7-12-2112(1), necessary to bar further proceedings.

WHEREAS, the Commission has chosen to amend their intention based upon consideration of public comment.

WHEREAS, the Commission has amended their intent to clarify designated items in MCA §7-12-2103(2) in the following manner:

- (a) The designated number of the district is 2011-2.
- (b) The boundaries are shown on "Exhibit A" and described on "Exhibit B".
- (c) The general character of the maintenance includes, but is not limited to, grading, snow plowing, signs, weed control, gravel and drainage features on the portion of Tilly Court within the Amended Plat of Lot 5 of the Tillerson Minor Subdivision.
- (d) Dowl HKM is the engineer to have charge of the work and the estimated cost for said maintenance is \$250.88 per year.
- (e) The method by which the cost shall be assessed is described in MCA §7-12-2151(d); each lot, tract, or parcel of land in the district may be assessed an equal amount based upon the total cost of the improvement; and

WHEREAS, the sole owner of property contained within the amended District has petitioned the County to create a Rural Improvement District.

WHEREAS, no protest period is required when the sole owner of the property to be included within the District (Lot 5 of the Tillerson Minor Subdivision) has submitted a petition requesting the creation of the district, per MCA §7-12-2102(2).

WHEREAS, the petition has been recorded through Resolution 2011-143.

NOW, THEREFORE LET IT BE RESOLVED, by the Lewis and Clark County Board of County Commissioners that it does hereby approve the creation of the Tilly Court Rural Improvement District Number 2011-2.

DATED this 15th day of SEPTEMBER, 2011.

BOARD OF COUNTY COMMISSIONERS
LEWIS AND CLARK COUNTY



Derek Brown, Chairman





Clerk of the Board

Exhibit "A" and Exhibit "B"



3209870
Page: 2 of 4
09/15/2011 02:39P
Bk-M44 Pg-901

Lewis & Clark County

COUNTY

LORI RD





Exhibit 'A'

Legend

-  Properties included within RID

Roadways

SURFACE

-  Roads to be serviced
-  PAVED
-  UNPAVED
-  DRIVEWAY

PIONEER PARK DR

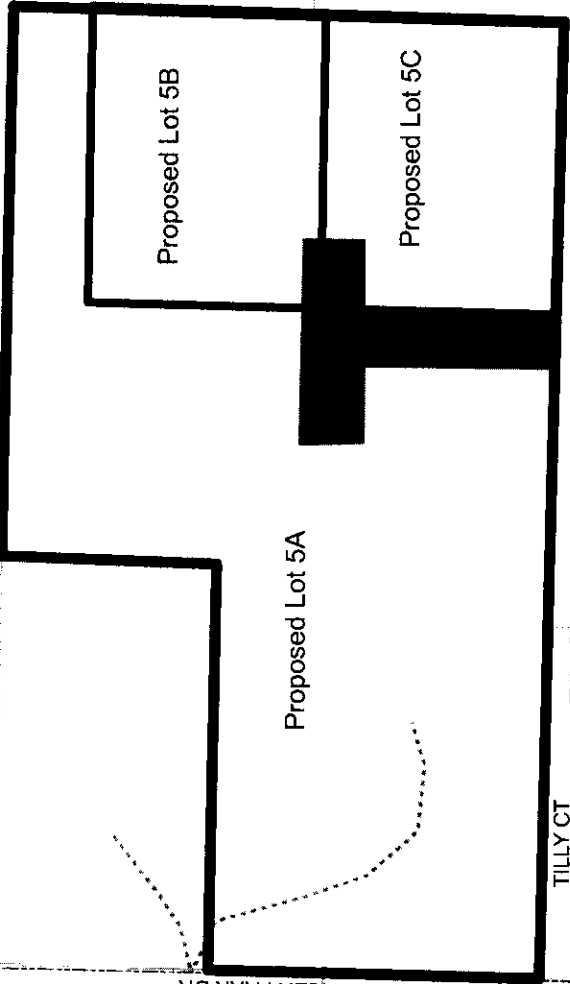

TILLY CT

Tilly Court

NANCY RD

JUSTICE CT



3209870

Page: 3 of 4

09/15/2011 02:39P

BK-144 Pg-901

Lewis & Clark County

Exhibit 'B'

Property Id	Owner Name	Legal Description	Estimated Annual Assessment
Not Assigned Yet	COX DALLAS E & KAREN A	TILLERSON MINOR SUBD, S12, T10 N, R03 W, Lot 5A (from Lot 5, COS 3009604, Geo 188812107150000)	\$83.63
Not Assigned Yet	COX DALLAS E & KAREN A	TILLERSON MINOR SUBD, S12, T10 N, R03 W, Lot 5B (from Lot 5, COS 3009604, Geo 188812107150000)	\$83.63
Not Assigned Yet	COX DALLAS E & KAREN A	TILLERSON MINOR SUBD, S12, T10 N, R03 W, Lot 5C (from Lot 5, COS 3009604, Geo 188812107150000)	\$83.63
Total Annual Assessment			\$250.88



3209870
 Page: 4 of 4
 09/15/2011 02:39P
 Blk-M44 Pg-901

Lewis & Clark County
COUNTY