

RESOLUTION 2008- 127

**RESOLUTION OF INTENTION TO CREATE
RURAL IMPROVEMENT DISTRICT 2008-9 FOR SKY VIEW**

WHEREAS, the Board of County Commissioners has the authority to propose Rural Improvement Districts for the purpose of funding road improvements and/or maintenance, pursuant to Section 7-12-2101, et. seq., MCA; and

WHEREAS, the roads included within the proposed RID are functionally classified as local roads; and

WHEREAS, the Board of County Commissioners has received a petition containing signatures of the owners of 60% of the parcels to be included in the proposed district.

NOW, THEREFORE, BE IT FURTHER RESOLVED by the Lewis and Clark County Board of County Commissioners that it does hereby establish its intention to create the Sky View Rural Improvement District Number 2008-9 for the purpose of equitably funding road improvements and maintenance within said district.

BE IT FURTHER RESOLVED that the district shall include lots as identified on Exhibit 'A' and Exhibit 'B' attached hereto and made a part thereof.

BE IT FURTHER RESOLVED that the engineer for the improvements is Stahly Engineering and Associates.

BE IT FURTHER RESOLVED that the general character of the improvements for the proposed Sky View RID shall include repairs and resurfacing.

BE IT FURTHER RESOLVED that the estimated annual cost for said improvements are \$9,996.25 for a period of ten (10) years. All funds collected for the improvement district shall be spent solely for the road improvements within the district.

BE IT FURTHER RESOLVED that all properties within the district would benefit equally and would be assessed an equal amount based upon the total cost of the improvement. Each parcel of record shall be assessed a flat fee of approximately \$80.77 per year for a period of ten (10) years.

BE IT FURTHER RESOLVED that a fund for maintenance of the improvements shall be established and assigned a separate entity code. Maintenance of the improvements may include, but are not limited to, pavement patching, chip sealing, crack sealing, sanding, street sweeping, snow plowing, drainage control, dust control, and signage.

BE IT FURTHER RESOLVED that the estimated annual costs for said maintenance are \$23,363.75. Each parcel shall be assessed approximately \$186.91 per year for said maintenance. This assessment shall provide a reserve for future chip seal applications or other maintenance.



All funds collected for the maintenance district shall be spent solely for the road maintenance activities within the proposed district.

BE IT FURTHER RESOLVED that the district shall remain in effect in perpetuity or until such action by the Board of County Commissioners otherwise dissolves the district.

BE IT FURTHER RESOLVED that any owner of property within the proposed district may make protest against the creation of the district, pursuant to Section 7-12-2109, MCA.

DATED this 25th day of November, 2008.

BOARD OF COUNTY COMMISSIONERS
LEWIS AND CLARK COUNTY

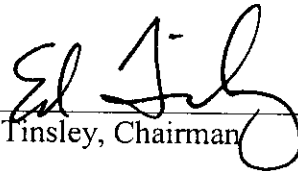
Ed Tinsley, Chairman

ATTEST:

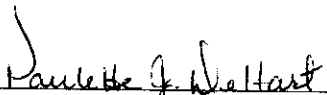
Paulette J. DeHart, Clerk of the Board



3157741
Page: 2 of 7
11/25/2008 02:03P
Bk-M39 Pg-2400

Lewis & Clark County

COUNTY

EXHIBIT "A"

Proposed Sky View RID

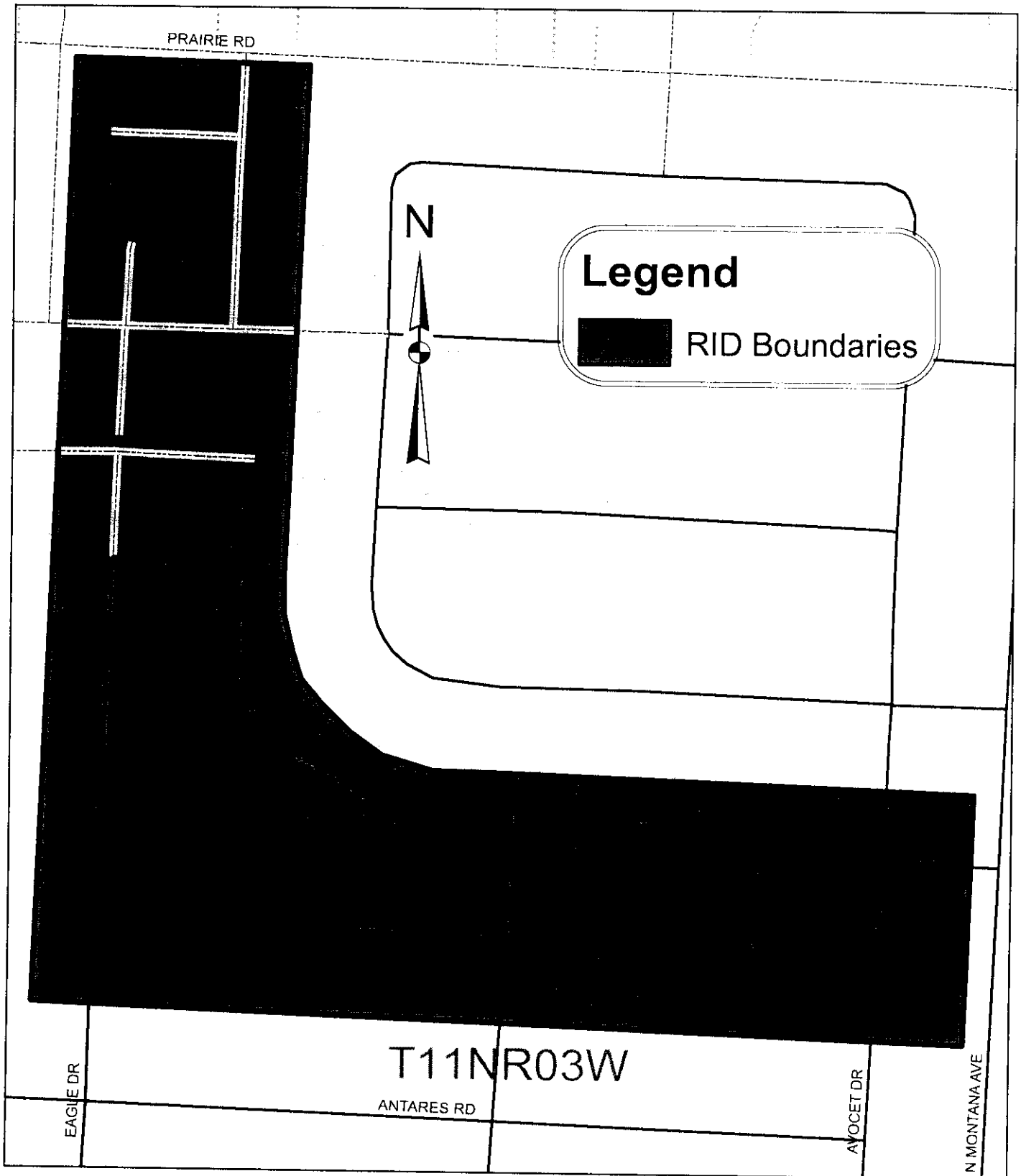

3157741

Page: 3 of 7
11/25/2008 02:03P

Lewis & Clark County

COUNTY

Bk-M39 Pg-2400

3157741

Page: 4 of 7
11/25/2008 02:03P

Blk-M99 Pg-2400



Lewis & Clark County

EXHIBIT "B"

SKY VIEW RID

PROPOSED ESTIMATED ANNUAL MAINTENANCE
IMPROVEMENT

GEO CODE	OWNER NAME	LEGAL DESCRIPTION	PROPOSED ESTIMATED IMPROVEMENT	PROPOSED ESTIMATED ANNUAL MAINTENANCE
199507109300000	WILLIAMS SANDRA L	TRACT 3A, COS #3103781, IN NW4NE4	\$79.97	\$186.91
199507112010000	FITE RENEE	SKYVIEW SUBD PHASE 1-A BLK 4 LT 1	\$79.97	\$186.91
199507112050000	LAMACH RICHARD S & KATHRYN A	SKYVIEW SUBD PHASE 1-A BLK 4 LT 2	\$79.97	\$186.91
199507112100000	EATON ALYSA	SKYVIEW SUBD PHASE 1-A BLK 4 LT 3	\$79.97	\$186.91
199507112150000	HOUSE MARY E	SKYVIEW SUBD PHASE 1-A BLK 4 LT 4	\$79.97	\$186.91
199507112200000	RICHEY ELMER E & BARBARA A	SKYVIEW SUBD PHASE 1-A BLK 4 LT 5	\$79.97	\$186.91
199507112250000	WITTMER SHAWN R & HEATHER	SKYVIEW SUBD PHASE 1-A BLK 4 LT 6	\$79.97	\$186.91
199507112300000	SILVONEN CHRISTOPHER B & JESSICA	SKYVIEW SUBD PHASE 1-A BLK 4 LT 7	\$79.97	\$186.91
199507112350000	CARNAHAN CASEY J	SKYVIEW SUBD PHASE 1-A BLK 4 LT 8	\$79.97	\$186.91
199507112400000	STILL KENDRA	SKYVIEW SUBD PHASE 1-A BLK 5 LT 1	\$79.97	\$186.91
199507112450000	HAFER GEORGE & CHARLOTTE K	SKYVIEW SUBD PHASE 1-A BLK 5 LT 2	\$79.97	\$186.91
199507112500000	MORLEY DAVID N & SUSANA L	SKYVIEW SUBD PHASE 1-A BLK 5 LT 3	\$79.97	\$186.91
199507112550000	MORRIS NATHAN T & CATHY M	SKYVIEW SUBD PHASE 1-A BLK 5 LT 4	\$79.97	\$186.91
199507112600000	ANDERSON CHRISTINE M KOESTER- & TO	SKYVIEW SUBD PHASE 1-A BLK 5 LT 5	\$79.97	\$186.91
199507112650000	GABRIEL SHANE A	SKYVIEW SUBD PHASE 1-A BLK 5 LT 6	\$79.97	\$186.91
199507112700000	PRUETT PATRICIA D	SKYVIEW SUBD PHASE 1-A BLK 5 LT 7	\$79.97	\$186.91
199507112750000	STEWART DARIN SCOTT	SKYVIEW SUBD PHASE 1-A BLK 5 LT 8	\$79.97	\$186.91
199507113010000	STEVENS GREG & AMANDA V	SKYVIEW SUBD PHASE 1-A BLK 3 LT 8	\$79.97	\$186.91
199507113050000	HOFMANN TRACY L	SKYVIEW SUBD PHASE I-A BLK 3 LT 7	\$79.97	\$186.91
199507113100000	WALL FRANCIS J & SHIRLEY A	SKYVIEW SUBD PHASE 1-A BLK 3 LT 6	\$79.97	\$186.91
199507113150000	ROSELAND ROSEMARIE RADICE &	SKYVIEW SUB PHASE II BLK 3 LT 5	\$79.97	\$186.91
199507113200000	YOUNKIN STEPHANIE A	SKYVIEW SUBD PHASE I-B BLK 3 LOT 4 PER	\$79.97	\$186.91
199507113250000	REARDON CHRISTY L & JAMES	SKYVIEW SUBD PHASE I-B BLK 3 LOT 3 PER	\$79.97	\$186.91
199507113300000	OVERCAST KIMBERLY A	SKYVIEW SUBD PHASE I-B BLK 3 LOT 2 PER	\$79.97	\$186.91
199507113350000	NOLAN KENNETH J	SKYVIEW SUBD PHASE I-B BLK 3 LOT 1	\$79.97	\$186.91
199507114010000	AQUAFLO LLC	SKYVIEW SUBD PHASE II BLK 3 LT 9A	\$79.97	\$186.91
199507114050000	BOWKER SHARON K	SKYVIEW SUBD PHASE II BLK 6 LT 1 PER COS	\$79.97	\$186.91
199507114100000	HIBBS TERRY R & ALLEN V	SKYVIEW SUBD PHASE II BLK 6 LT 2 PER COS	\$79.97	\$186.91
199507114150000	PRATT WILLIAM B	SKYVIEW SUBD PHASE II BLK 6 LT 3 PER COS	\$79.97	\$186.91
199507114200000	FLEURY JAMES E & CHERYL L	SKYVIEW SUBD PHASE II BLK 6 LT 4 PER COS	\$79.97	\$186.91
199507114250000	BARNES BRIAN C & LITA KAY	SKYVIEW SUBD PHASE II BLK 6 LT 5 PER COS	\$79.97	\$186.91
199507114300000	ANTONSEN PATRICK T & DIANA C	SKYVIEW SUBD PHASE II BLK 6 LT 6 PER COS	\$79.97	\$186.91
199507114350000	STOEBER MICHAEL W & JENNIFER A	SKYVIEW SUBD PHASE II BLK 6 LT 7 PER COS	\$79.97	\$186.91



3157741
 Page: 5 of 7
 11/25/2008 02:03P
 Lewis & Clark County Blk-#39 Pg-2400

EXHIBIT "B"
 SKY VIEW RID

GEO CODE	OWNER NAME	LEGAL DESCRIPTION	PROPOSED ESTIMATED IMPROVEMENT	PROPOSED ESTIMATED ANNUAL MAINTENANCE
19950711440000	WINTERS DEBRA J	SKYVIEW SUBD PHASE II BLK 6 LT 8 PER COS	\$79.97	\$186.91
199507115010000	LJINSTRA KEVIN & HEATHER A	SKYVIEW SUBD PHASE II BLK 7 LT 5 PER COS	\$79.97	\$186.91
199507115050000	WOOD LACEY JOLENE M & JAMES H	SKYVIEW SUBD PHASE II BLK 7 LT 4 PER COS	\$79.97	\$186.91
199507115100000	DISBURG BRIDGET C & TOM J	SKYVIEW SUBD PHASE II BLK 7 LT 3 PER COS	\$79.97	\$186.91
199507115150000	FARRY KEVIN L & WENDY J	SKYVIEW SUBD PHASE II BLK 7 LT 2 PER COS	\$79.97	\$186.91
199507115200000	CURTIS LEE R & M JUNE	SKYVIEW SUBD PHASE II BLK 7 LT 1 PER COS	\$79.97	\$186.91
199507115250000	AQUAFLO LLC	SKYVIEW SUBD PHASE II BLK 7 LT 6A	\$79.97	\$186.91
199507116010000	JKA-HERITAGE LLC	SKYVIEW SUBD PHASE I-B BLK 1 LOT 6	\$79.97	\$186.91
199507116100000	WEASEL TAIL JEANIE R	SKYVIEW SUBD PHASE I-B BLOCK 1 AMENDED	\$79.97	\$186.91
199507116150000	NORTHWOOD PROPERTIES	SKYVIEW SUBD PHASE I-B BLOCK 1 AMENDED	\$79.97	\$186.91
199507116200000	NORTHWOOD PROPERTIES	SKYVIEW SUBD PHASE I-B BLK 1 AMENDED LOT	\$79.97	\$186.91
199507117050000	PARRIMAN WILLIAM	SKYVIEW SUBD PHASE I-B BLOCK 1 AMENDED	\$79.97	\$186.91
199507118010000	FELDT JANET M &	SKYVIEW SUBD PHASE I-B BLOCK 2 LOT 1	\$79.97	\$186.91
199507118050000	MOE MARIA L	SKYVIEW SUBD PHASE I-B BLOCK 2 LOT 2 PER	\$79.97	\$186.91
199507118100000	STAATS JOHN D & SHERRIL	SKYVIEW SUBD PHASE I-B BLOCK 2 LOT 3 PER	\$79.97	\$186.91
199507118150000	WHITNEY DONALD M & PATRICIA I	SKYVIEW SUBD PHASE I-B BLOCK 2 LOT 4	\$79.97	\$186.91
199507118200000	STIER JERRY E & MARJORIE L	SKYVIEW SUBD PHASE I-B BLOCK 2 LOT 5	\$79.97	\$186.91
199507118250000	DELIN PROPERTIES LLC	SKYVIEW SUBD PHASE I-B BLOCK 2 LOT 6 PER	\$79.97	\$186.91
199507118300000	VERZATT CLARENCE G & BELVA E	SKYVIEW SUBD PHASE I-B BLOCK 2 LOT 7 PER	\$79.97	\$186.91
199507118350000	FRENCH SANDRA L	SKYVIEW SUBD PHASE I-B BLK 2 LOT 8 PER	\$79.97	\$186.91
199507118400000	SCHLAGECK LAURA K	SKYVIEW SUBD PHASE I-B BLK 2 LOT 9 PER	\$79.97	\$186.91
199507118450000	HANSEN JOEL C	SKYVIEW SUBD PHASE I-B BLK 2 LOT 10 PER	\$79.97	\$186.91
199507118500000	BOLES PATRICK J & MISTY A	SKYVIEW SUBD PHASE I-B BLK 2 LOT 11 PER	\$79.97	\$186.91
199507118550000	HENDERSON MADELINE E & CHRISTOPHE	SKYVIEW SUBD PHASE I-B BLK 2 LOT 12 PER	\$79.97	\$186.91
199507119010000	WIEGAND ALVIN & MARLENE	SKYVIEW SUBD PHASE III BLK 11 LOT 1 PER	\$79.97	\$186.91
199507119050000	DAY GERALD D & SUSAN ELLEN	SKYVIEW SUBD PHASE III BLK 11 LOT 2 PER	\$79.97	\$186.91
199507119100000	OWENS MICHELLE	SKYVIEW SUBD PHASE III BLK 11 LOT 3 PER	\$79.97	\$186.91
199507119150000	HENES, MICHELLE	SKYVIEW SUBD PHASE III BLK 11 LOT 4 PER	\$79.97	\$186.91
199507119200000	SMITH IRIS C	SKYVIEW SUBD PHASE III BLK 11 LOT 5	\$79.97	\$186.91
199507119250000	NOLAN CATHERINE E	SKYVIEW SUBD PHASE III BLK 11 LOT 6 PER	\$79.97	\$186.91
199507119300000	BROWN CATHY ANN	SKYVIEW SUBD PHASE III BLK 11 LOT 7	\$79.97	\$186.91
199507119350000	DUPLER JOSH & CHELSI	SKYVIEW SUBD PHASE III BLK 11 LOT 8 PER	\$79.97	\$186.91
199507119400000	CASSIDY JOHN & DANIELLE	SKYVIEW IVA BLOCK 11 LOT 9 COS #3042455	\$79.97	\$186.91



3157741
 Page: 6 of 7
 11/25/2008 02:03P
 Bk-#39 Pg-2400

EXHIBIT "B"
 SKY VIEW RID

PROPOSED ESTIMATED
 IMPROVEMENT ANNUAL
 MAINTENANCE

GEO CODE	OWNER NAME	LEGAL DESCRIPTION	PROPOSED ESTIMATED IMPROVEMENT	ANNUAL MAINTENANCE
199507119450000	ENGELBERT BRADLEY J & MELISSA G	SKYVIEW IVA BLOCK 11 LOT 10 COS #3042455	\$79.97	\$186.91
199507119500000	INAMA LYNNAE	SKYVIEW IVA BLOCK 11 LOT 11 COS #3042455	\$79.97	\$186.91
199507119550000	DONIAK DENE M & LINDA J	SKYVIEW IVA BLOCK 11 LOT 12 COS #3042455	\$79.97	\$186.91
199507119600000	ROODZANT KELTAN & ERICA	SKYVIEW IVA BLOCK 11 LOT 13 COS #3042455	\$79.97	\$186.91
199507119650000	AQUAFLO LLC	SKYVIEW IVA BLOCK 11 LOT 14 COS #3042455	\$79.97	\$186.91
199507119700000	REED EDWARD J M	SKYVIEW IVA BLOCK 11 LOT 15 COS #3042455	\$79.97	\$186.91
199507119750000	MURRAY KENNY P & DIEDRA L	SKYVIEW SUB PH IVB BLK 11 LT 16,	\$79.97	\$186.91
199507120010000	RICE WILLIAM M & BARBARA J	SKYVIEW SUBD PHASE III BLK 8 LOT 8 PER	\$79.97	\$186.91
199507120050000	BRICKER GARRETT P	SKYVIEW SUBD PHASE III BLK 8 LOT 7 PER	\$79.97	\$186.91
199507120100000	LOEWEN DAVID V	SKYVIEW SUBD PHASE III BLK 8 LOT 6 PER	\$79.97	\$186.91
199507120150000	FLATH BRANT M & BENTON REGAN L	SKYVIEW SUBD PHASE III BLK 8 LOT 5 PER	\$79.97	\$186.91
199507120200000	SUMMERLIN DENNIS E	SKYVIEW SUBD PHASE III BLK 8 LOT 4 PER	\$79.97	\$186.91
199507120250000	GOULD KIMBERLEE & BURK DAN R	SKYVIEW SUBD PHASE III BLK 8 LOT 3 PER	\$79.97	\$186.91
199507120300000	CHRISTIANSEN JOHN GORDON JR	SKYVIEW SUBD PHASE III BLK 8 LOT 2 PER	\$79.97	\$186.91
199507120350000	BAKER MARK A & MARIE LOUISE	SKYVIEW SUBD PHASE III BLK 8 LOT 1	\$79.97	\$186.91
199507120400000	BRAVO EFRAIN G JR	SKYVIEW 4 BLOCK 8 LOT 15 COS #3042455	\$79.97	\$186.91
199507120450000	KLEIN JOSHUA A & KRISTY L	SKYVIEW 4 BLOCK 8 LOT 16 COS #3042455	\$79.97	\$186.91
199507120500000	SVEE WAYNE	SKYVIEW 4 BLOCK 8 LOT 17 COS #3042455	\$79.97	\$186.91
199507120550000	FRY MATTHEW D & DEBORAH J	SKYVIEW IVA BLOCK 9 LOT 1A COS #3124024	\$79.97	\$186.91
199507120600000	PAYTON IAN A & CHARITY N	SKYVIEW IVA BLOCK 9 LOT 2A COS #3124024	\$79.97	\$186.91
199507120650000	LEVANG NEAL D & GOODIAN ASHLEY L	SKYVIEW IVA BLOCK 9 LOT 3A COS #3124024	\$79.97	\$186.91
199507120750000	WALKER WAYNE	SKYVIEW IVA BLOCK 9 LOT 5 COS #3042455	\$79.97	\$186.91
199507120800000	DOBYNS DAN & JOYCE	SKYVIEW IVA BLOCK 9 LOT 6 COS #3042455	\$79.97	\$186.91
199507120850000	ALBRECHT MELISSA K & RONALD D	SKYVIEW IVA BLOCK 9 LOT 7 COS #3042455	\$79.97	\$186.91
199507120900000	THOMPSON JOSHUA D	SKYVIEW IVA BLK 9 LOT 8 COS #3042455	\$79.97	\$186.91
199507120920000	HILL NICHOLAS R & ANNA S	SKYVIEW IVA BLOCK 9 LOT 9 COS #3042455	\$79.97	\$186.91
199507120940000	HARDMAN KRISTINE	SKYVIEW IVA BLOCK 9 LOT 10 COS #3042455	\$79.97	\$186.91
199507120960000	TAFT LINDA K	SKYVIEW IVA BLOCK 9 LOT 11 COS #3042455	\$79.97	\$186.91
199507120980000	WEST BRYNN & FOWLER RYAN	SKYVIEW IV A BLOCK 9 LOT 12 COS 3042455	\$79.97	\$186.91
199507121010000	TIELKING TAMMY S	SKYVIEW SUBD PHASE III BLK 8 LOT 11 PER	\$79.97	\$186.91
199507121050000	RODARTE STEVEN & TAMI	SKYVIEW SUBD PHASE III BLK 8 LOT 10	\$79.97	\$186.91
199507121100000	ADELBLUE JOSHUA LEE	SKYVIEW SUBD PHASE III BLK 8 LOT 9 PER	\$79.97	\$186.91
199507121150000	SALOIS CHARLES V & JENNIFER C	SKYVIEW SUBD PHASE III BLK 8 LOT 12	\$79.97	\$186.91



3157741
 Page: 7 of 7
 11/25/2008 02:03P
 BK-139 Pg-2400

EXHIBIT "B"
 SKY VIEW RID

PROPOSED ESTIMATED
 IMPROVEMENT ANNUAL
 MAINTENANCE

GEO CODE	OWNER NAME	LEGAL DESCRIPTION	PROPOSED ESTIMATED IMPROVEMENT	PROPOSED ESTIMATED ANNUAL MAINTENANCE
19950712120000	LEE MICHELLE G	SKYVIEW IVA BLOCK 8 LOT 20 COS #3042455	\$79.97	\$186.91
19950712125000	WILSON DOUGLAS E & JANICE L	SKYVIEW 4 BLOCK 8 LOT 19 COS #3042455	\$79.97	\$186.91
19950712130000	GEESLING KARI & THOMAS	SKYVIEW 4A BLOCK 8 LOT 18 COS #3042455	\$79.97	\$186.91
19950712135000	COBOS MARTIN JOSEPH & KIMBERLY CHF	SKYVIEW 4 BLOCK 8 LOT 14 COS #3042455	\$79.97	\$186.91
19950712140000	MASON SHANE C	SKYVIEW 4 BLOCK 8 LOT 13 COS #3042455	\$79.97	\$186.91
19950712201000	DAVIS JAHNA M	SKYVIEW SUB PH IVB BLK 9 LT 16,	\$79.97	\$186.91
19950712205000	LUCKEY CASSANDRA	SKYVIEW SUB PH IVB BLK 9 LT 15,	\$79.97	\$186.91
19950712210000	GREENE EMILY M	SKYVIEW SUB PH IVB BLK 9 LT 14	\$79.97	\$186.91
19950712215000	BEYER RANDAL R & JENNIFER J	SKYVIEW SUB PH IVB BLK 9 LT 13,	\$79.97	\$186.91
19950712301000	VILLAS AMELITA L	SKYVIEW SUB PH IVB BLK 10 LT 1,	\$79.97	\$186.91
19950712305000	BLOTKAMP SARAH	SKYVIEW SUB PH IVB BLK 10 LT 7,	\$79.97	\$186.91
19950712310000	PEAVEY JES M & JOLENE E	SKYVIEW SUB PH IVB BLK 10 LT 6,	\$79.97	\$186.91
19950712315000	BENTON MILES F & COLLEEN	SKYVIEW SUB PH IVB BLK 10 LT 5,	\$79.97	\$186.91
19950712320000	ARCHIE GREG R	SKYVIEW SUB PH IVB BLK 10 LT 2,	\$79.97	\$186.91
19950712401000	HUTCHINSON ROBERT ADAM & PRIDDY	SKYVIEW SUB PH IVB BLK 10 LT 3,	\$79.97	\$186.91
19950712405000	MILLHOUSE KEVIN J	SKYVIEW SUB PH IVB BLK 10 LT 4,	\$79.97	\$186.91
19950712410000	COCHRAN KATHLEEN A	SKYVIEW SUB PH IVB BLK 10 LT 11,	\$79.97	\$186.91
19950712415000	SCHROADER ALEX & JOLI	SKYVIEW SUB PH IVB BLK 10 LT 10,	\$79.97	\$186.91
19950712420000	MORANO STEVEN S & TRACY L	SKYVIEW SUB PH IVB BLK 10 LT 9,	\$79.97	\$186.91
19950712425000	MEUER STEVE & TANA	SKYVIEW SUB PH IVB BLK 10 LT 8,	\$79.97	\$186.91
19950712601000	PARKER ERIC & KIRSI H	SKYVIEW SUB PH IVB BLK 12 LT 1,	\$79.97	\$186.91
19950712605000	RICHARD JUSTIN JAY & HEATHER JEAN	SKYVIEW SUB PH IVB BLK 12 LT 2,	\$79.97	\$186.91
19950712610000	SHOBER REALTY LLC	SKYVIEW SUB PH IVB BLK 12 LT 3,	\$79.97	\$186.91
19950712615000	DIVELEY JILL & BEN	SKYVIEW SUB PH IVB BLK 12 LT 4,	\$79.97	\$186.91
19950712620000	BENHART PAUL D & KELLY M	SKYVIEW SUB PH IVB BLK 12 LT 5A,	\$79.97	\$186.91
19950712625000	REIGHARD MATTHEW J & VALERIE C	SKYVIEW SUB PH IVB BLK 12 LT 6A,	\$79.97	\$186.91