

A RESOLUTION OF INTENTION TO CREATE THE ROSEMARY RURAL IMPROVEMENT DISTRICT NO. 2007-1 FOR ROAD MAINTENANCE

WHEREAS, a petition has been received from the landowners in the Rosemary Acres Subdivision and the Rosemary Addition Subdivision, requesting that the County Commissioners create a Rural Improvement District for the purpose of maintaining Rosemary Drive, Sagebrush Drive, Thomas Court, Thyme Road, Chad Road, Coleman Road and Parsley Road, located in Section 24, T11N, R4W, P.M.M., Lewis and Clark County, as shown on the attached Exhibit "A"; and

WHEREAS, the petition included a description of the boundaries of the proposed district and benefiting lots, descriptions and cost estimates for the proposed maintenance, descriptions of the proposed method of assessment for and administration of maintenance, and was signed by 69.12% of the affected property owners; and

WHEREAS, the Board of County Commissioners has the authority to propose Rural Improvement Districts for the purpose of funding road maintenance, pursuant to Section 7-12-2101, et. seq., MCA.

NOW, THEREFORE, BE IT RESOLVED by the Lewis and Clark County Board of County Commissioners that it does hereby establish its intention to create the Rosemary Rural Improvement District No. 2007-1 for the purpose of equitably funding road maintenance for Rosemary Drive, Sagebrush Drive, Thomas Court, Thyme Road, Chad Road, Coleman Road and Parsley Road, located in Section 24, T11N, R4W, P.M.M., Lewis and Clark County.

BE IT FURTHER RESOLVED that said district will include those parcels of land abutting and/or accessing the roads and that the boundaries of the district are shown on Exhibit "A" and listed on Exhibit "B", attached hereto and made a part hereof.

BE IT FURTHER RESOLVED that only lots on Thomas Court will pay for maintenance of Thomas Court and the portion of Rosemary Drive used to get to Thomas Court; the lots will not pay for maintenance of the roads in Rosemary Acres.

BE IT FURTHER RESOLVED that the lots in the Rosemary Addition, fronting Rosemary Drive will contribute to the maintenance of Rosemary Drive and not Thomas Court or the roads in Rosemary Acres.

BE IT FURTHER RESOLVED that the lots in Rosemary Acres will be assessed for the maintenance of their roads and Rosemary Drive, but not Thomas Court.

BE IT FURTHER RESOLVED that the engineer for the County is Stahly Engineering and Associates.



Lewis & Clark County

COUNTY

3125015

Page: 1 of 6
03/15/2007 12:52P

Bk-M36 Pg-1831

BE IT FURTHER RESOLVED that annual costs for said maintenance are \$9,701.64. Each option will be charged separately and the funds will be used for the maintenance of those specific roads. A different fund will be set up for each option to keep the money separate. Some landowners may have more than one charge on their tax bill. The charges for the options are as follows:

Fund 1: Thomas Court Only:	\$179.17 per lot (lots on Thomas Court only)
Fund 2: All Rosemary Acres Roads:	\$117.50 per lot (Rosemary Acres lots only)
Fund 3: Lower Rosemary Drive:	\$ 17.74 per lot (all lots)

All funds collected for the maintenance district shall be spent solely for the road maintenance activities in the Rosemary Rural Improvement District.

BE IT FURTHER RESOLVED that the maintenance activities could include contribution to a fund for future chip seal application, crack sealing, snow plowing, sanding, sweeping, weed control, lighting, and other maintenance and repair as necessary to preserve the road surfaces. The estimated annual cost for said maintenance varies and is outlined above. The County will serve only to coordinate the necessary work, collect the assessments, and disburse payments for the district; it is anticipated that the maintenance would be performed by a private contractor.

BE IT FURTHER RESOLVED that the maintenance district shall remain in effect in perpetuity or until such action by the Board of County Commissioners otherwise dissolves the district.

BE IT FURTHER RESOLVED that any owner of property within the proposed districts may make protest against the creation of the districts, pursuant to Section 7-12-2109, MCA.

DATED this 15th day of March, 2007.

BOARD OF COUNTY COMMISSIONERS
LEWIS AND CLARK COUNTY

for Ed Frisby
Michael A. Murray, Chairman

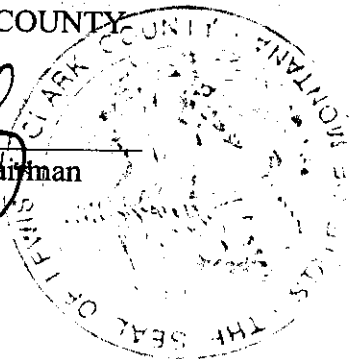

ATTEST:

Paulette J. DeHart
Paulette J. DeHart, Clerk of Board

Attachments: Exhibit "A"
Exhibit "B"

File: RosemaryResOfIntent



Lewis & Clark County

COUNTY

3125015
Page: 2 of 6
03/15/2007 12:52P
Bk-M36 Pg-1831



3125015

Page: 3 of 6
03/15/2007 12:52P

Lewis & Clark County

COUNTY

Bk-M36 Pg-1831

EXHIBIT "A"



BARRAUGH RD

Rosemary Maintenance District

BEST PLACE RD

PARSLEY RD

COLEMAN RD

CHAD RD

THYME RD

THOMAS CT

ROSEMARY DR

SAGEBRUSH DR

WHITTAIL WAY

JOHN G MINE RD

MARBLE RD

GREEN MEADOW DR

ANTELOPE WAY

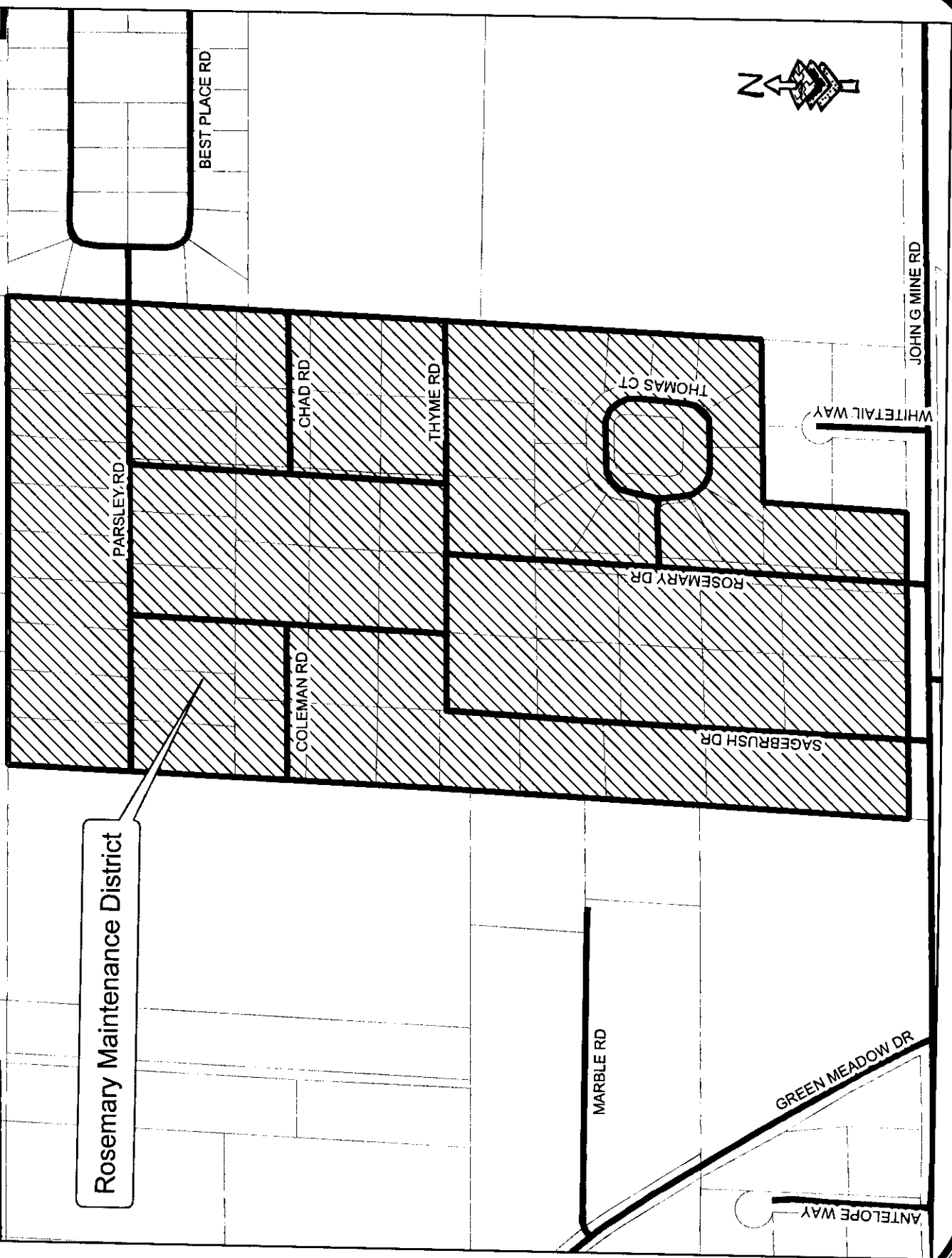

ROSEMARY RURAL MAINTENANCE DISTRICT

EXHIBIT "B"

MAINTENANCE ASSESSMENTS

GEOCODE	LANDOWNER NAME	LEGAL DESCRIPTION1	THOMAS COURT				LOWER ROSEMARY				TOTAL ANNUAL ASSESSMENT
			ONLY	ACRES ROADS	DRIVE ONLY	ROSEMARY	ACRES ROADS	DRIVE ONLY	ROSEMARY		
199424403050000	TIENSOLD KIRK M & LESLIE A	ROSEMARY'S ADDN LT 14	\$0.00	\$0.00	\$0.00	\$17.74	\$0.00	\$17.74	\$17.74	\$17.74	
199424403100000	SCHMIDT MATTHEW S & JUANITA M	ROSEMARY'S ADD LT 13	\$0.00	\$0.00	\$0.00	\$17.74	\$0.00	\$17.74	\$17.74	\$17.74	
199424403150000	CHARLTON ROBERT T JR & PAMELA	ROSEMARY ADD LT 4	\$179.17	\$0.00	\$0.00	\$17.74	\$0.00	\$17.74	\$17.74	\$196.91	
199424403200000	WHITE MARK J	ROSEMARY ADD LT 5	\$179.17	\$0.00	\$0.00	\$17.74	\$0.00	\$17.74	\$17.74	\$196.91	
199424403250000	BOYER CONSTANCE A	ROSEMARY ADD LT 6	\$179.17	\$0.00	\$0.00	\$17.74	\$0.00	\$17.74	\$17.74	\$196.91	
199424403300000	BRANSCUM HERCHEL T & JEAN A	ROSEMARY ADD LT 7	\$179.17	\$0.00	\$0.00	\$17.74	\$0.00	\$17.74	\$17.74	\$196.91	
199424403350000	HILTUNEN CHRISTOPHER P & MELISSA A	ROSEMARY ADD LT 8	\$179.17	\$0.00	\$0.00	\$17.74	\$0.00	\$17.74	\$17.74	\$196.91	
199424403400000	KEMP ROY P & DENISE	ROSEMARY ADD LT 9	\$179.17	\$0.00	\$0.00	\$17.74	\$0.00	\$17.74	\$17.74	\$196.91	
199424403450000	BOUCHARD DELL R & KRISTIN M	ROSEMARY ADD LT 10	\$179.17	\$0.00	\$0.00	\$17.74	\$0.00	\$17.74	\$17.74	\$196.91	
199424403500000	CADWELL LORI K	ROSEMARY ADD LT 11	\$179.17	\$0.00	\$0.00	\$17.74	\$0.00	\$17.74	\$17.74	\$196.91	
199424403550000	ASKAM STEVEN A & BILLIE L	ROSEMARY ADD LT 12	\$179.17	\$0.00	\$0.00	\$17.74	\$0.00	\$17.74	\$17.74	\$196.91	
199424403600000	DEBRAY HERMAN A	ROSEMARY ADD LT 1	\$179.17	\$0.00	\$0.00	\$17.74	\$0.00	\$17.74	\$17.74	\$196.91	
199424403650000	MITCHELL KELLY A & CHERYL A	ROSEMARY ADD LT 2 COS #303509	\$179.17	\$0.00	\$0.00	\$17.74	\$0.00	\$17.74	\$17.74	\$196.91	
199424407020000	HAAS GREG K & CARLA J	ROSEMARY ADD LT 3	\$179.17	\$0.00	\$0.00	\$17.74	\$0.00	\$17.74	\$17.74	\$196.91	
199424407040000	VULK JESSE & GOETTLE	ROSEMARY ACRES LT A-1 AMENDED LT A1-1	\$0.00	\$117.50	\$0.00	\$17.74	\$117.50	\$17.74	\$17.74	\$135.24	
199424407060000	ANDERSON MICHAEL A & SHERI D	ROSEMARY ACRES LT A-1 AMENDED LT A1-2	\$0.00	\$117.50	\$0.00	\$17.74	\$117.50	\$17.74	\$17.74	\$135.24	
199424407070000	CANNEY JASON & CHRISTINE	ROSEMARY ACRES LT A-1 AMENDED LT A1-3	\$0.00	\$117.50	\$0.00	\$17.74	\$117.50	\$17.74	\$17.74	\$135.24	
199424407080000	SCHWABAUER AARON L & LEAH R	ROSEMARY ACRES LT A-1 AMENDED LT A1-4	\$0.00	\$117.50	\$0.00	\$17.74	\$117.50	\$17.74	\$17.74	\$135.24	
199424407090000	BALLANCE LAURA & NATHAN	ROSEMARY ACRES LT A-1 AMENDED LT A1-5	\$0.00	\$117.50	\$0.00	\$17.74	\$117.50	\$17.74	\$17.74	\$135.24	
199424407100000	COLE MICHAEL D	ROSEMARY ACRES LT A-1 AMENDED LT A1-6	\$0.00	\$117.50	\$0.00	\$17.74	\$117.50	\$17.74	\$17.74	\$135.24	
199424407120000	CROWDER JESSICA L & SAMPLES EMILY J	ROSEMARY ACRES LT A-1 AMENDED LT A1-7	\$0.00	\$117.50	\$0.00	\$17.74	\$117.50	\$17.74	\$17.74	\$135.24	
199424407130000	MAZANEC TRACI D & MICHAEL T	ROSEMARY ACRES LT A-1 AMENDED LT A1-8	\$0.00	\$117.50	\$0.00	\$17.74	\$117.50	\$17.74	\$17.74	\$135.24	
199424407140000	STEVENS CRAIG M & JESSICA L	ROSEMARY ACRES LT A-1 AMENDED LT A1-9	\$0.00	\$117.50	\$0.00	\$17.74	\$117.50	\$17.74	\$17.74	\$135.24	
199424407150000	AUCHTERLONIE ROBIN	ROSEMARY ACRES LT A-1 AMENDED LT A1-10	\$0.00	\$117.50	\$0.00	\$17.74	\$117.50	\$17.74	\$17.74	\$135.24	
199424407160000	VAN AKEN LENARD J & LYNN A	ROSEMARY ACRES LT A-1 AMENDED LT A1-11	\$0.00	\$117.50	\$0.00	\$17.74	\$117.50	\$17.74	\$17.74	\$135.24	
199424407170000	ALM BRENT R & ANGELA M	ROSEMARY ACRES LT A-1 AMENDED LT A1-12	\$0.00	\$117.50	\$0.00	\$17.74	\$117.50	\$17.74	\$17.74	\$135.24	
199424407180000	DAVIAU PAUL J & CONNIE J	ROSEMARY ACRES LT A-1 AMENDED LT A1-13	\$0.00	\$117.50	\$0.00	\$17.74	\$117.50	\$17.74	\$17.74	\$135.24	
199424407190000	CORTEZ ANDRES & JAIME	ROSEMARY ACRES LT A-1 AMENDED LT A1-14	\$0.00	\$117.50	\$0.00	\$17.74	\$117.50	\$17.74	\$17.74	\$135.24	
199424407200000	MCDONOUGH MARY J	ROSEMARY ACRES LT A-1 AMENDED LT A1-15	\$0.00	\$117.50	\$0.00	\$17.74	\$117.50	\$17.74	\$17.74	\$135.24	
199424407200000	MITCHELL RANDALL C & CINDY M	ROSEMARY ACRES LT A-1 AMENDED LT A1-16	\$0.00	\$117.50	\$0.00	\$17.74	\$117.50	\$17.74	\$17.74	\$135.24	
199424407200000	JARVIS NORMAN	ROSEMARY ACRES LT A-1 AMENDED LT A1-17	\$0.00	\$117.50	\$0.00	\$17.74	\$117.50	\$17.74	\$17.74	\$135.24	



3125015
 Page: 4 of 6
 03/15/2007 12:52P
 COUNTY
 Lewis & Clark County
 Bk-136 Pg-1831

ROSEMARY RURAL MAINTENANCE DISTRICT

EXHIBIT "B"

MAINTENANCE ASSESSMENTS

GEOCODE	LANDOWNER NAME	LEGAL DESCRIPTION	THOMAS COURT			LOWER ROSEMARY		TOTAL ANNUAL ASSESSMENT
			ONLY	ACRES ROADS	DRIVE ONLY	ASSESSMENT		
199424407210000	LANE RICHARD J & FARAH J	ROSEMARY ACRES LT A-1 AMENDED LT A1-18	\$0.00	\$117.50	\$17.74	\$135.24		
199424407220000	PICHELMAN LESLIE K & DEBRA A	ROSEMARY ACRES LT A-1 AMENDED LT A1-19	\$0.00	\$117.50	\$17.74	\$135.24		
199424407230000	MATLOCK JAMES L & AMI K	ROSEMARY ACRES LT A-1 AMENDED LT A1-20	\$0.00	\$117.50	\$17.74	\$135.24		
199424407240000	MORSE JEFFREY GREGG & SHAWNA MICHELE	ROSEMARY ACRES LT A-1 AMENDED LT A1-21	\$0.00	\$117.50	\$17.74	\$135.24		
199424407250000	WOOD DANIEL RAY	ROSEMARY ACRES LT A-1 AMENDED LT A1-22	\$0.00	\$117.50	\$17.74	\$135.24		
199424407260000	OLSON DEON RAY & JENNIFER HOPE	ROSEMARY ACRES LT A-1 AMENDED LT A1-23	\$0.00	\$117.50	\$17.74	\$135.24		
199424407270000	LAMER CHAD R & ANN C	ROSEMARY ACRES LT A-1 AMENDED LT A1-24	\$0.00	\$117.50	\$17.74	\$135.24		
199424407280000	ROLL JONATHAN J & AMY L	ROSEMARY ACRES LT A-1 AMENDED LT A1-25	\$0.00	\$117.50	\$17.74	\$135.24		
199424407290000	SWANSON GARY & MILLER KATHLEEN J	ROSEMARY ACRES LT A-1 AMENDED LT A1-26	\$0.00	\$117.50	\$17.74	\$135.24		
199424407300000	HILDENSTAB LENORE A	ROSEMARY ACRES LT A-1 AMENDED LT A1-27	\$0.00	\$117.50	\$17.74	\$135.24		
199424407310000	O'REILLY H MAUREEN	ROSEMARY ACRES LT A-1 AMENDED LT A1-28	\$0.00	\$117.50	\$17.74	\$135.24		
199424407320000	SHOEN JON V & JENNIFER T	ROSEMARY ACRES LT A-1 AMENDED LT A1-29	\$0.00	\$117.50	\$17.74	\$135.24		
199424407330000	THOMPSON LEE W & JESSICA L	ROSEMARY ACRES LT A-1 AMENDED LT A1-30	\$0.00	\$117.50	\$17.74	\$135.24		
199424407340000	ANDERSON STEPHEN L & THERESE M	ROSEMARY ACRES LT A-1 AMENDED LT A1-31	\$0.00	\$117.50	\$17.74	\$135.24		
199424407350000	MCLAUGHLAN FRANCIS G JR & D'ETE	ROSEMARY ACRES LT A-1 AMENDED LT A1-32	\$0.00	\$117.50	\$17.74	\$135.24		
199424407360000	COOPER WILLIAM D & KAY NOEL	ROSEMARY ACRES LT A-1 AMENDED LT A1-33	\$0.00	\$117.50	\$17.74	\$135.24		
199424407370000	DORR JENNIFER J & STEVEN E	ROSEMARY ACRES LT A-1 AMENDED LT A1-34	\$0.00	\$117.50	\$17.74	\$135.24		
199424407380000	HELLER LAWRENCE J & JOANN C	ROSEMARY ACRES LT A-1 AMENDED LT A1-35	\$0.00	\$117.50	\$17.74	\$135.24		
199424407390000	KENNEDY JOHN & JENNIFER	ROSEMARY ACRES LT A-1 AMENDED LT A1-36	\$0.00	\$117.50	\$17.74	\$135.24		
199424407400000	ANNAS PAMELA ZOE	ROSEMARY ACRES LT A-1 AMENDED LT A1-37	\$0.00	\$117.50	\$17.74	\$135.24		
199424407410000	BAHNY BRENT N & BOBBIE J	ROSEMARY ACRES LT A-1 AMENDED LT A1-38	\$0.00	\$117.50	\$17.74	\$135.24		
199424407420000	WARWICK SCOT D & LISA L	ROSEMARY ACRES LT A-1 AMENDED LT A1-39	\$0.00	\$117.50	\$17.74	\$135.24		
199424407430000	HARRISON MICHAEL J JR	ROSEMARY ACRES LT A-1 AMENDED LT A1-40	\$0.00	\$117.50	\$17.74	\$135.24		
199424407840000	HARREL CHRISTOPHER D & YULGA STEPHANIE M	ROSEMARY ACRES MINOR AMENDED LT A2	\$0.00	\$117.50	\$17.74	\$135.24		
199424407870000	BRIGHT DONALD R JR & LARESA E	ROSEMARY ACRES MINOR AMEND LT A5	\$0.00	\$117.50	\$17.74	\$135.24		
199424407900000	THEYS JEREMIAH & AMARA	ROSEMARY ACRES MINOR AMENDED LT A8	\$0.00	\$117.50	\$17.74	\$135.24		
199424407950000	ATCHISON MICHAEL B & TENLEE G	ROSEMARY ACRES MINOR SUBD. LT B,	\$0.00	\$117.50	\$17.74	\$135.24		
199424408010000	DEMERS GARY & MELISSA	ROSEMARY ACRES MINOR SUBD LT 3	\$0.00	\$117.50	\$17.74	\$135.24		
199424408030000	KUNDA RAPHAEL J & KAYTHI TA	ROSEMARY ACRES MINOR AMEND LT A11	\$0.00	\$117.50	\$17.74	\$135.24		
199424408060000	PHELAN TRACY M	ROSEMARY ACRES MINOR AMEND LT A10	\$0.00	\$117.50	\$17.74	\$135.24		
199424408090000	LEMMON DAVID A & ANGELA ML	ROSEMARY ACRES MINOR AMEND LT A7	\$0.00	\$117.50	\$17.74	\$135.24		



3125015
 Page: 5 of 6
 03/15/2007 12:52P
 Lewis & Clark County COUNTY Bk-1036 Pg-1831

ROSEMARY RURAL MAINTENANCE DISTRICT

EXHIBIT "B"

MAINTENANCE ASSESSMENTS

GEOCODE	LANDOWNER NAME	LEGAL DESCRIPTION ¹	THOMAS COURT	ALL ROSEMARY	LOWER ROSEMARY	TOTAL ANNUAL
			ONLY	ACRES ROADS	DRIVE ONLY	ASSESSMENT
199424408120000	LATKA MICHAEL R & KAREN J	ROSEMARY ACRES MINOR AMEND LT A4	\$0.00	\$117.50	\$17.74	\$135.24
199424408150000	COATE CARSON LEE & NAYDIA STARR	ROSEMARY ACRES MINOR AMEND LT A3	\$0.00	\$117.50	\$17.74	\$135.24
199424408180000	WOJTON JOSEPH M & DOROTHY A	ROSEMARY ACRES MINOR AMEND LT A6	\$0.00	\$117.50	\$17.74	\$135.24
199424408210000	TOBEL BRAD C & STORMY J	ROSEMARY ACRES MINOR AMEND LT A9	\$0.00	\$117.50	\$17.74	\$135.24
199424408240000	BLANKENSHIP DAVID	ROSEMARY ACRES MINOR SUBD LT C	\$0.00	\$117.50	\$17.74	\$135.24
199424408270000	CORBALLY ANDREA & JOHN	ROSEMARY ACRES MINOR SUBD LT D	\$0.00	\$117.50	\$17.74	\$135.24
			\$2,150.04	\$6,344.99	\$1,206.61	\$9,701.64

File: Excel\RIDs\Rosemary2007

Information transferred from Department of Revenue records, March, 2007

Print Date: March 12, 2007

3125015
 Page: 6 of 6
 03/15/2007 12:52P
 Lewis & Clark County
 Bk-1936 Pg-1831