

RESOLUTION 2002 - 88

**A RESOLUTION LEVYING AND ASSESSING A TAX UPON ALL  
BENEFITED PROPERTY WITHIN THE APPLGATE RURAL  
IMPROVEMENT DISTRICT NO. 94-6**

WHEREAS, the Board of County Commissioners properly created and established the Applegate Rural Improvement District No. 94-6, through Resolution 1994-190; and

WHEREAS, Section 7-12-2158, MCA, provides that the Board of County Commissioners shall by resolution levy and assess a tax upon all benefited property in a district created for such purpose; and

WHEREAS, Resolution 1994-190 provides a mechanism for assessing benefited properties for the improvements based upon the benefits received; and

WHEREAS, Section 7-12-2161, MCA, provides that the Board of County Commissioners may change the boundaries of an improvement district; and

WHEREAS, properties within the original district boundaries have been subdivided and additional lots now benefit and should be incorporated into the Rural Improvement District; and

WHEREAS, the property owners of lots within the Applegate Rural Improvement District and new lots to be annexed were notified pursuant to Section 7-12-2159, MCA; and

NOW, THEREFORE, BE IT RESOLVED by the Board of County Commissioners of Lewis and Clark County, that an annual assessment of \$113.19 per lot for the road improvements shall be levied and assessed upon all benefited property within the boundaries of Rural Improvement District No. 94-6.

BE IT FURTHER RESOLVED that the name of each owner, the property identification number, and the amount of annual assessment for each parcel is contained on Exhibit "A", attached hereto.

BE IT FURTHER RESOLVED that the assessment amount contained on attached Exhibit "A" shall be made in two equal payments by the day and month specified on the annual tax notice. Payments made after the specified dates shall be delinquent.



BE IT FURTHER RESOLVED that a map showing the new district boundary is contained on Exhibit "B", attached hereto.

DATED this 29 day of 08 August, 2002.

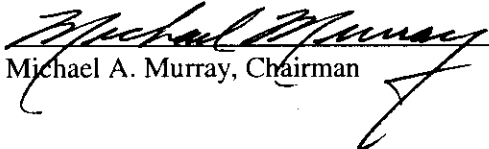
BOARD OF COUNTY COMMISSIONERS  
LEWIS AND CLARK COUNTY

  
Michael A. Murray, Chairman

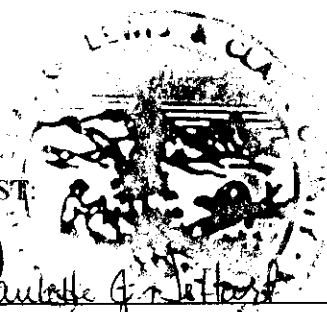
ATTEST:

  
  
Paulette J. DeHart, Clerk of Board

File: AppleImpRateResol



Lewis & Clark County

COUNTY

**3025196**

Page: 1 of 9  
09/04/2002 08:57A  
Bk-M27 Pg-52



3025196

Page: 2 of 9  
09/04/2002 08:57A  
Bk-M27 Pg-52

Lewis & Clark County

COUNTY

Property ID	Current Owner	Assessment
1	MARSHALL JOHNSON	\$113.19
2	STEVE & DEEANN SHULTZ	\$113.19
3	STEVEN D. & FLORENCE E. CORWIN	\$113.19
4	GERALD & CINDY WATERS	\$113.19
5	TIMOTHY R & DEBBIE L GUNDERSON	\$113.19
6	WILLIAM & HELEN MILLER	\$113.19
7	ROBERT W. & MARY C. MILLER	\$113.19
8	LOUIS E & SHERRI R BLOOD	\$113.19
9	HOWARD C SCHMITH	\$113.19
10	THEAL ANDERSEN WEAR	\$113.19
11	LORETTA L. MORRISON	\$113.19
12	RICHARD P & JULIE A BERGER	\$113.19
13	NATHE T & GAYLE M AMBROSE	\$113.19
14	ROBERT L. & OKA JA BURKE	\$113.19
15	PAUL & NANCY A. TREIB	\$113.19
16	BERNADETTE A. FREDRICK	\$113.19
17	JAMES J & REBECCA S BRIGHT	\$113.19
18	FRANCES E. MARLAR	\$113.19
19	WARREN E. WINTRODE	\$113.19
20	GERALDINE WALKER	\$113.19
21	ROBERT STEVEN & CYNTHIA CURRAN	\$113.19
22	CLARENCE & JANIE L. SMITH	\$113.19
23	TWILA J & RALPH W MORGAN	\$113.19
24	JAMES E. & VALERIE A. TRESNER	\$113.19
25	EILEEN HILL	\$113.19
26	JEFFERY L. KUNDA	\$113.19
27	JOHNNY D. HUFTL	\$113.19
28	GEORGE & SHERLEN F ROSEBOOM	\$113.19
29	RODERICK L. & LISA THOMPSON	\$113.19
30	SCOTT B PRESTON	\$113.19
31	DON O. JR & SHIRLEY A. GILBERT	\$113.19
32	ERNEST W. & DONNA J. LYLE	\$113.19
33	MAE O. PAIGE	\$113.19
34	RUSSELL T. & LISA R. GOWEN	\$113.19
35	EVERETT A. & RUTH E. VERLEY	\$113.19
36	MILDRED D REVELS & DIANE W MADRUGA	\$113.19
37	CYNTHIA Y WHITBECK	\$113.19
38	BILL D & SHERRI L ROBERTS	\$113.19
39	ROBERT & GAYLE L. CASEY	\$113.19
40	KEVIN L. & WENDIE A. FREDRICKSON	\$113.19



Lexis & Clark County

COUNTY

3025196

Page: 3 of 9  
09/04/2002 08:57A  
Bk-M27 Pg-52

Property ID	Current Owner	Assessment
41	MATHEW W JR & REBECCA LEE NICHOLLS	\$113.19
42	JOHN R. & JANET M. DUNN	\$113.19
43	ANNETTE E. & RALPH M. RINEHART	\$113.19
44	JOHN A. & LINDA M. MOOTS	\$113.19
45	CLIFFORD K. & DIANE S. GRANT	\$113.19
46	TIMOTHY A. & KERRY L. COULTER	\$113.19
47	TRAVIS W. BLANEY & SARAH E. MILLER	\$113.19
48	MICHELE D. JONES	\$113.19
49	DEBRA A. CRIDER	\$113.19
50	CHARLENE & BURT RAY	\$113.19
51	OWEN P. & BECKY J. VOIGT	\$113.19
52	CARL R. & JOYCE L. GOLIE	\$113.19
53	RICHARD C. & MONIKA C. WYSONG	\$113.19
54	VERNON J. & CAROL A. CHARLES	\$113.19
55	JOSEPH R. & MARGARET A. SMITH	\$113.19
56	FAYE L. & RUBY WOODALL	\$113.19
57	ANDREW D. & SHOHNEEN M. BICKLER	\$113.19
58	MARK L. & SANDRA L. ADAMS	\$113.19
59	RALPH A. COSLET	\$113.19
60	STEPHEN W. & JUDITH A. JOHNSON	\$113.19
61	FRANK & ORPHA BREWER	\$113.19
62	STEVE TRUEAX	\$113.19
63	STEVE S. & APRIL L. CARTER	\$113.19
64	WILLIAM G. WILKE	\$113.19
65	MELVIN L. KROLL	\$113.19
66	WALTER D. & CHARLOTT. HOFMEISTER	\$113.19
67	LARRY KIM SMITH	\$113.19
68	NICHOLAS G. & CONNIE M. NEWLON	\$113.19
69	MARY L. CHRISTIAN	\$113.19
70	EARL W. KOESTER	\$113.19
71	ALYNN A. HATLING	\$113.19
72	MICHAEL & MARY J. DOHLEN	\$113.19
73	JAMES F. WERNER & KAREN V. KONEN	\$113.19
74	LUIS A. MARRERO	\$113.19
75	JANET E. VAUGHAN	\$113.19
76	GARY & LORI MARTINSEN	\$113.19
77	RICK L. & MARY D. BAKER	\$113.19
78	MELVIN H. MCKENZIE JR	\$113.19
79	L. V. HARRIS	\$113.19
80	L. V. HARRIS	\$113.19

EXHIBIT "A"

Current Owner

Assessment



Lewis & Clark County COUNTY

	Property ID	Current Owner	Assessment
81	199424303010000	TIMOTHY R & DEBBIE L GUNDERSON	\$113.19
82	199424303250000	L V HARRIS	\$113.19
83	199424401010001	H. LEROY & DOLORES A. NEWTON	\$113.19
84	199424401200000	MARJORIE A. ROY	\$113.19
85	199424402010000	W J & CAROLYN T TRUSCOTT	\$113.19
86	199424402250000	STEVEN L. PILLATZKE	\$113.19
87	199424402300000	ALAN F. & MARTHA M. BOTTELSON	\$113.19
88	199424402350000	PATRICIA ANN TAYLOR	\$113.19
89	199424403100000	MATTHEW S & JUANITA M SCHMIDT	\$113.19
90	199424403150000	ROBERT T. JR. & PAMELA CHARLTON	\$113.19
91	199424403200000	MARK J. WHITE	\$113.19
92	199424403250000	CONSTANCE A. BOYER	\$113.19
93	199424403300000	HERCHEL T. & JEAN A. BRANSCUM	\$113.19
94	199424403350000	CHRISTOPHER P HILTUNEN	\$113.19
95	199424403400000	ROY P. & DENISE KEMP	\$113.19
96	199424403500000	LORI K. CADWELL	\$113.19
97	199424403550000	STEVEN A. & BILLIE L. ASKAM	\$113.19
98	199424403600000	HERMAN A. DEBRAY	\$113.19
99	199424403650000	KELLY A. & CHERYL A. MITCHELL	\$113.19
100	199424403700000	LYNNE M. & CHARLES H. JOHNSTON	\$113.19
101	199424404010000	GARY H. & YUVONNE HOOVESTAL	\$113.19
102	199425101150000	RICHARD D MYERS	\$113.19
103	199425101200000	JOHN J & NORA MCCARTHY	\$113.19
104	199425101250000	LAWRENCE & BONNIE HUNTER	\$113.19
105	199425101300000	LINDA STALLINGS	\$113.19
106	199425101400000	LINDA I. STALLINGS	\$113.19
107	199425101450000	JOHN P & HEATHER M MONDAY	\$113.19
108	199425102010000	JAN R & TED C RICHARDSON	\$113.19
109	199425102100000	MICHAEL L. & MICHELLE F. MCEWEN	\$113.19
110	199425102120000	BILL W & ROBIN R WARDELL	\$113.19
111	199425102140000	WAYNE L. WHITMAN TRUST	\$113.19
112	199425102160000	CHERYL A & GEORGE N DIAL	\$113.19
113	199425102200000	VINCENT & TERI LI JUNEAU ROCHE	\$113.19
114	199425102250000	WILLIAM A & SUSAN A DOTTER	\$113.19
115	199425102300000	EUNIECE W. WARDELL	\$113.19
116	199425102310000	BILL W. & ROBIN R. WARDELL	\$113.19
117	199425102330000	KENNETH R & DEBORAH J SWINGLEY	\$113.19
118	199425102350000	JOHN C. & BARBARA LYNN WARDELL	\$113.19
119	199425102400000	MICHAEL J HOSSFELD	\$113.19
120	199425102420000	DARRELL & DARLA SILVAN	\$113.19



Lewis & Clark County

COUNTY

	Property ID	Current Owner	Assessment
121	199425102430000	DAVID C. & MARYBETH GARDING	\$113.19
122	199425102450000	CHERYL M. SCHMIDT	\$113.19
123	199425102470000	JOHN P & ELAINE I PRUETT	\$113.19
124	199425102500000	KENT A. & JACQUELINE L. SMITH	\$113.19
125	199425102520000	DORIS ROMANISKO	\$113.19
126	199425102530000	BILL W. & ROBIN R. WARDELL	\$113.19
127	199425102600000	I.C.,LTD	\$113.19
128	199425102800000	ALFRED & VICKIE NETTLETON	\$113.19
129	199425402010000	MARK C & BETH BARRY	\$113.19
130	199425402100000	DAVID M & BARBARA J SCHULTZ	\$113.19
131	199425402120000	STEVEN DOUGLAS & JACQUELINE JEAN SAMPSON	\$113.19
132	199425402150000	GARY W HOOPER	\$113.19
133	199425402170000	RORY THOMAS & DEANNA L. HOFFMAN	\$113.19
134	199425402210000	GEORGE W & CHARLOTTE A ARCHIBALD	\$113.19
135	199425402250000	ALVIN E. & JUDITH B. WAGNER	\$113.19
136	199425402300000	WILLIAM J & DAWN I HROUDA	\$113.19
137	199425402350000	DAVID L. & CAROL M. SHACKELFORD	\$113.19
138	199425402400000	VIRGINIA T & RICHARD D BALDWIN TRUST	\$113.19
139	199425402450000	ALLEN C & KATHY M CHAMBERS	\$113.19
140	199425402600000	JAMES R. & PEGGY A. MCGOWAN	\$113.19
141	199425402650000	MICHAEL T & MARGARET GLUECKERT	\$113.19
142	199425402700000	CHESTER L. & SYLVIA KINSEY	\$113.19
143	199519201170000	NEW HOPE MINISTRIES UPC OF HELENA	\$113.19
144	199519201190000	THOMAS I & LINDA J BICKLER	\$113.19
145	199519201200000	CLARENCE & VIRGINIA H JOHNSON	\$113.19
146	199519201210000	ERIC J & BRANDI J COTTRILL	\$113.19
147	199519201220000	MARNEEL L GATES	\$113.19
148	199519201250000	ROBERT J SR & PATRICIA L VONADA	\$113.19
149	199519201600000	MYRON & TAMARA LAIB	\$113.19
150	199519301010000	EDWARD L & LEA ANN LARSON	\$113.19
151	199519301030000	DACRE A. & IRENE K. DUKE	\$113.19
152	199519301050000	DARRELL R. & ALLEGRA A. EHLERT	\$113.19
153	199519301110000	SAMUEL G. & ANNA S. DEAN	\$113.19
154	199519301130000	GREGORY J. & CATHY J. KOVICH	\$113.19
155	199519301170000	WILLIAM R. & CAROL J. HENWOOD	\$113.19
156	199519301190000	PAULA JEAN GROSSMAN	\$113.19
157	199519302010000	RICHARD S & KAREN S FERREIRA	\$113.19
158	199519302030000	RICK C & KATHY M SKINNER	\$113.19
159	199519302050000	CHARLES R & BONNIE A MUELLER	\$113.19
160	199519302070000	WARREN R & SUSAN A WINCHESTER	\$113.19

EXHIBIT "A"

Current Owner

Assessment



3025196

Page: 6 of 9  
09/04/2002 08:57A  
Bk-M27 Pg-52

Lewis & Clark County

COUNTY

	Property ID	Current Owner	Assessment
161	199519401010000	SAM G. & ANNA S. DEAN	\$113.19
162	199519401030000	ADAMS HAROLD E TRUSTEE	\$113.19
163	199519401050000	HAROLD G. ADAMS	\$113.19
164	199519401070001	H ADAMS & ASSOCIATES	\$113.19
165	199519401210001	JOHN O. & CARMMA J. PETERSON	\$113.19
166	199530101150000	WILLIAM D ROSSITER & PATRICIA ANN ROSSITER HALL	\$113.19
167	199530201100000	LARRY A. & SYLVIA J. MICHAELSON	\$113.19
168	199530201150000	CURTIS PAUL LAINGEN	\$113.19
169	199530201200000	DAVID N. & NOLA ROCK	\$113.19
170	199530201400000	BRITTON E & KELI STRATTON	\$113.19
171	199530201500000	RV RANCH	\$113.19
172	199530220010000	GEORGE W II & COLLEEN M ALLISON	\$113.19
173	199530220020000	GEORGE R. & IRENE E. TETRAULT	\$113.19
174	199530220030000	THOMAS E & SUSAN M WANDRYCH	\$113.19
175	199530220040000	BRIAN F & MISTI M NETTLETON	\$113.19
176	199530220050000	PATRICK J. RENNIE	\$113.19
177	199530220060000	LEONARD O. & CATHY A. SANDER	\$113.19
178	199530220070000	THERESA M. PETERSON	\$113.19
179	199530220080000	JOHN J. & CAROL LYNN FLYNN	\$113.19
180	199530220090000	NORMAN & KATHY CASMAN	\$113.19
181	199530220100000	RICHARD A III & KIELA M ELSHIRE	\$113.19
182	199530220110000	CHRIS A. & GINGERLEE YDE	\$113.19
183	199530220120000	JAMES J & AMY R ANDERSON	\$113.19
184	199530220130000	MELVIN G. & DIXIE LOU SHEPHARD	\$113.19
185	199530220140000	RICHARD ARNOLD & DONNA L. YANKE	\$113.19
186	199530220150000	GORDON & LORRAINE HOVLAND	\$113.19
187	199530220160000	JOEL E & KIMBERLY J SWARTZ	\$113.19
188	199530220170000	DARYL KEVIN & LESLIE DOREEN OLSEN	\$113.19
189	199530220180000	VERNON D. JONES & KATH WILLIAMS	\$113.19
190	199530220190000	GREGORY A. & AMY K. REEVES	\$113.19
191	199530220200000	SHERI R STUBBS	\$113.19
192	199530301150000	CLARENCE L. & REGINA APPELEGATE	\$113.19
193	199530301200000	JEFFREY A KIRBY	\$113.19
194	199531201250000	DAVID D. BRANDON	\$113.19
195	1994-24-1-02-02-0000	Duane A. & Christine M. Frederick	\$113.19
196	1994-24-1-02-50-0000	Benjamin A. & Christy L. Frederick	\$113.19
197	1994-24-1-03-13-0000	Sherman C. Smithson	\$113.19
198	1994-24-4-03-01-0000	Lewis & Clark County	\$113.19
199	1994-24-4-04-05-0000	Gary H. & Yvonne Hoovestal	\$113.19
200	1994-24-4-04-10-0000	Gary H. & Yvonne Hoovestal	\$113.19



3025196

Page: 7 of 9  
09/04/2002 08:57A  
Bk-M27 Pg-52

Lewis & Clark County

COUNTY

Property ID	Current Owner	Assessment
201	Gary H. & Yvonne Hoovestal	\$113.19
202	Donna Monday	\$113.19
203	Robert B. Jr. & Connie M. Cutler	\$113.19
204	Gary H. & Yvonne Hoovestal	\$113.19
205	Gary H. & Yvonne Hoovestal	\$113.19
206	Gary H. & Yvonne Hoovestal	\$113.19
207	Chandra Snyder	\$113.19
208	Richard A. & Doris R. Sparks	\$113.19
209	Blaine D. & Cynthia S. Gilbert	\$113.19
210	Elizabeth R. Salois	\$113.19
211	Paul A. & Christy M. Eisenpeter	\$113.19
212	Gary H. & Yvonne Hoovestal	\$113.19
213	Gary H. & Yvonne Hoovestal	\$113.19
214	Gary H. & Yvonne Hoovestal	\$113.19
215	Steven D. Erett & Sally Winn	\$113.19
216	Richard H. & Tamara R. Lewis	\$113.19
217	Deirdre & Lawrence P. Jr. Alheim	\$113.19
218	Gary H. & Yvonne Hoovestal	\$113.19
219	William & Gretchen Hedge	\$113.19
220	Gary H. & Yvonne Hoovestal	\$113.19
221	Gary H. & Yvonne Hoovestal	\$113.19
222	Gary H. & Yvonne Hoovestal	\$113.19
223	Gary H. & Yvonne Hoovestal	\$113.19
224	Gary H. & Yvonne Hoovestal	\$113.19
225	Gary H. & Yvonne Hoovestal	\$113.19
226	Gary H. & Yvonne Hoovestal	\$113.19
227	Ted A. Brodowy	\$113.19
228	Anthony C. & Brenda S. Williams	\$113.19
229	Mark W. & Kristie K. Rhodes	\$113.19
230	Joseph A. & Carla M. Hartman	\$113.19
231	Gary H. & Yvonne Hoovestal	\$113.19
232	Gary H. & Yvonne Hoovestal	\$113.19
233	Charles Henry McClain	\$113.19
234	Gary H. & Yvonne Hoovestal	\$113.19
235	Samuel H. McCulley	\$113.19
236	Gary H. & Yvonne Hoovestal	\$113.19
237	Haub Family Trust	\$113.19
238	Donald & Michelle Cloninger	\$113.19
239	Richard A. & Christy R. Shojquist	\$113.19
240	Mark F. & Katie A. Sather	\$113.19
	MAX M JENSEN	\$113.19

EXHIBIT "A"

Current Owner

Assessment



Lewis & Clark County

COUNTY

	Property ID	Current Owner	Assessment
241	199436103200000	ROBERT STEVEN CURRAN	\$113.19
242	199436103250000	GEORGE A JR & KATHY STIRNER	\$113.19
243	199436103300000	GEORGE A JR & KATHY STIRNER	\$113.19
244	199436103350000	MICHAEL W & KATHLEEN W SAMPSON	\$113.19
245	1994-36-1-03-40-0000	Dennis C. Drake	\$113.19
246	1994-36-1-03-45-0000	Gerald A. & Sherry L. East	\$113.19
247	1994-36-1-03-50-0000	F. Stephen & Shannon (JT/ROS) Messina	\$113.19
248	1994-36-1-04-01-0000	William M. & Maureen Baley	\$113.19
249	1994-36-1-04-05-0000	R/F Associates, LLC	\$113.19
250	1994-36-1-04-10-0000	Dennis G. & Charmaine M. McLaughlin	\$113.19
251	199436104150000	TIM B & LISA M MCMAHON	\$113.19
252	199436104200000	JEFFERY E & LISA I BLANFORD	\$113.19
253	1994-36-1-04-25-0000	Kevin J. & Anne Bartsch	\$113.19
254	1994-36-1-04-30-0000	Samuel H. McCulley	\$113.19
255	1994-36-1-04-35-0000	Brian R. & Brandon William & David Legg	\$113.19
256	19951910122AG00	LORENE GUETTLER	\$113.19
257	1995-19-2-01-23-0000	Jason L. & Sandra L. Snyder	\$113.19
258	1995-19-2-01-27-0000	Jean M. & Linda L. Lawrence	\$113.19
259	1995-19-2-01-29-0000	Clarice M. Johns & Roscoe L. Reynolds	\$113.19
260	1995-19-3-01-02-0000	David J. & Karen M. Kanta	\$113.19
261	19951930111SB11	DARRELL & ALLEGRA EHLETT	\$113.19
262	19951940119AG00	SAMUEL & ANNA DEAN	\$113.19
263	1995-30-2-01-18-0000	Raymond P. & Karen Peterson	\$113.19
264	19953030101AG00	WAYNE WILSON	\$113.19
265	1995-30-3-01-03-0000	W. Wayne & Maria J. Wilson	\$113.19
266	199531201010000	BRANDON DAVID D & WLM L & LEGG BRIAN	\$113.19
267	199530301050000	W WAYNE & MARLA J WILSON	\$113.19
268	199424407010000	GARY & MELISSA DEMERS	\$113.19
269	199424407030000	W J & CAROLYN T TRUSCOTT	\$113.19
270	199424407050000	DAVID BLANKENSHIP	\$113.19
271	199424407070000	W J & CAROLYN T TRUSCOTT	\$113.19
272	199424407950000	ANDREA E HALTER	\$113.19



EXHIBIT "B"  
APPLEGATE RID IMPROVEMENT  
DISTRICT BOUNDARIES

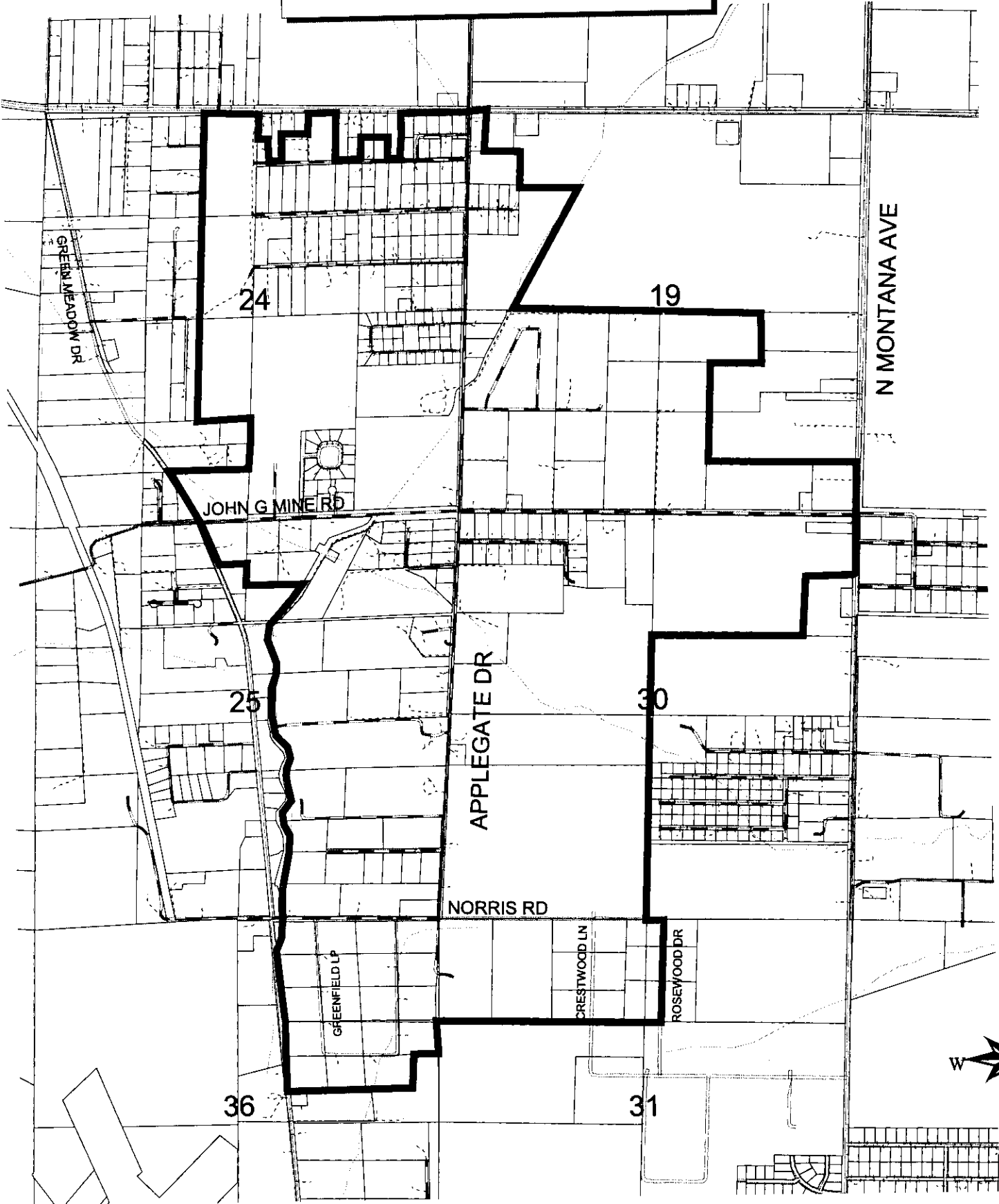

3025196

Page: 9 of 9  
09/04/2002 08:57A  
Bk-M27 Pg-52

