



RESOLUTION 2002 - 72

A RESOLUTION LEVYING AND ASSESSING A TAX UPON ALL
BENEFITED PROPERTY WITHIN THE APPLGATE RURAL
IMPROVEMENT DISTRICT NO. 94-6

WHEREAS, the Board of County Commissioners properly created and established the Applegate Rural
Improvement District No. 94-6, through Resolution 1994-190; and

WHEREAS, Section 7-12-2158, MCA, provides that the Board of County Commissioners shall by
resolution levy and assess a tax upon all benefited property in a district created for such purpose; and

WHEREAS, Resolution 1994-190 provides a mechanism for assessing benefited properties for maintenance
based upon the benefits received; and

WHEREAS, Section 7-12-2161, MCA, provides that the Board of County Commissioners may change
the boundaries of a maintenance district; and

WHEREAS, properties within the original district boundaries have been subdivided and additional lots
now benefit and should be incorporated into the Rural Improvement District; and

WHEREAS, the property owners of lots within the Applegate Rural Improvement District and new lots to be
annexed were notified pursuant to Section 7-12-2159, MCA; and

NOW, THEREFORE, BE IT RESOLVED by the Board of County Commissioners of Lewis and Clark
County, that an annual assessment of \$15.00 per lot for road maintenance activities shall be levied and assessed upon
all benefited property within the boundaries of Rural Improvement District No. 94-6.

BE IF FURTHER RESOLVED that this resolution applies only to the amount assessed for maintenance
activities shown under fund number 2145 (ApplgtMant) of the tax system.

BE IT FURTHER RESOLVED that a description of each parcel of land, the name of each owner, and the
amount of annual assessment for each parcel is contained on Exhibit "A", attached hereto.

BE IT FURTHER RESOLVED that the assessment amount contained on attached Exhibit "A" shall be
made in two equal payments by the day and month specified on the annual tax notice. Payments made after the
specified dates shall be delinquent.

BE IT FURTHER RESOLVED that a map showing the new district boundary is contained on Exhibit "B",
attached hereto.

DATED this 06 day of August, 2002.

BOARD OF COUNTY COMMISSIONERS
LEWIS AND CLARK COUNTY

Michael A. Murray, Chairman

ATTEST:
Paulette J. DeHart, Clerk of Board

EXHIBIT "A"

GEOCODE	PROPERTY LOCATION	PROPERTY OWNER	LEGAL1	OLD PIN NUMBER	MAINTENANCE ASSESSMENT	
199424101010001	215 HOPE RD	JOHNSON MARSHALL	GRIFFIN & DAVIS SUB LTS 43 & 44	000009722	\$15.00	
199424101100001	225 HOPE RD	SHULTZ STEVE & DEEANN	LT 45	000026478	\$15.00	
199424101110001	235 HOPE RD	CORWIN STEVEN D & FLORENCE E	GRIFFIN-DAVIS SUB LT 46	000009533	\$15.00	
199424101130000	239 HOPE RD	WATTERS GERALD & CINDY	GRIFFIN & DAVIS SUB: LTS 47-50	000026285	\$15.00	
199424101200001	325 HOPE RD	GUNDERSON TIMOTHY R & DEBBIE L	GRIFFIN DAVIS SUB LTS 51 & 52	000009584	\$15.00	
199424101260000	345 HOPE RD	MILLER WILLIAM & HELEN	GRIFFIN & DAVIS LT 54A COS 365506	000009588	\$15.00	
199424101270000	347 HOPE RD	MILLER ROBERT W & MARY C	LT 53A 1.857 AC	000010389	\$15.00	
199424101280000	349 HOPE RD	BLOOD LOUIS E & SHERRI R	LT 54 S150'.60 AC	000009923	\$15.00	
199424101290000	350 WOODSON RD	SCHMITH HOWARD C	GRIFFIN & DAVIS SUB LT 55S COS #286235	000010520	\$15.00	
199424101320000	356 WOODSON RD	GUSE HAROLD D & SHANNON ROSE	GRIFFIN & DAVIS SUB LTS 56S COS286235	000010521	\$15.00	
199424101350000	374 WOODSON RD	THIELE JAMES & GLENDA	TRACT 57 S COS 286235	000039855	\$15.00	
199424101370000	398 WOODSON RD	MORRISON LORETTA L	GRIFFIN & DAVIS SUBD LT 58S	000020495	\$15.00	
199424101390000	399 HOPE RD	BERGER RICHARD P & JULIE A	GRIFFIN DAVIS SUB LT 58N COS 286235	000020494	\$15.00	
199424101410000	375 HOPE RD	NATHE AMBROSE T & GAYLE M	GRIFFIN & DAVIS LT 57N 1.23 AC	000009471	\$15.00	
199424101420000	355 HOPE RD	BURKE ROBERT L & OK JA	LT 56 N 1.23 AC	000010545	\$15.00	
199424101440000	351 HOPE RD	TREIB PAUL & NANCY A	LT 55N 1.23 AC	000019862	\$15.00	
199424102010001	205 GRIFFIN RD	FREDRICK BERNADETTE A	GRIFFIN & DAVIS SUB LT 41A & 42A PER	COS 506829/E & 615926	000009562	\$15.00
199424102020000	200 HOPE RD	FREDRICK DUANE A & CHRISTINE M	GRIFFIN & DAVIS SUB LT 42B, COS #615926	000036270	\$15.00	
199424102030000	220 HOPE RD	BRIGHT JAMES J & REBECCA S	GRIFFIN & DAVIS SUB LT 40A COS 506829/E	000027535	\$15.00	
199424102050000	227 GRIFFIN RD	MARLAR FRANCES E	GRIFFIN DAVIS SUB LT 39	000009979	\$15.00	
199424102070000	234 HOPE RD	WINTRODE WARREN E	LT 38 2.19 AC	000022714	\$15.00	
199424102090000	232 HOPE RD	WALKER GERALDINE	LT 37 2.5 AC	000010450	\$15.00	
199424102110000	249 GRIFFIN RD	CURRAN ROBERT STEVEN & CYNTHIA	GRIFFIN DAVIS SUB N2 LT 36	000009306	\$15.00	
199424102130000	248 HOPE RD	SMITH CLARENCE & JANIE LOU	LT 36 52 1.25 AC	000010420	\$15.00	
199424102150000	286 HOPE RD	MORGAN TWILA J & RALPH W	GRIFFIN & DAVIS SUB LT 35S	000010421	\$15.00	
199424102170000	285 GRIFFIN RD	TRESNER JAMES E & VALERIE A	GRIFFIN DAVIS SUB 35N	000020785	\$15.00	
199424102190000	314 HOPE RD	HILL EILEEN	GRIFFIN & DAVIS SUB LOT 34	000010320	\$15.00	
199424102210000	320 HOPE RD	KUNDA JEFFERY L	LT 33 5 1.228 AC	000010330	\$15.00	
199424102230001	330 HOPE RD	HUFTTEL JOHNNY D	LT 32 S 252 FT	000009793	\$15.00	
199424102250000	348 HOPE RD	ROSEBOOM GEORGE & SHERLEN F	LT 31S2	000009735	\$15.00	
199424102270000	350 HOPE RD	THOMPSON RODERICK L & LISA	LT 30S2	000010242	\$15.00	
199424102290000	358 HOPE RD	PRESTON SCOTT B &	GRIFFIN & DAVIS SUBD S2 LT 29	COS #281135	000009282	\$15.00
199424102310000	380 HOPE RD	GILBERT DON C JR & SHIRLEY A	LT 28 S2	000009748	\$15.00	
199424102320000	375 GRIFFIN RD	LYLE ERNEST W & DONNA J	LT N2 OF 28	NASHUA 26X52 1999 S/N NNID38105A/	000023813	\$15.00
199424102330000	300 HOPE RD	PAIGE MAE C	LT S2 OF 27	000009736	\$15.00	
199424102350000	295 GRIFFIN RD	GOWEN RUSSELL T & LISA R	GRIFFIN DAVIS ADD LT 27A	000010519	\$15.00	
199424102390000	357 GRIFFIN RD	VERLEY EVERETT A & RUTH E	GRIFFIN DAVIS SUB N2 LT 29	000009741	\$15.00	
199424102410000	355 GRIFFIN RD	REVELS MILDRED D & MADRUGA DIANE W	GRIFFIN DAVIS SUB LT 30A C/S 276573	000017539	\$15.00	
199424102430000	345 GRIFFIN RD	WHITBECK CYNTHIA Y	GRIFFIN DAVIS SUB LT 31 N2	000009576	\$15.00	
199424102450000	335 GRIFFIN RD	ROBERTS BILL D & SHERRI L	GRIFFIN DAVIS SUB LT 32N2	GREAT LAKES 14X67 1975	000010163	\$15.00
199424102470000	301 GRIFFIN RD	CASEY ROBERT & GAYLE L	GRIFFIN DAVIS LT 33N	000023011	\$15.00	
199424102500000	201 GRIFFIN RD	FREDERICK BENJAMIN A & CHRISTY L	LT 42A, COS #615926	000036271	\$15.00	
199424103010000	202 GRIFFIN RD	FREDRICKSON KEVIN L & WENDIE A	GRIFFIN DAVIS SUB LT 13	000010344	\$15.00	
199424103030000	204 GRIFFIN RD	NICHOLLS MATTHEW W JR & REBECCA LEE	GRIFFIN-DAVIS SUB LT 14	000009401	\$15.00	
199424103050000	230 GRIFFIN RD	DUNN JOHN R & JANET M	GRIFFIN DAVIS SUB LT 15	000010440	\$15.00	
199424103070000	240 GRIFFIN RD	RINEHART ANNETTE E & RALPH M	GRIFFIN DAVIS SUB LT 16	000010090	\$15.00	
199424103100000	238 GRIFFIN RD	MOOTS JOHN A & LINDA M	GRIFFIN DAVIS SUB LT 17-18	000009360	\$15.00	
199424103120000	246 GRIFFIN RD	GRANT CLIFFORD K & DIANE S	GRIFFIN DAVIS SUB LT 19	000009745	\$15.00	
199424103130000	255 BONNER RD	SMITHSON SHERMAN C	GRIFFIN-DAVIS LOT 20 MINOR LT 20B	COS #549320/E	000028958	\$15.00
199424103140000	254 GRIFFIN RD	COULTER TIMOTHY A & KERRY L	GRIFFIN-DAVIS LOT 20 MINOR LT 20A	COS #549320/E	000010334	\$15.00
199424103150000	295 BONNER RD	BLANEY TRAVIS W & MILLER SARAH E	GRIFFIN DAVIS SUB LT 21A C/S 361630	TAMARACK 23X56 1977	000023395	\$15.00
199424103160000	262 GRIFFIN RD	JONES MICHELE D	GRIFFIN DAVIS SUB LT 21B	FLEETWOOD 28X44 1983	000022837	\$15.00
199424103180000	325 BONNER RD	CRIDER DEBRA A	GRIFFIN & DAVIS SUB:LT 22; 2.5 AC	000009440	\$15.00	
199424103200000	330 GRIFFIN RD	U S BANK NATIONAL ASSOCIATION	GRIFFIN DAVIS ADD LT 23	000010474	\$15.00	
199424103220000	340 GRIFFIN RD	VOIGT OWEN P & BECKY J	GRIFFIN & DAVIS LT 24A	000010283	\$15.00	
199424103240000	350 GRIFFIN RD	GOLIE CARL R & JOYCE L	GRIFFIN DAVIS SUB LT 26A	SKYLINE 12X60 1969	000019801	\$15.00
199424103260000	360 GRIFFIN RD	WYSONG RICHARD C & MONIKA C	GRIFFIN DAVIS SUB LT 26B	000019800	\$15.00	

*Kenny*



Lewis & Clark County

COUNTY

**3023610**  
 Page: 2 of 8  
 08/06/2002 11:32A  
 Bk-M26 Pg-8594

EXHIBIT "A"

GEOCODE	PROPERTY LOCATION	APPLGATE RID MAINTENANCE ASSESSMENTS 2002	LEGAL 1	OLD PIN NUMBER	MAINTENANCE ASSESSMENT
199424103280000	380 GRIFFIN RD	CHARLES VERNON J & CAROL A	GRIFFIN & DAVIS SUB LT 26C	000019802	\$15.00
199424103300000	388 GRIFFIN RD	SMITH JOSEPH R & MARGARET A	GRIFFIN DAVIS SUB LT 26D	0000021361	\$15.00
199424103340000	387 BONNER RD	WOODALL FAYE L & RUBY	LOT 25A	000009824	\$15.00
199424103350000	377 BONNER RD	BICKLER ANDREW D & SHONEEN M	GRIFFIN-DAVIS SUBD LOT 25C COS #344741	0000022866	\$15.00
199424103360000	0 UNKNOWN	ADAMS MARK L & SANDRA L	GRIFFIN DAVIS SUB LT 25B C/S 344741	000024837	\$15.00
199424103370000	367 BONNER RD	COSLET RALPH A	GRIFFIN DAVIS SUB LT 25D	000022867	\$15.00
199424103400000	357 BONNER RD	JOHNSON STEPHEN W & JUDITH A	GRIFFIN & DAVIS N2 LT 24	000022868	\$15.00
199424104010000	0 UNKNOWN	BREWER BEANK & ORPHA	LT 92 OF 12	000020604	\$15.00
199424104100000	235 BONNER RD	TRUEAX STEVE	GRIFFIN DAVIS SUB TR C C/S 413054/C	000023518	\$15.00
199424104110001	241 LINCOLN RD WEST	CARTER STEVE S & APRIL L	GRIFFIN DAVIS SUB TR B C/S 413054/C	000025276	\$15.00
199424104130000	236 LINCOLN RD WEST	WILKE WILLIAM G	PT LT 10 1.0276 AC. AKA TRA	000009494	\$15.00
199424104150000	242 BONNER RD	KROLL MELVIN L	GRIFFIN & DAVIS SUB LITS 7-8	000009870	\$15.00
199424104180000	0 UNKNOWN	HOFMEISTER WALTER D & CHARLOTT	GRIFFIN & DAVIS SUB. LOT 5A	000009868	\$15.00
199424104220000	300 BONNER RD	CLIFFORD MARVIN V	DORRANCE AMEND TO GRIFFIN & DAVIS SUB	000021776	\$15.00
199424104260000	320 BONNER RD	NEWLON NICHOLAS G & CONNIE M	GRIFFIN DAVIS SUB LT 35 C/S 275477	000021777	\$15.00
199424104320000	340 BONNER RD	CHRISTIAN MARY L	GRIFFIN & DAVIS SUB LT 1-B	000010282	\$15.00
199424104340000	349 LINCOLN RD WEST	KOESTER EARL W	GRIFFIN & DAVIS SUB LT 1A	000021358	\$15.00
199424104360000	360 JONATHAN RD	HATLENG ALYNN A J	APPLGATE EST LT 4	000009266	\$15.00
199424104380000	370 JONATHAN RD	DOHLEN MICHAEL & MARY J	APPLGATE ESTATES LT 3	000009398	\$15.00
199424104400000	380 JONATHAN RD	WERNER JAMES F & KONEN KAREN V	APPLGATE ESTATES LT 2	000010257	\$15.00
199424104420000	390 JONATHAN RD	MARRERO LUIS A	APPLGATE ESTATES LT 1	000009877	\$15.00
199424105010000	365 JONATHAN RD	VAUGHAN JANET E	APPLGATE ESTATES LT 5	000010258	\$15.00
199424105030000	375 JONATHAN RD	MARTINSEN GARY & LORI	APPLGATE ESTATES LT 6 & INT IN RD	000009328	\$15.00
199424105050000	385 JONATHAN RD	BAKER RICK L & MARY D	APPLGATE ESTATES SUB LT 7 & 90 FT OF	000010351	\$15.00
199424105070000	395 JONATHAN RD	MCKENZIE MELVIN H JR	APPLGATE ESTATES SUBD LT 8	000009546	\$15.00
199424202750000	0 UNKNOWN	JACKSON JULIA A & HARRIS ROBERT E	S2E2E2NW	000009652	\$15.00
199424202800000	0 UNKNOWN	JACKSON JULIA A & HARRIS ROBERT E	N2E2E2 NW	000024442	\$15.00
199424303010000	0 UNKNOWN	SMITH LARRY KIM	TR S2SESW	000009213	\$15.00
199424303250000	0 UNKNOWN	JACKSON JULIA A & HARRIS ROBERT E	E2NESW	000024443	\$15.00
199424401010001	7106 APPLGATE DR	NEWTON H LEROY & DOLORES A	SESE LITS C-D	000010254	\$15.00
199424401200000	7104 WHITE TAIL WAY	ROY MARJORIE A	VALLEY ACRES MINOR SUB LT 3 COS# 286395	000009489	\$15.00
199424402200000	7105 WHITE TAIL WAY	DEPARTMENT OF VETERANS AFFAIRS	VALLEY ACRES MINOR SUB LT 4	000009555	\$15.00
199424402250000	7113 WHITE TAIL WAY	PILATZKE STEVEN L	VALLEY ACRES MINOR SUB LT 1	000010164	\$15.00
199424402300000	7112 WHITE TAIL WAY	BOTTELSON ALAN F & MARTHA M	VALLEY ACRES MINOR SUB LT 2	000009268	\$15.00
199424402350000	7115 WHITE TAIL WAY	TAYLOR PATRICIA ANN	ROSEMARY'S ADDN LT 14	000009917	\$15.00
199424403000000	7125 ROSEMARY RD	ADAMS ALAN H	ROSEMARY'S ADD LT 13	000019857	\$15.00
199424403100000	271 THOMAS CT	SCHMIDT MATTHEW S & JUANITA M	ROSEMARY'S ADD LT 4	000019847	\$15.00
199424403250000	277 THOMAS CT	CHARLTON ROBERT T JR & PAMELA	ROSEMARY ADD LT 5	000019848	\$15.00
199424403250000	283 THOMAS CT	WHITE MARK J	ROSEMARY ADD LT 6	000019849	\$15.00
199424403300000	291 THOMAS CT	BOYER CONSTANCE A	ROSEMARY ADD LT 7	000019850	\$15.00
199424403350000	297 THOMAS CT	BRANSCUM HERCHEL T & JEAN A,	ROSEMARY ADD LT 8	000019851	\$15.00
199424403400000	296 THOMAS CT	HIL TUNEN CHRISTOPHER P	ROSEMARY ADD LT 9	000019852	\$15.00
199424403450000	292 THOMAS CT	KEMP ROY P & DENISE	ROSEMARY ADD LT 10	000019853	\$15.00
199424403500000	276 THOMAS CT	NORDAHL KENT E & RHONDA L	ROSEMARY ADD LT 11	000019854	\$15.00
199424403550000	268 THOMAS CT	CADWELL LORI K	ROSEMARY ADD LT 12	000019855	\$15.00
199424403600000	260 THOMAS CT	ASKAM STEVEN A & BILLIE L	ROSEMARY ADD LT 1	000019845	\$15.00
199424403650000	265 THOMAS CT	DEBRAY HERMAN A	ROSEMARY ADD LT 2	000019846	\$15.00
199424404010000	0 BEST PLACE RD	MITCHELL KELLY A & CHERYL A	ROSEMARY ADD LT 3	000019846	\$15.00
199424404050000	384 BEST PLACE RD	JOHNSTON LYNN M & CHARLES H	APPLGATE VILLAGE SUBD COMMON AREA	000029393	\$15.00
199424404100000	380 BEST PLACE RD	HOOVESTAL GARY H & YVONNE	APPLGATE VILLAGE SUBD LT 34	000029394	\$15.00
199424404150000	376 BEST PLACE RD	HOOVESTAL GARY H & YVONNE	APPLGATE VILLAGE SUBD LT 33 COS #575178	000029395	\$15.00
199424404200000	372 BEST PLACE RD	HOOVESTAL GARY H & YVONNE	APPLGATE VILLAGE SUBD LT 32 COS #575178	000029396	\$15.00
199424404250000	368 BEST PLACE RD	HOOVESTAL GARY H & YVONNE	APPLGATE VILLAGE SUBD LT 31 COS #575178	000029397	\$15.00
199424404300000	364 BEST PLACE RD	CUTLER ROBERT B JR & CONNIE M	APPLGATE VILLAGE SUBD LT 30 COS #575178	000029398	\$15.00
199424404350000	360 BEST PLACE RD	HOOVESTAL GARY H & YVONNE	APPLGATE VILLAGE SUBD LT 29 COS #575178	000029399	\$15.00
		HOOVESTAL GARY H & YVONNE	APPLGATE VILLAGE SUBD LT 28 COS #575178	000029400	\$15.00

3023610  
 000019802  
 0000021361  
 000009824  
 000024837  
 000022867  
 000022868  
 000020604



EXHIBIT "A"

GEOCODE	PROPERTY LOCATION	PROPERTY OWNER	APPEL GATE RID MAINTENANCE ASSESSMENTS 2002
199424404400000	366 BEST PLACE	HOOVESTAL GARY H & YUVONNE	
199424404450000	352 BEST PLACE	SNYDER CHANDRA	
199424404500000	348 BEST PLACE	SPARKS RICHARD A & DORIS R	
199424404550000	344 BEST PLACE	GILBERT BLAINE D & CYNTHIA S	
199424405010000	340 BEST PLACE	SALOIS ELIZABETH R	
199424405050000	336 BEST PLACE	ELSEN PETER PAUL A & CHRISTY M	
199424405100000	332 BEST PLACE	HOOVESTAL GARY H & YUVONNE	
199424405200000	328 BEST PLACE	HOOVESTAL GARY H & YUVONNE	
199424405250000	324 BEST PLACE	HOOVESTAL GARY H & YUVONNE	
199424405300000	320 BEST PLACE	DOMME GEORGE L	
199424405300000	316 BEST PLACE	LEWIS RICHARD H & TAMARA R	
199424405400000	312 BEST PLACE	ALHEIM DERDRE L & LAWRENCE P JR	
199424405450000	308 BEST PLACE	FOX KENNETH G & SHERILYN L	
199424405500000	304 BEST PLACE	HEDGE WILLIAM G & GRETCHEN	
199424405500000	300 BEST PLACE	TRAUTMAN ALBERT C & DENISE D	
199424406010000	0 BEST PLACE	HOOVESTAL GARY H & YUVONNE	
199424406050000	381 BEST PLACE	HOOVESTAL GARY H & YUVONNE	
199424406100000	377 BEST PLACE	HOOVESTAL GARY H & YUVONNE	
199424406150000	373 BEST PLACE	HOOVESTAL GARY H & YUVONNE	
199424406200000	0 BEST PLACE	HOOVESTAL GARY H & YUVONNE	
199424406250000	361 BEST PLACE	BRODOWY TED A	
199424406300000	357 BEST PLACE	WILLIAMS ANTHONY C & BRENDA S	
199424406350000	353 BEST PLACE	RHODES MARK W & KRISTIE K	
199424406400000	325 BEST PLACE	HARTMAN JOSEPH A & CARLA M	
199424406450000	321 BEST PLACE	HOOVESTAL GARY H & YUVONNE	
199424406500000	317 BEST PLACE	HOOPER DEREK & TIFFANY A (JT)	
199424406550000	309 BEST PLACE	MCCLAIN CHARLES HENRY	
199424406600000	305 BEST PLACE	HOOVESTAL GARY H & YUVONNE	
199424406650000	001 BEST PLACE	JONES ALAN & TAYLOR MARSHA	
199424407010000	0 BEST PLACE	HOOVESTAL GARY H & YUVONNE	
199424407030000	7128 SAGEBRUSH DR	DEMERS GARY & MELISSA	
199424407050000	7125 SAGEBRUSH DR	TRUSCOTT W J & CAROL	
199424407070000	7145 SAGEBRUSH DR	BLANKENSHIP DAVID...	
199424407950000	0 UNKNOWN	TRUSCOTT W J & CAROL	
199425101150000	7130 SAGEBRUSH	TRUSCOTT W J & CAROL	
199425101200000	241 JOHN G MINE	MYERS RICHARD D	
199425101250000	275 JOHN G MINE	MCCARTHY JOHN J & NORA	
199425101300000	235 JOHN G MINE	HUNTER LAWRENCE & BONNIE (J/TROS)	
199425101400000	0 JOHN G MINE	STALLINGS LINDA	
199425101450000	7085 GREEN MEADOW	STALLINGS LINDA	
199425102010000	215 JOHN G MINE	MONDAY JOHN P & HEATHER M	
199425102050000	6960 APPEL GATE	PEARCE LARAE & BENJAMIN	
199425102100000	0 UNKNOWN	HAUB FAMILY TRUST	
199425102120000	6990 APPEL GATE	MCCWEN MICHAEL L & MICHELLE F	
199425102140000	341 YELLOW SPRINGS	WARDELL BILL W & ROBIN R	
199425102160000	7040 APPEL GATE	WHITMAN WAYNE L TRUST	
199425102200000	7060 APPEL GATE	KATTEEN FRANK W	
199425102250000	7070 APPEL GATE	JUNEAU ROCHE VINCENT & TERILI	
199425102300000	285 JOHN G MINE	DOTTER WILLIAM A & SUSAN A	
199425102300000	375 JOHN G MINE	WARDELL EUNICE W	
199425102320000	7053 KANSAS	WARDELL BILL W & ROBIN R	
199425102330000	7061 KANSAS	SMITH BETHANY ANN	
199425102350000	377 JOHN G MINE	SWINGLEY KENNETH R & DEBORAH J	
199425102400000	280 YELLOW SPRINGS	WARDELL JOHN C & BARBARA LYNN	
199425102420000	7075 KANSAS	HOSSFELD MICHAEL J	
199425102430000	330 YELLOW SPRINGS	SILVAN DARRELL & DARLA	
199425102430000	7090 APPEL GATE	GARDING DAVID C & MARYBETH	

LEGAL 1	LEGAL 1
APPEL GATE VILLAGE SUBD LT 27 COS #575178	APPEL GATE VILLAGE SUBD LT 27 COS #575178
APPEL GATE VILLAGE SUBD LT 26 COS #575178	APPEL GATE VILLAGE SUBD LT 26 COS #575178
APPEL GATE VILLAGE SUBD LT 25 COS #575178	APPEL GATE VILLAGE SUBD LT 25 COS #575178
APPEL GATE VILLAGE SUBD LT 24 COS #575178	APPEL GATE VILLAGE SUBD LT 24 COS #575178
APPEL GATE VILLAGE SUBD LT 11 COS 575178	APPEL GATE VILLAGE SUBD LT 11 COS 575178
APPEL GATE VILLAGE SUBD LT 10 COS #575178	APPEL GATE VILLAGE SUBD LT 10 COS #575178
APPEL GATE VILLAGE SUBD LT 9 COS #575178	APPEL GATE VILLAGE SUBD LT 9 COS #575178
APPEL GATE VILLAGE SUBD LT 8 COS #575178	APPEL GATE VILLAGE SUBD LT 8 COS #575178
APPEL GATE VILLAGE SUBD LT 7 COS #575178	APPEL GATE VILLAGE SUBD LT 7 COS #575178
APPEL GATE VILLAGE SUBD LT 6 COS #575178	APPEL GATE VILLAGE SUBD LT 6 COS #575178
APPEL GATE VILLAGE SUBD LT 5 COS #575178	APPEL GATE VILLAGE SUBD LT 5 COS #575178
APPEL GATE VILLAGE SUBD LT 4	APPEL GATE VILLAGE SUBD LT 4
APPEL GATE VILLAGE SUBD LT 3 COS #575178	APPEL GATE VILLAGE SUBD LT 3 COS #575178
APPEL GATE VILLAGE SUBD LT 2 COS #575178	APPEL GATE VILLAGE SUBD LT 2 COS #575178
APPEL GATE VILLAGE SUBD LT 1 COS #575178	APPEL GATE VILLAGE SUBD LT 1 COS #575178
COS #575178	COS #575178
APPEL GATE VILLAGE SUBD LT 18 COS #575178	APPEL GATE VILLAGE SUBD LT 18 COS #575178
APPEL GATE VILLAGE SUBD LT 19 COS #575178	APPEL GATE VILLAGE SUBD LT 19 COS #575178
APPEL GATE VILLAGE SUBD LT 20 COS #575178	APPEL GATE VILLAGE SUBD LT 20 COS #575178
APPEL GATE VILLAGE SUBD PARKLAND	APPEL GATE VILLAGE SUBD PARKLAND
APPEL GATE VILLAGE SUBD LT 21 COS #575178	APPEL GATE VILLAGE SUBD LT 21 COS #575178
APPEL GATE VILLAGE SUBD LT 22 COS #575178	APPEL GATE VILLAGE SUBD LT 22 COS #575178
APPEL GATE VILLAGE SUBD LT 23 COS #575178	APPEL GATE VILLAGE SUBD LT 23 COS #575178
APPEL GATE VILLAGE SUBD LT 12 COS #575178	APPEL GATE VILLAGE SUBD LT 12 COS #575178
APPEL GATE VILLAGE SUBD LT 13 COS #575178	APPEL GATE VILLAGE SUBD LT 13 COS #575178
APPEL GATE VILLAGE SUBD LT 14 COS #575178	APPEL GATE VILLAGE SUBD LT 14 COS #575178
APPEL GATE VILLAGE SUBD LT 15 COS #575178	APPEL GATE VILLAGE SUBD LT 15 COS #575178
APPEL GATE VILLAGE SUBD LT 16 COS #575178	APPEL GATE VILLAGE SUBD LT 16 COS #575178
APPEL GATE VILLAGE SUBD LT 17 COS #575178	APPEL GATE VILLAGE SUBD LT 17 COS #575178
APPEL GATE VILLAGE SUBD COMMON AREA	APPEL GATE VILLAGE SUBD COMMON AREA
ROSEMARY ACRES MINOR SUBD LT E	ROSEMARY ACRES MINOR SUBD LT E
ROSEMARY ACRES MINOR SUBD LT D	ROSEMARY ACRES MINOR SUBD LT D
ROSEMARY ACRES MINOR SUBD LT C	ROSEMARY ACRES MINOR SUBD LT C
ROSEMARY ACRES MINOR SUBD LT A	ROSEMARY ACRES MINOR SUBD LT A
ROSEMARY ACRES MINOR SUBD LT B	ROSEMARY ACRES MINOR SUBD LT B
COWAN SUB LT 5 COS #288395	COWAN SUB LT 5 COS #288395
COWAN SUB LT 3 C/S 288395	COWAN SUB LT 3 C/S 288395
COWAN ADD LT 2	COWAN ADD LT 2
COWAN SUBD LT 4	COWAN SUBD LT 4
TRS IN E2ENW	TRS IN E2ENW
COWAN SUB LT 1 CS 288395	COWAN SUB LT 1 CS 288395
A TRACT IN THE SCNE4	A TRACT IN THE SCNE4
IN SW4NE4 TRACT 2 COS #568464/B	IN SW4NE4 TRACT 2 COS #568464/B
M&B IN NE4 COS 306901	M&B IN NE4 COS 306901
TR IN SENENE COS 335739	TR IN SENENE COS 335739
TR IN SENENE C/S 335739	TR IN SENENE C/S 335739
TRA NE4NE4 & NW4NE4	TRA NE4NE4 & NW4NE4
TR IN NE4NE4	TR IN NE4NE4
TR R - 3.74 AC TR D - 1	TR R - 3.74 AC TR D - 1
WARDELL MINOR SUB-TR B1 PER	WARDELL MINOR SUB-TR B1 PER
WARDELL MINOR SUB-TR B2 C/S #510655/E	WARDELL MINOR SUB-TR B2 C/S #510655/E
TRACT A PER COS #427131	TRACT A PER COS #427131
TR IN NENE	TR IN NENE
LT 1 IN NE4NE4 COS #462669/B	LT 1 IN NE4NE4 COS #462669/B
TR IN NENE AKA LT 2 COS 462669/B	TR IN NENE AKA LT 2 COS 462669/B
TR NENE	TR NENE

OLD PIN NUMBER	MAINTENANCE ASSESSMENT
000029401	\$15.00
000029402	\$15.00
000029403	\$15.00
000029404	\$15.00
000029405	\$15.00
000029406	\$15.00
000029407	\$15.00
000029408	\$15.00
000029409	\$15.00
000029410	\$15.00
000029411	\$15.00
000029412	\$15.00
000029413	\$15.00
000029414	\$15.00
000029415	\$15.00
000029416	\$15.00
000029417	\$15.00
000029418	\$15.00
000029419	\$15.00
000029420	\$15.00
000029421	\$15.00
000029422	\$15.00
000029423	\$15.00
000029424	\$15.00
000029425	\$15.00
000029426	\$15.00
000029427	\$15.00
000029428	\$15.00
000029429	\$15.00
000029430	\$15.00
000029431	\$15.00
000029432	\$15.00
000029433	\$15.00
000029434	\$15.00
000029435	\$15.00
000029436	\$15.00
000029437	\$15.00
000029438	\$15.00
000029439	\$15.00
000029440	\$15.00
000029441	\$15.00
000029442	\$15.00
000029443	\$15.00
000029444	\$15.00
000029445	\$15.00
000029446	\$15.00
000029447	\$15.00
000029448	\$15.00
000029449	\$15.00
000029450	\$15.00
000029451	\$15.00
000029452	\$15.00
000029453	\$15.00
000029454	\$15.00
000029455	\$15.00
000029456	\$15.00
000029457	\$15.00
000029458	\$15.00
000029459	\$15.00
000029460	\$15.00
000029461	\$15.00
000029462	\$15.00
000029463	\$15.00
000029464	\$15.00
000029465	\$15.00
000029466	\$15.00
000029467	\$15.00
000029468	\$15.00
000029469	\$15.00
000029470	\$15.00
000029471	\$15.00
000029472	\$15.00
000029473	\$15.00
000029474	\$15.00
000029475	\$15.00
000029476	\$15.00
000029477	\$15.00
000029478	\$15.00
000029479	\$15.00
000029480	\$15.00
000029481	\$15.00
000029482	\$15.00
000029483	\$15.00
000029484	\$15.00
000029485	\$15.00
000029486	\$15.00
000029487	\$15.00
000029488	\$15.00
000029489	\$15.00
000029490	\$15.00
000029491	\$15.00
000029492	\$15.00
000029493	\$15.00
000029494	\$15.00
000029495	\$15.00
000029496	\$15.00
000029497	\$15.00
000029498	\$15.00
000029499	\$15.00
000029500	\$15.00

3023610  
 Page: 4 of 8  
 08/08/2002 11:32a  
 BK-126 Pg-8594  
 Lewis & Clark County

EXHIBIT "A" GEOCODE	PROPERTY LOCATION	PROPERTY OWNER	LEGAL1	OLD PIN NUMBER	MAINTENANCE ASSESSMENT	
199425102450000	7092 APPLGATE DR	SCHMIDT CHERYL M	TR NENENE	000020995	\$15.00	
199425102470000	7094 APPLGATE DR	PRUETT JOHN P	TR IN NENENE COS #313103	000020960	\$15.00	
199425102500000	7096 APPLGATE DR	SMITH KENT A & JACQUELINE L	JOHN MINE RD N+ APPLGATE DR	000020734	\$15.00	
199425102520000	6916 APPLGATE DR	ROMANISKO DORIS	SWSENE	000010518	\$15.00	
199425102530000	7052 KANSAS WAY	WARDELL BILL W & ROBIN R	WARDELL MINOR SUB #2 LT F-1	000028038	\$15.00	
199425102550000	7053 KANSAS WAY	STONER JERE J & HOLMES TRACY M	WARDELL MINOR SUB #2 LT F-2 C/S 527902/E	000023611	\$15.00	
199425102600000	6920 APPLGATE DR	I C LTD	TR A IN S2SE4SE4NE4 COS #394228	000024611	\$15.00	
199425102800000	6920 APPLGATE DR	NETTLETON ALFRED & VICKIE	TR IN N2SESENE C/S 394228	000010085	\$15.00	
199425204100000	65 FOXBORRO LN	RIES DANIEL J	HAUB TRACT 1 MINOR SUBD, LT 1D, -	COS #3011861, IN N2	000030654	\$15.00
199425402010000	210 NORRIS RD	BARRY MARK C & BETH	TR IN SWSWSE	000009271	\$15.00	
199425402050000	250 NORRIS RD	BLATTER MARK L & JACQUELINE L	TR IN SE4SE4 AKA TR 1	000039875	\$15.00	
199425402100000	0 UNKNOWN RD	ARCHIBALD GEORGE W & CHARLOTTE A	M&B TRS IN SE4SE4 A/K/A LTS 2 & 3	000009248	\$15.00	
199425402120000	390 NORRIS RD	SAMPSON STEVEN DOUGLAS & JACQUELINE JEA	TR IN SESESE C/S 393086	000024533	\$15.00	
199425402150000	6750 APPLGATE DR	HOOPER GARY W	PT TR 1 + 1/4 INT IN RD IN SESE	000009720	\$15.00	
199425402170000	6752 APPLGATE DR	HOFFMAN RORY THOMAS & DEANNA L	PT TR 1+INT IN RD	000010148	\$15.00	
199425402210000	295 ESTATE RD	ARCHIBALD GEORGE W & CHARLOTTE A	W2 TR2+INT IN RD	000010024	\$15.00	
199425402250000	275 ESTATE RD	WAGNER ALVIN E & JUDITH B	TR 3+UNDIVIDED INT INRD	000010457	\$15.00	
199425402300000	245 ESTATE RD	HROUDA WILLIAM J & DAWN I	TR IN SWSE	000010346	\$15.00	
199425402350000	246 ESTATE RD	SHACKELFORD DAVID L & CAROL M	TR T + UNDIVIDED INT EREST IN	ROAD	000009663	\$15.00
199425402400000	270 ESTATE RD	BALDWIN VIRGINIA T & RICHARD D TRUST	TR 4 & W2 TR 5	000009244	\$15.00	
199425402450000	0 UNKNOWN	CHAMBERS C ALLEN & KATHY M	TR IN N2SESE PT OF TR 5 PER COS #328732	& ALL TRACT 6	000021541	\$15.00
199425402600000	6830 APPLGATE DR	MCGOWAN JAMES R & PEGGY A	TR IN S2NESE	000010057	\$15.00	
199425402650000	6840 APPLGATE DR	GLUECKERT MICHAEL T	TR IN S2NWSE	000009467	\$15.00	
199425402700000	6860 APPLGATE DR	KINSEY CHESTER L & SYLVIA	HAUB & GENTRY LANDS TRA G & B	PT N2N2SE4 PT S2SW4NE4	000009794	\$15.00
199436103010000	6098 GREENFIELD LP	CLONINGER DONALD & MICHELLE	GREENFIELD TRACTS SUBDIVISION LT 4	COS 607185/S	000035905	\$15.00
199436103050000	6090 GREENFIELD LP	SHOQUIST RICHARD A & CHRISTY R	GREENFIELD TRACTS SUBDIVISION LT 5	COS 607185/S	000035906	\$15.00
199436103100000	6080 GREENFIELD LP	SATHER MARK F & KATIE A	GREENFIELD TRACTS SUBDIVISION LT 12	COS 607185/S	000035913	\$15.00
199436103150000	6070 GREENFIELD LP	JENSEN MAX M	GREENFIELD TRACTS SUBDIVISION LT 13	COS 607185/S	000035914	\$15.00
199436103200000	6060 GREENFIELD LP	CURRAN ROBERT STEVEN	GREENFIELD TRACTS SUBDIVISION LT 19	COS 607185/S	000035920	\$15.00
199436103250000	6050 GREENFIELD LP	STIRNER GEORGE A JR & KATHY	GREENFIELD TRACTS SUBDIVISION LT 18	COS 607185/S	000035919	\$15.00
199436103300000	6040 GREENFIELD LP	STIRNER GEORGE A JR & KATHY	GREENFIELD TRACTS SUBDIVISION LTS 17-18	COS #607185/S	000035918	\$15.00
199436103350000	6030 GREENFIELD LP	SAMPSON MICHAEL W & KATHLEEN W	GREENFIELD TRACTS SUBDIVISION LT 16	COS 607185/S	000035917	\$15.00
199436103400000	6020 GREENFIELD LP	DRAKE DENNIS C	GREENFIELD TRACTS SUBDIVISION LT 9	COS 607185/S	000035910	\$15.00
199436103450000	6010 GREENFIELD LP	EAST GERALD A & SHERRY L	GREENFIELD TRACTS SUBDIVISION LT 8	COS 607185/S	000035909	\$15.00
199436103500000	6000 GREENFIELD LP	MESSINA F STEPHEN & SHANNON (JT/ROS)	GREENFIELD TRACTS SUBDIVISION LT 1,	COS #607185/S	000036018	\$15.00
199436104010000	6099 GREENFIELD LP	BATEY WILLIAM M & MAUREEN	GREENFIELD TRACTS SUBDIVISION LT 3	COS 607185/S	000035904	\$15.00
199436104050000	6095 GREENFIELD LP	WALKER MARK T & SHANNON R	GREENFIELD TRACTS SUBDIVISION LT 6	COS 607185/S	000035907	\$15.00
199436104100000	6085 GREENFIELD LP	MCLAUGHLIN DENNIS G & CHARMAINE M	GREENFIELD TRACTS SUBDIVISION LT 11	COS 607185/S	000035912	\$15.00
199436104150000	0 GREENFIELD LP	MCMAHON TIM B & LISA M	GREENFIELD TRACTS SUBDIVISION LT 14	COS 607185/S	000035915	\$15.00
199436104200000	6035 GREENFIELD LOOP	BLANFORD JEFFERY E & LISA I	GREENFIELD TRACTS SUBDIVISION LT 15	COS 607185/S	000035916	\$15.00
199436104250000	6025 GREENFIELD LP	BARTSCH KEVIN J & ANNE	GREENFIELD TRACTS SUBDIVISION LT 10	COS 607185/S	000035911	\$15.00
199436104300000	6015 GREENFIELD LP	MCCULLEY SAMUEL H	GREENFIELD TRACTS SUBDIVISION LT 7	COS 607185/S	000035908	\$15.00
199436104350000	6001 GREENFIELD LP	CASPERSON ERNEST H & BARBARA A	GREENFIELD TRACTS SUBDIVISION LT 2	COS 607185/S	000035903	\$15.00
19951910122AG00	7390 NMONTANA AVE	GUETTLER LORENE F	N2 LESS TRS	000009630	\$15.00	
199519201170000	405 GRIFFIN RD	NEW HOPE MINISTRIES UPC OF HELENA	TR D PER CO/S #452402	TR A IN GOVT LTS 1-2 PER COS 3890	000024358	\$15.00
199519201190000	7425 APPLGATE DR	BICKLER THOMAS I & LINDA J (JR/ROS)	TR D PER C/S #452402/M	000024358	\$15.00	
199519201200000	0 UNKNOWN	JOHNSON CLARENCE & VIRGINIA H	TR 1B COS #400227 IN NW4SW4NW4	000024357	\$15.00	
199519201210000	450 GRIFFIN RD	COTTRILL ERIC J & BRANDI J	TR 2B C/S 400227 IN SWNWNW	000025009	\$15.00	
199519201220000	470 GRIFFIN RD	GATES MARNEE L	TR IN SWNWNW AKA 3B PER C/S 400227	MARLETTE 28X48 1995 TITLE #H0118	000025010	\$15.00
199519201230000	490 GRIFFIN RD	SNYDER JASON L & SANDRA L	U & B MINOR SUBD LOT 1C COS #579133	FLEETWOOD 26X66 1998	000029924	\$15.00
199519201250000	475 GRIFFIN RD	VONADA ROBERT J SR & PATRICIA L	U & B MINOR SUBD LOT 3C COS #579133	000023839	\$15.00	
199519201270000	495 GRIFFIN RD	LAWRENCE JEAN M & LINDA L	U & B MINOR SUBD LT 2C COS 579133	000029925	\$15.00	
199519201290000	455 GRIFFIN RD	DUARTE GARY S	TRACT 4B NWSWNW COS #400227	000035757	\$15.00	
199519201600000	405 LINCOLN RD WEST	LAIB MYRON & TAMARA	2 AC TR IN NWNWNW C/S 431672/0	000025511	\$15.00	
199519301010000	412 JOHN G MINE RD	LARSON EDWARD L & LEA ANN	TR IN SWSWSW	000010277	\$15.00	
199519301020000	540 JOHN G MINE RD	KANTA DAVID J & KAREN M	PT E2SW4SW4 TRACT B C/S #516707/F	FLEETWOOD 26X67 1994	000027805	\$15.00
199519301030000	540 JOHN G MINE RD	DUKE DACRE A & IRENE K	PT E2SW4SW4 TRACT A	COS 516707/F	000009505	\$15.00

**3023610**

Page: 5 of 8  
08/08/2002 11:32A  
Bk-M28 Pg-8594



Lewis & Clark County

COUNTY

EXHIBIT "A"

GEOCODE	PROPERTY LOCATION	PROPERTY OWNER	LEGAL1	OLD PIN NUMBER	MAINTENANCE ASSESSMENT
1995193010500000	650 JOHN G MINE	EHLERT DARRELL R & ALLEGRA A	TR IN SWSESW	000019467	\$15.00
1995193011100000	0 UNKNOWN	DEAN SAMUEL G & ANNA S	N2SESW, SESESW LESS NESESW	000010181	\$15.00
199519301115B11	0 UNKNOWN	EHLERT DARRELL R & ALLEGRA A	TR IN NWSESW	000024925	\$15.00
1995193011300000	7285 APPELEGATE	KOVICH GREGORY J & CATHY J	9.36 AC TRACT IN NW4 SW4 S W2NE5W	000010278	\$15.00
1995193011700000	7215 APPELEGATE	HENWOOD WILLIAM R & CAROL J		000009678	\$15.00
1995193011900000	7285 APPELEGATE	GROSSMAN PAULA JEAN		000009620	\$15.00
1995193020100000	7275 APPELEGATE	FEBREIRA RICHARD S & KAREN S	NESESW 10 AC	000029131	\$15.00
1995193020300000	7265 APPELEGATE	SKINNER BICK C & KATHY M	VALLEY ACRES NO 2 MINOR LT 1	000029132	\$15.00
1995193020500000	7255 APPELEGATE	MUELLER CHARLES R & BONNIE A	VALLEY ACRES NO 2 MINOR LT 2	000029133	\$15.00
1995193020700000	7245 APPELEGATE	WINCHESTER WARREN R & SUSAN A	VALLEY ACRES NO 2 MINOR LT 3	000029134	\$15.00
1995193021000000	7210 OXFORD DR	STANFILL R JASON & R	VALLEY ACRES NO 2 MINOR LT 4	000029135	\$15.00
1995193021200000	7220 OXFORD DR	SMITH LARRY KIM,...	SMITH MAJOR SUB LT 1	000039627	\$15.00
1995193021400000	7232 OXFORD DR	MUFFICK GARRIE A,...	SMITH MAJOR SUB LT 2	000039625	\$15.00
1995193021600000	7246 OXFORD DR	JAMES JOEL M & ELIZA	SMITH MAJOR SUB LT 3	000039626	\$15.00
1995193021800000	7260 OXFORD DR	WALLACE WESLEY D & M	SMITH MAJOR SUB LT 4	000039627	\$15.00
1995193022000000	7272 OXFORD DR	KNIGHTON JASON T & L	SMITH MAJOR SUB LT 5	000039628	\$15.00
1995193022200000	7283 OXFORD DR	SMITH LARRY KIM,...	SMITH MAJOR SUB LT 6	000039629	\$15.00
1995193022400000	7263 OXFORD DR	SMITH LARRY KIM,...	SMITH MAJOR SUB LT 7	000039643	\$15.00
1995193022600000	7251 OXFORD DR	POWER-TOWNSEND COMPA	SMITH MAJOR SUB LT 21	000039642	\$15.00
1995193022800000	7236 OXFORD DR	SMITH LARRY KIM,...	SMITH MAJOR SUB LT 20	000039641	\$15.00
1995193023000000	460 CYPRESS RD	BEAGLES MARIE E & JA	SMITH MAJOR SUB LT 17	000039639	\$15.00
1995193023200000	490 CYPRESS RD	ANDERSON CHAD M & CA	SMITH MAJOR SUB LT 16	000039638	\$15.00
1995193023400000	510 CYPRESS RD	SMITH LARRY KIM,...	SMITH MAJOR SUB LT 15	000039637	\$15.00
1995193023600000	7230 IVORY DR	STEVENS D KURT & VAL	SMITH MAJOR SUB LT 14	000039637	\$15.00
1995193023800000	7282 IVORY DR	MCKINNEY RAYMOND M J	SMITH MAJOR SUB LT 18	000039636	\$15.00
1995193024000000	7289 IVORY DR	IC LTD,...	SMITH MAJOR SUB LT 19	000039640	\$15.00
1995193024200000	7265 IVORY DR	IC LTD,...	SMITH MAJOR SUB LT 8	000039641	\$15.00
1995193024400000	7257 IVORY DR	IC LTD,...	SMITH MAJOR SUB LT 10	000039630	\$15.00
1995193024600000	7245 IVORY DR	HELENA BUILDING INDU	SMITH MAJOR SUB LT 11	000039633	\$15.00
1995193025000000	7217 IVORY DR	SMITH LARRY KIM,...	SMITH MAJOR SUB LT 12	000039634	\$15.00
1995194010100000	710 JOHN G MINE	DEAN SAM G & ANNA S	SMITH MAJOR SUB LT 13	000039635	\$15.00
1995194010300000	0 UNKNOWN	ADAMS HAROLD E TRUSTEE	W2SWSE	000009469	\$15.00
1995194010500000	1090 JOHN G MINE	ADAMS HAROLD G	M&B TR, IN S2SE, COS #288973 LESS	000009215	\$15.00
199519401070001	7140 NMCNTANA AVE	ADAMS H & ASSOCIATES	TR IN SESE C/S 432206/F	000025535	\$15.00
1995194011500000	0 UNKNOWN	DEAN SAMUEL G & ANNA S	TRACT IN SE4 SE4 8.487 AC	000009216	\$15.00
19951940119A G00	720 JOHN G MINE	PETERSON JOHN O & CARMIA J	N2NWSE, SENE5W C/S 440546/E	000025650	\$15.00
1995301013300000	7090 NMCNTANA AVE	NICHOSS ANDREA L & WHITE GARY A	10 AC TRACT IN SW4 NW4 S	000010179	\$15.00
1995302011000000	6995 APPELEGATE	SANDROCK BRYAN J & JERI L	N2NE N 16 RODS 8' OF S2NE LESS TRS	000011284	\$15.00
1995302011500000	7035 APPELEGATE	PETERSON RAYMOND P & KAREN	TR IN EN2NE	000011641	\$15.00
1995302011800000	695 JOHN G MINE	ROCK DAVID D & NOLA	TR IN SW NW 10.56 A	000011484	\$15.00
1995302014000000	695 JOHN G MINE	STRATTON BRITTON E & KELI	TR IN NEW 10 AC	000028186	\$15.00
1995302015000000	0 UNKNOWN	R V RANCH	NW LESS TRS	000019544	\$15.00
1995302200100000	420 TUBBLE	ALLISON GEORGE W II & COLLEEN M	TRS B1 C1 D1 PER COS #603141/B	000027547	\$15.00
1995302200200000	450 TUBBLE	TERRAULT GEORGE R & IRENE E	NORTH VALLEY DOWNS PHASE 1 LT 1	000025695	\$15.00
1995302200300000	470 TUBBLE	WANDRYCH THOMAS E & SUSAN M	NORTH VALLEY DOWNS PHASE 1 LT 2	000026229	\$15.00
1995302200400000	500 TUBBLE	NETTLETON BRIAN F & MISTI M	NORTH VALLEY DOWNS #1 LT 3 COS 427796/E	000026230	\$15.00
1995302200500000	530 TUBBLE	RENNIE PATRICK J	NORTH VALLEY DOWNS PHASE 1 LT 4	000026231	\$15.00
1995302200600000	560 TUBBLE	SAUNDER LEONARD O & CATHY A	NORTH VALLEY DOWNS #1 LT 5	000026232	\$15.00
1995302200700000	580 TUBBLE	MCNUHLIN DANIEL & THERESA	NORTH VALLEY DOWNS #1 LT 6 C/S #427796/E	000026233	\$15.00
1995302200800000	600 TUBBLE	FLYNN JOHN J & CAROL LYNN	NORTH VALLEY DOWNS #1 LT 7	000026234	\$15.00
1995302200900000	7065 JOCKEY	CASMAN NORMAN & KATHY	NORTH VALLEY DOWNS #1 LT 8	000026235	\$15.00
1995302201000000	7055 JOCKEY	ELSHIRE RICHARD A III & KIELA M	NORTH VALLEY DOWNS PHASE 1 LT 9	000026228	\$15.00
1995302201100000	0 UNKNOWN	YDE CHRIS A & GINGERLEE	N VALLEY DOWNS PHS 1 LT 10 C/S #427796/E	000026226	\$15.00
1995302201200000	7025 JOCKEY	ANDERSON JAMES J & AMY R	LOT 11	000026237	\$15.00
			LOT 12	000026238	\$15.00

**3023610**  
 Page 6 of 6  
 08/08/2002 11:32A  
 BK - 126 Pg - 6594



**Lewis & Clark County**

EXHIBIT "A"	PROPERTY LOCATION	PROPERTY OWNER	LEGAL 1	OLD PIN NUMBER	MAINTENANCE ASSESSMENT
199530220130000	0 UNKNOWN	SHEPARD DIXIE LOU &	NORTH VALLEY DOWNS PHASE I LT 13	COS #427796/E	\$15.00
199530220140000	575 TUBBIE	YANKE RICHARD ARNOLD & DONNA L	LT 14	NASHUA 26X56 1993	\$15.00
199530220150000	545 TUBBIE	HOVLAND GORDON & LORRAINE	LT 15	NASHUA 26X56 1994 TITLE #W877017	\$15.00
199530220160000	525 TUBBIE	SWARTZ JOEL E & KIMBERLY J	NORTH VALLEY DOWNS PHASE 1 LT 16	CS 427796/E	\$15.00
199530220170000	495 TUBBIE	OLSEN DARYL KEVIN & LESLIE DOREEN	KIT 28X52 1995 TITLE #E137241	S/N KIDM1H8575W24SN1347A	\$15.00
199530220180000	0 UNKNOWN	JONES VERNON D & WILLIAMS KATH	LT 18		\$15.00
199530220190000	0 UNKNOWN	REEVES GREGORY A & AMY K	NORTH VALLEY DOWNS PHASE I LT 19		\$15.00
199530220200000	417 TUBBIE	STUBBS SHERRI R	NORTH VALLEY DOWNS #1 LT 20	CENTURY 16X66 1980 TITLE #W22116	\$15.00
19953030101AG00	6765 APPLGATE	WILSON W WAYNE	TR A IN SW4 COS #3009081 LESS MTG 1 AC	TR COS #547390/M	\$15.00
199530301030000	6765 APPLGATE	WILSON W WAYNE & MARLA J	PT TR A COS #3009061 MTG TR 1.00AC	COS #547390/M	\$15.00
199530301150000	6845 APPLGATE	APPLEGATE CLARENCE L & REGINA	TR A PER C/S #507600/E		\$15.00
199530301200000	6885 APPLGATE	KIRBY JEFFREY A & DEBRA D	TR B PER C/S #507600/E		\$15.00
199531201010000	0 UNKNOWN	BRANDON DAVID D & WLM L & LEGG BRIAN	TR B1A COS #3009061 IN NW4	000011520	\$15.00
199531201250000	6705 APPLGATE	BRANDON DAVID D	TR A1A COS #3009061 IN NW4	000027184	\$15.00
NOT ASSIGNED YET	705 MORRIS RD	BRANDON DAVID D	CRESTWOOD GREEN ESTATES, LOT 1	N/A	\$15.00
NOT ASSIGNED YET	700 MORRIS RD	BRANDON DAVID D	CRESTWOOD GREEN ESTATES, LOT 2	N/A	\$15.00
NOT ASSIGNED YET	6690 ROSEWOOD DR	BRANDON DAVID D	CRESTWOOD GREEN ESTATES, LOT 3	N/A	\$15.00
NOT ASSIGNED YET	6644 ROSEWOOD DR	BRANDON DAVID D	CRESTWOOD GREEN ESTATES, LOT 6	N/A	\$15.00
NOT ASSIGNED YET	740 CRESTWOOD LN	BRANDON DAVID D	CRESTWOOD GREEN ESTATES, LOT 7	N/A	\$15.00
NOT ASSIGNED YET	739 CRESTWOOD LN	BRANDON DAVID D	CRESTWOOD GREEN ESTATES, LOT 8	N/A	\$15.00
NOT ASSIGNED YET	757 CRESTWOOD LN	BRANDON DAVID D	CRESTWOOD GREEN ESTATES, LOT 9	N/A	\$15.00
NOT ASSIGNED YET	762 CRESTWOOD LN	BRANDON DAVID D	CRESTWOOD GREEN ESTATES, LOT 10	N/A	\$15.00
NOT ASSIGNED YET	6600 ROSEWOOD DR	BRANDON DAVID D	CRESTWOOD GREEN ESTATES, LOT 11	N/A	\$15.00

Excel\AppleMaint

3023610

Page: 7 of 8  
08/06/2002 11:32A



COUNTY

Lewis & Clark County

Bk-M26 Pg-8594

EXHIBIT "B"  
APPLEGATE RID MAINTENANCE  
DISTRICT BOUNDARIES

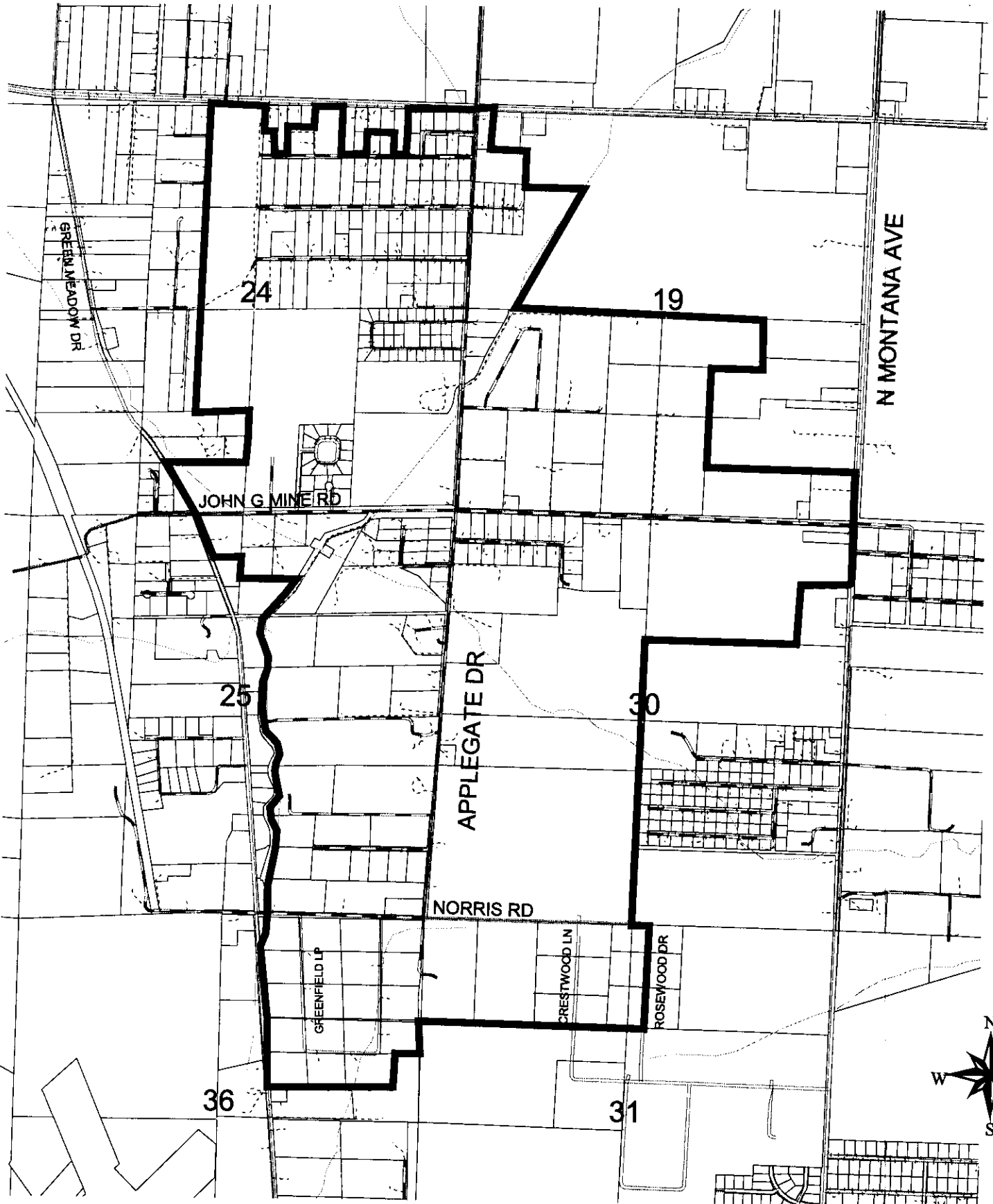

3023610

Page: 8 of 8  
06/06/2002 11:32A  
Bk-M26 Pg-8594



CLARK COUNTY  
Lewis & Clark County

