

RESOLUTION 2020 - 49

RESOLUTION TO CREATE THE LAKE HOME ROAD RURAL IMPROVEMENT DISTRICT NO. 2020-01

WHEREAS, a resolution of intention to create the Lake Home Road Rural Improvement District (the district) was adopted by the Lewis and Clark County Board of Commissioners (Commission) on June 18, 2020, as Resolution 2020-38; and

WHEREAS, legal notice of the passage of Resolution 2020-38 was mailed to property owners and persons with interest in property within the proposed district, and published in the local newspaper in accordance with Section 7-12-2105, MCA and 7-1-2121, MCA; and

WHEREAS, it was determined that there was not sufficient protest to bar proceedings as per Section 7-12-2112, MCA; and

WHEREAS, the designated items set forth in Section 7-12-212103(2), MCA, are as follows:

- (a) The designated number of the District is 2020-01.
- (b) The benefited properties to be included in the District are listed in Exhibit "A". The road proposed to be improved and maintained within the boundary of the District is shown in Exhibit "B".
- (c) The County Engineer or a designee is the engineer to have charge of the work. The general character of improvements includes an asphalt overlay, installation of valley gutters, and chip seal. The estimated costs for improvements are \$33,389.53, or \$4,219.73 per year for a period of ten (10) years. Each benefited property will be assessed \$301.41 annually. Improvement costs are detailed in Exhibit "C".
- (d) The general character of maintenance includes, but is not limited to chip sealing, crack sealing, snow plowing, sweeping, and other maintenance and repair as necessary to preserve the road surfaces. Each benefited property will be assessed \$47.81 annually. Maintenance costs are detailed in Exhibit "D".
- (e) Costs shall be assessed equally, as described in Section 7-12-2151(1)(d), MCA.
- (f) Pursuant to Section 7-12-2103(2)(f), MCA, if an increase in the number of benefited lots, tracts, or parcels within the boundaries of the district during the term of bonded indebtedness, the assessment per lot, tract, or parcel then in the district will be recalculated.

NOW, THEREFORE, BE IT RESOLVED by the Board of County Commissioners does hereby create the Lake Home Road Rural Improvement District No. 2020-01 for the purpose of equitably funding road improvements and maintenance.



BE IT FURTHER RESOLVED, the Lewis and Clark County Public Works Department is authorized and responsible for coordinating proposed improvements and maintenance detailed in Exhibits "C" and "D" for the roadway within the District.

DATED this 28 day of July, 2020.

LEWIS AND CLARK COUNTY
BOARD OF COMMISSIONERS

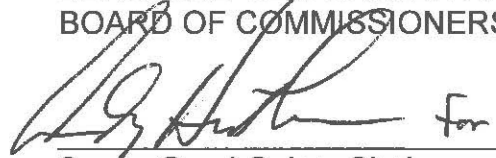

Susan Good Geise, Chair

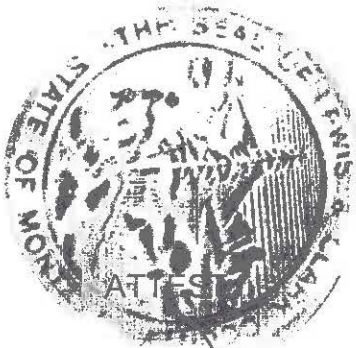



Paulette J. DeHart, Clerk of the Board

Attachments:

- Exhibit "A"
- Exhibit "B"
- Exhibit "C"
- Exhibit "D"

Assessment Code	Legal Description	Owner Name	Estimated Improvement Assessment	Estimated Maintenance Assessment
1 13716	S27, T11 N, R02 W, C.O.S. 3021976, MAKE NORTHWESTERN, MODEL UNKNOWN, ACRES 0.52, TRACT C-1A, IN SE4SE4 NORTHWEST 26X60 1996 TITLE # W976789	FRANKENFIELD VIRGINIA S LIVING TRUST	\$ 301.41	\$ 47.81
2 36258	S27, T11 N, R02 W, C.O.S. 3021976, PARCEL B-1A, IN SE4SE4	FRANKENFIELD VIRGINIA S LIVING TRUST	\$ 301.41	\$ 47.81
3 13712	S27, T11 N, R02 W, C.O.S. 619006/B, MAKE FLEETWOOD, MODEL STONERIDGE, ACRES 0.48, TRACT B-2, IN SE4SE4 FLEETWOOD, STONERIDGE 26X58 1992 TITLE #W592425, S/N 140	ALLEN KEITH M & MANDY J	\$ 301.41	\$ 47.81
4 13962	S27, T11 N, R02 W, TR IN SE4SE4 MARLETTE 24X57 1968	LEPPINK COLLEEN	\$ 301.41	\$ 47.81
5 14021	S27, T11 N, R02 W, TR IN SW4	ERVING JEREMY R & DEANNE G	\$ 301.41	\$ 47.81
6 13717	S27, T11 N, R02 W, C.O.S. 471249/B, PARCEL D, ACRES 0.684, IN SE4SE4	GIBSON TERRI LEE & TAMI LYNN	\$ 301.41	\$ 47.81
7 25653	HAUSER LAKEHOMES CONDO, S27, T11 N, R02 W, UNIT 1	SNOW GOOSE PROPERTY LLC	\$ 301.41	\$ 47.81
8 25654	HAUSER LAKEHOMES CONDO, S27, T11 N, R02 W, UNIT 2	LEEP LAND LLC	\$ 301.41	\$ 47.81
9 24209	HAUSER LAKEHOMES CONDO, S27, T11 N, R02 W, UNIT 3	RENCHER MARIANNE H	\$ 301.41	\$ 47.81
10 27377	HAUSER LAKEHOMES CONDO, S27, T11 N, R02 W, UNIT 4	TROST DANIEL R & CATHERINE M	\$ 301.41	\$ 47.81
11 24978	HAUSER LAKEHOMES CONDO, S27, T11 N, R02 W, UNIT 5	DEVRIES MIKE & TRYNITY	\$ 301.41	\$ 47.81
12 26984	HAUSER LAKEHOMES CONDO, S27, T11 N, R02 W, UNIT 6	SHANNON MELISSA E	\$ 301.41	\$ 47.81
13 26308	HAUSER LAKEHOMES CONDOMINIUM, S27, T11 N, R02 W, UNIT 7	MILLONS MARDI L	\$ 301.41	\$ 47.81
14 24979	HAUSER LAKEHOMES CONDO, S27, T11 N, R02 W, UNIT 8	SANDILAND ROGER R & PAMELA J	\$ 301.41	\$ 47.81

Lake Home Road RID Exhibit "B"



Legend

-  Lake Home Road
-  Benefiting Properties
-  Lake Home Road RID Boundary



Lake Home Road Improvements Exhibit "C"

Lake Home Road Public Works Estimate						L&C PUBLIC WORKS Calob Marquis Date: June 15, 2020					
Improvement											
Road Name	Limits	Width Feet	Length Feet	SY	2.5" Asphalt Overlay, Tons	Chip & Seal SY					
Lake Home Road	From York Rd to East End	20	550	1,222	174	1,222					
TOTALS		20	550	1,222	174	1,222	0	0	0	17	0

Asphalt Overlay	174	Tons	@	\$ 110.00	\$ 19,140.00
2020 Chip & Seal	1,222	SY	@	\$ 2.15	\$ 2,627.30
Valley Gutter Installation	2	Each	@	\$2,500.00	\$ 5,000.00
CONSTRUCTION TOTAL					\$ 26,767.30
Contingency 10%					\$ 2,676.73
Subtotal					\$ 29,444.03
Mobilization, Bonding & Insurance 4%					\$ 1,177.76
Traffic Control 4%					\$ 1,177.76
Subtotal					\$ 31,799.55
Design & Construction Engineering					\$ -
PROJECT TOTAL					\$ 31,799.55

Lake Home Road Public Works Estimate		Maintenance Estimate							L&C PUBLIC WORKS Calob Marquis		Date: March 30, 2020
	Limits	Width Feet	Length Feet	SY	Snow Plowing SY	Chip Seal, SY	Crack Seal, LF	Fog Seal SY	Miscellaneous - Signs, Weed Spraying, Drainage, Potholes, Tree Trimming, Mowing SY		
Lake Home Rd	From York Rd to E Terminus	20	550	1,222	1,222	1,222	15	1,222	1,222		
TOTALS			550	1,222	1,222	1,222	15	1,222	1,222		

NOTES:
Total Chipseal Cost is \$2627.30 Per Seven Years

			Times per Year		
Snow Plowing	1,222	SY	@ 3	\$ 0.03	\$ 109.88
Chip Seal	1,222	SY	@ 1*	\$ 2.15	\$ 375.33
Crack Seal	15	LF	@ 1	\$ 2.00	\$ 30.00
Misc.	1,222	SY	@ 1	\$ 0.10	\$ 122.20
CONSTRUCTION TOTAL					\$ 637.51
5% Administration Fee				5%	\$ 31.88
Project Total					\$ 669.39

Proposed Lake Home Road RID

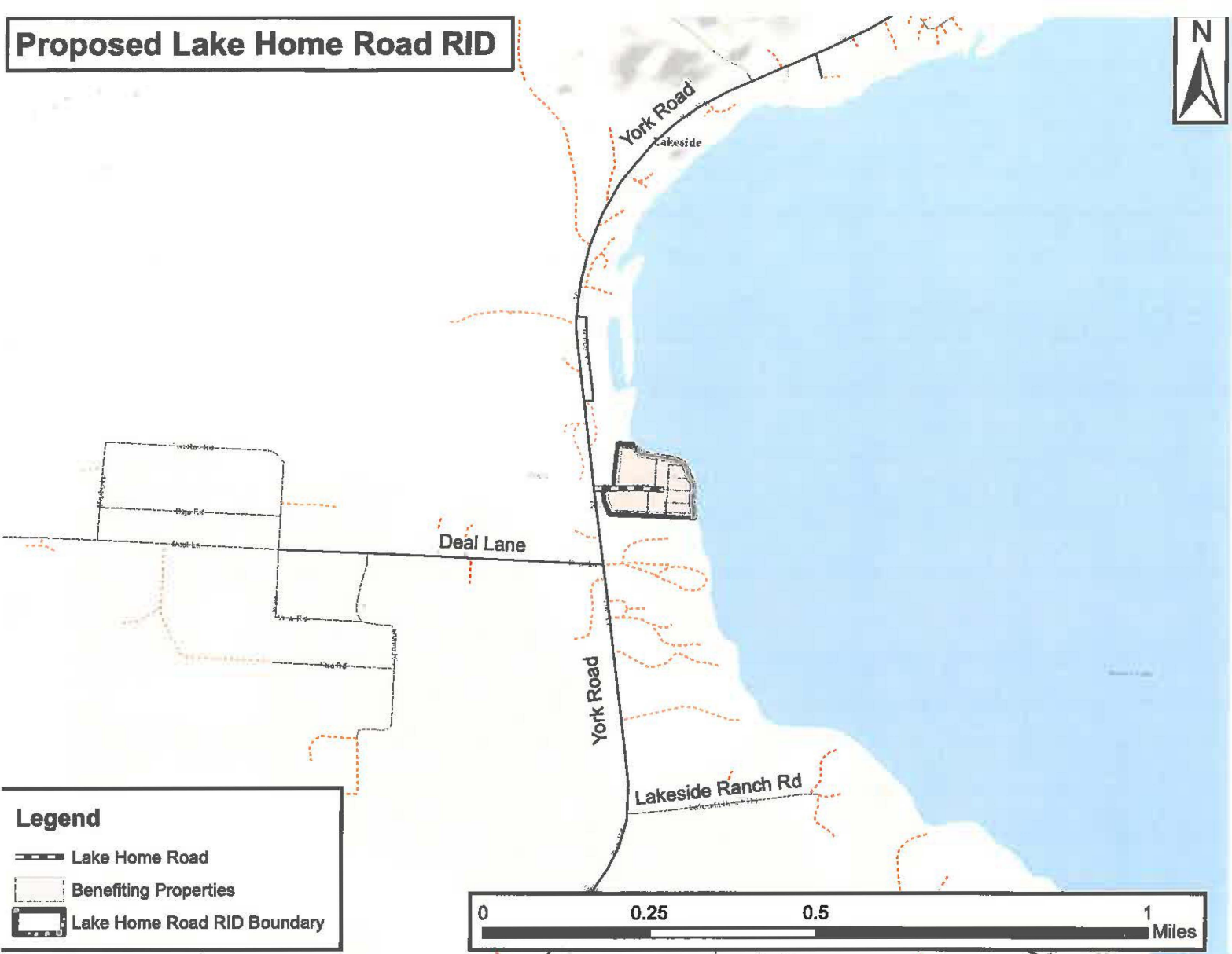

Legend

-  Lake Home Road
-  Benefiting Properties
-  Lake Home Road RID Boundary

