

RESOLUTION 2005-146

**A RESOLUTION OF INTENTION TO AMEND RURAL  
IMPROVEMENT DISTRICT 2004-1, NORTH HILLS**

WHEREAS, the North Hills RID 2004-1 was created in 2004 for the purpose of funding road maintenance for certain roads; and

WHEREAS, a request has been received to amend the scope of the district to include maintenance and snow plowing services east of Collins Drive for approximately one-half mile each of Fantasy Road, Tea Road and Snowdrift Road; and

WHEREAS, this would be in addition to the maintenance activities in the original creation of the district; and

WHEREAS, the costs for this service can be covered by the current assessments in the district, so no additional costs will be incurred; and

WHEREAS, the Board of County Commissioners has the authority to amend Rural Improvement Districts, pursuant to Section 7-12-2101, et. seq., MCA.

NOW, THEREFORE, BE IT RESOLVED by the Lewis and Clark County Board of County Commissioners that it does hereby establish its intention to amend the scope of the North Hills RID to include maintenance and snow plowing services east of Collins Drive for approximately one-half mile each of Fantasy Road, Tea Road and Snowdrift Road.

BE IT FURTHER RESOLVED that said the district will include those parcels of land shown on Exhibit "A" and listed on Exhibit "B".

BE IT FURTHER RESOLVED that the district shall be amended to include maintenance and snow plowing services east of Collins Drive for approximately one-half mile each of Fantasy Road, Tea Road and Snowdrift Road and that all current road maintenance activities shall continue.

BE IT FURTHER RESOLVED that the assessments shall remain the same as before (\$141.83 per lot). All funds collected for the district shall be spent solely for the maintenance activities within the district.

BE IT FURTHER RESOLVED that the maintenance district shall remain in effect in perpetuity or until such action by the Board of County Commissioners otherwise dissolves the district.

DATED this 8<sup>th</sup> day of December, 2005.

BOARD OF COUNTY COMMISSIONERS  
LEWIS AND CLARK COUNTY

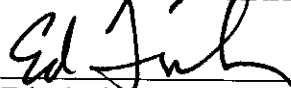
  
Ed Tinsley, Chairman

ATTEST:

  
Paulette J. DeHart, Clerk of Board

Attachments: Exhibit "A" and Exhibit "B"  
File: NhillsChangeIntentRes



Lewis & Clark County

COUNTY

3098906

Page: 1 of 4  
12/08/2005 02:35P

Bk-M33 Pg-7352

3098906

Page: 2 of 4  
12/08/2005 02:35P  
Bk-M33 Pg-7352



Lewis & Clark County

# EXHIBIT "A"

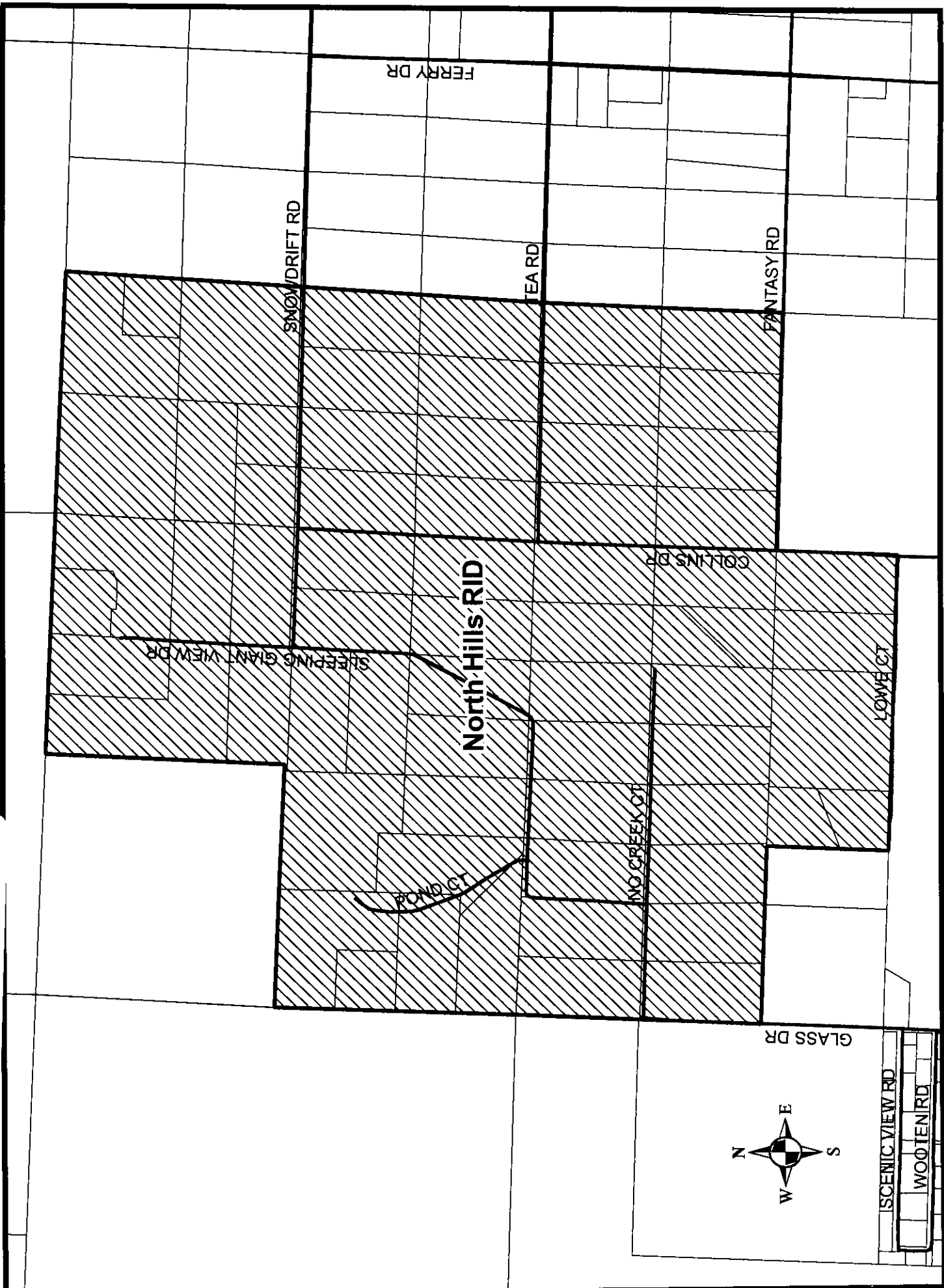



EXHIBIT "B"

NORTH HILLS RID

GEOCODE	LANDOWNER	LEGAL DESCRIPTION	ASSESSMENT
199503101050000	WOODS JOHN	SWSWNW COS #246009	\$141.83
199503101100000	DANIELSON DANIEL & ELIZABETH	NWSWNW; NESWNW COS 246009	\$141.83
199503101200000	DESERLY LANNIE J & KATHLEEN JO	SESWNW COS #246009	\$141.83
199503101220000	DANIELSEN DANIEL & ELISABETH (JT/ROS)	SE4NW4 (AKA LT 6, COS #242842)	\$141.83
199503101320000	TOPHAM KIM O	PT OF GOVT LT 3 9.75 AC	\$141.83
199503101340000	TOPHAM KIM O	TR 3 GOVT LT 3 LESS 9.75 AC	\$141.83
199503101360000	DANIELSEN DANIEL J & ELISABETH H	TRACT 4 COS #602010/T IN NW4NW4	\$141.83
199503301010000	STOLP STACIL & JUSTINE	LT 16 IN W2SWSW PER C/S #540025/T	\$141.83
199503301050000	EVANS JOYCE F	LT 15 IN E2SWSW PER C/S #540025/T	\$141.83
199503301070000	KING LINDA J	LT 14 IN W2SESW PER C/S #540025/T	\$141.83
199503301100000	UTICK DEVELOPMENT CO INC	LT 13 IN E2SESW PER C/S #540025/T	\$141.83
199503301130000	KARLAU DAVID J	LT 1 IN W2NWSW COS #540025/T	\$141.83
199503301170000	ST ONGE TED L & LUCY	LT 2 IN E2NWSW PER C/S #540025/T	\$141.83
199503301200000	SPEARLINE JOHN H & DOROTHEA L	LT 3 IN W2NESW PER C/S #540025/T	\$141.83
199503301230000	LYLE WILLIAM S & CYNTHIA M	LT 4 IN E2NESW COS #540025/T	\$141.83
199504101010000	FRANCIS MARSHA GAIL & CLARENCE	LT 64 PER C/S #502454/E	\$141.83
199504101050000	PETROSKY JEFFREY T & ANGELA D (JT/ROS)	LT 60 COS 502454/E	\$141.83
199504101100000	MCADAMS JENNIFER & GEORGE (JT/ROS)	NORTH HILLS SUB LT 59 COS 502454/E	\$141.83
199504101200000	MORRISON CINDY J	LT 61A & 62 IN E2NW4NE4 COS #543778/E	\$141.83
199504101250000	CYPERS ROBERT J & SCOTT DALLAS	TR 58-A1 COS #3046371 IN NE4	\$141.83
199504101300000	SMITH KEVIN B & TRAVIS LAURA L	TRACT 57-A1 IN NE4 COS #3046371	\$141.83
199504101350000	OYLER SCOTT E & LISA R	W2NW4NE4 LOT 62-A	\$141.83
199504301010000	BRIGHT DOUG J & CAROLYNN	NW4	\$141.83
199504301050000	TIMMERMAN WALTER W & KAREN K	LT 72A COS #502454/E	\$141.83
199504301100000	HAWKINS JOHN MICHAEL & MOLINA RENEE	LT 71 PER C/S #502454/E	\$141.83
199504301150000	LINDGREN KEVIN T & RICHEM CHRISTINE L	LT 73A COS 502454/E	\$141.83
199504301200000	YATES JACK O & HEIDI	LT 74 PER C/S #502454/T	\$141.83
199504301250000	JOHNSON TOBE M & BARBARA R	LT 69 PER C/S #502454/E	\$141.83
199504301300000	WITHERSKI JEROME	MORTGAGE TRACT COS #547610M ON LT 70 COS #502454/E	\$141.83
199504401010000	JOHNSON TOBE M & BARBARA R	TR A COS #622305-T IN SW4NW4	\$141.83
199504401050000	MASTRANGELO JAMES A & NADENE M	LT 75 PER C/S #502454/E	\$141.83
199504401100000	KLEIN ROBERT & NANCY	LT 76A COS 3062124	\$141.83
199504401150000	CARROLL HAZEL L	LT 77 PER C/S #502454/E	\$141.83
199504401200000	POREMBSKI KAREN A	LT 78 COS #502454/E	\$141.83
199504401250000	CHEATHAM KARYN FOLLIS	LT 65 COS #502454/E	\$141.83
199504401300000	LILLIBRIDGE JERRY & C JORDAN	LT 66 COS #502454/E	\$141.83
199504401350000	COCHRAN DOLORES	LT 68 PER C/S #502454/E	\$141.83
199504401500000	ELLIOTT NATASHA	NORTH HILLS SUB LT 67 COS 502454/E	\$141.83
199509101010000	ANDERS FAMILY LLC	LT 91 COS 502453/T	\$141.83

199509101050000	SILVA GILBERT L & MARGIE L	LT 92 COS 502453/T	\$141.83
199509101100000	AULTMAN TIM & CONNIE	LT 93-B PER C/S #575650/F IN W2SENE	\$141.83
199509101130000	HOCHSTRASSER JEFF	IN W2SENE LOT 93-A PER COS 575650/F	\$141.83
199509101150000	BIRMINGHAM WILLIAM H & LINDA L	LT 94 PER COS #502453/T	\$141.83
199509101200000	OLSEN KENNETH E & DEBBIE L	LT 79 PER C/S #502453/T	\$141.83
199509101250000	LAWRENCE WILLIAM E	LT 80 PER C/S #502453/T	\$141.83
199509101300000	BAKER MICHAEL K & DALENA	LT 81 PER C/S #502453/T	\$141.83
199509101350000	OCHADLEUS WENDY LYNN	LT 82 COS 502453/T IN NW4NE4	\$141.83
199509201010000	HATCH KEITH B & GAIL L	LT 87 COS #502453/T	\$141.83
199509201050000	CLEMENS DAVID A & DEBORAH S	E2SWNW LT 88 COS #502453/T	\$141.83
199509201100000	LOMAHUKLUH MARTIN & TEHA M	LT 89 COS 502453/T	\$141.83
199509201150000	HEFFERNAN JAMES E & JOANNE	LT 90 PER C/S #502453/T	\$141.83
199509201200000	LINTNER GLENN & KATHIE (JT)	NORTH HILLS SUB LT 83 COS 502453/T	\$141.83
199509201250000	COOPERIDER WAYDE & ELEANOR	LT 84 COS #502453/T	\$141.83
199509201300000	POST JOHN W & BARBARA S	NORTH HILLS SUB LT 85	\$141.83
199509201350000	PURCELL RICHARD MARTIN	LT 86 PER C/S #502453/T AKA NORTH HILLS	\$141.83
199509301180000	FLEWELLEN RONALD J & SANDRA K	PT E2NESW LT 98A COS #562171/F	\$141.83
199509301200000	JEWELL JAMES E & LINDA A	PT E2NE4SW4 LT 98 B C/S 562171/F	\$141.83
199509401200000	NYSTRAND ROBERT	LT 95 PER COS #502453/T	\$141.83
199509401250000	PATRICK KEITH E	LT 96 COS #502453/T	\$141.83
199509401300000	VACA DENNIS	LT 97 PER C/S #502453/T	\$141.83
199510201010000	UTICK ANDREW J	LT 32 PER C/S #271123	\$141.83
199510201050000	MINER MICHAEL J & PURCELL DONNA J JT/ROS	LT 31 COS #271123	\$141.83
199510201100000	UTICK ANDREW J	LT 30 IN NW COS #271123	\$141.83
199510201150000	BRUNSON LEO & JACQUIE	LT 29 COS #271123	\$141.83
199510201200000	HENDERSON VICKI A	E2NENW LT 20 COS #271123	\$141.83
199510201250000	LOZANO JUAN & LUCY	LT 19 PER C/S #271123	\$141.83
199510201300000	WILLIAMS CLAUD R & MARK T	LT 18 C/S 271123	\$141.83
199510201350000	GILMAN MARLIN & DONNA	LT 17, COS 271123	\$141.83

File: ExcellRID Information\NorthHills\NHillsAmend2005.xls

Print date: December 5, 2005



COUNTY

**3098906**

Page: 4 of 4  
12/08/2005 02:35P

Bk-103 Pg-7352