

A RESOLUTION LEVYING AND ASSESSING A TAX UPON ALL BENEFITED PROPERTY WITHIN THE RURAL MAINTENANCE DISTRICT NO. 1987-4 AND 4C, MIDDLEMAS ROAD

WHEREAS, the Board of County Commissioners properly created and established the Middlemas Road Rural Maintenance District No. 1987-4 and 4C through Resolution 1987-78; and

WHEREAS, Section 7-12-2158, MCA, provides that the Board of County Commissioners shall by resolution levy and assess a tax upon all benefited property in a district created for such purpose; and

WHEREAS, Resolution 1987-78 provides a mechanism for assessing benefited properties based upon the benefits received; and

WHEREAS, the property owners of lots within the Middlemas Road RID were notified pursuant to Section 7-12-2159, MCA; and

NOW, THEREFORE, BE IT RESOLVED by the Board of County Commissioners of Lewis and Clark County, that an annual assessment of \$51.00 per lot for road maintenance activities shall be levied and assessed upon all benefited property within the boundaries of Rural Improvement District No. 1987-4 and 4C.

BE IT FURTHER RESOLVED that a description of each parcel of land, the name of each owner, and the amount of annual assessment for each parcel is contained on Exhibit "A" and a map of the district is shown as Exhibit "B", attached hereto and made a part hereof.

BE IT FURTHER RESOLVED that the assessment amount contained on attached Exhibit "A" shall be made in two equal payments by the day and month specified on the annual tax notice. Payments made after the specified dates shall be delinquent.

DATED this 3rd day of June, 2003.

BOARD OF COUNTY COMMISSIONERS
LEWIS AND CLARK COUNTY

Amia L. Varone
Amia L. Varone, Chair

Paulette J. DeHart, Clerk of Board

File: MiddlemasRateResol



Lewis & Clark County

COUNTY

EXHIBIT "A" MIDDLEMAS RID 87-4 PROPERTY OWNER LIST

GEOCODE	PROPERTY OWNER	LEGAL DESCRIPTION	ASSESSOR CODE	RID ASSESSMENT
188807401020000	MARTIN SHANE K & JILL E (JT/ROS)	ORO FINO NO 5 AMENDED LOT A-2, COS	000035228	\$51
188807401050000	WAKEFIELD LYNN H & ANNETTE	TR NEXT TO LT 1 ORO FINO # 2	000012495	\$51
188807401060000	DELAHUNT KASEY J & KIM D (JT/ROS)	ORO FINO SUBD NO 5 AMENDED LOT A-1, COS	000025047	\$51
188807401070000	KUNTZ RAYMOND J	ORO FINO SUBD NO 5 LOT B PER COS #498258	000027440	\$51
188807401080000	STEFANIK RODNEY L & DEBORAH A	TR IN SE AKA TR "F"	000026319	\$51
188807402010000	BRANDT TREVER ALLEN	ORO FINO SUB #3 LT C	000019822	\$51
188807402030000	HAVENS SAM M & KATHLEEN A	ORO FINO SUB #3:LT D	000019823	\$51
188807402050000	DOWNING KENNETH A & FAYE T	ORO FINO SUB #3 LT B	000019824	\$51
188807402070000	MANSFIELD DANIEL & PAULA	ORO FINO SUB #3 LT A	000019825	\$51
188807403010000	ROWSEY KATHY A	ORO FINO SUB #1 BLK 3 LT 6	000007940	\$51
188807403030000	EAST GERALD A & JOHNSON SHERRY	ORO FINO SUB #1 BLK 3 LT 7	000007891	\$51
188807403050000	MANN ARTHUR D & ANN M	ORO FINO SUB #1 BLK 3 LT 8	000012015	\$51
188807403070000	MAGILL ALICE A	ORO FINO SUB #1:BLK 3 LT 9:	000030883	\$51
188807403090000	MAGILL ALICE A	ORO FINO SUB #1 BLK 3 LT 10	000012001	\$51
188807404010000	WILBUR LLOYD F & DORIS E	ORO FINO SUB #1:BLK 1 LT 1 AMENDED	000007686	\$51
188807404030000	MECKLER FRANK R & TERESA A (JT)	ORO FINO SUB #1 AMENDED BLK 1 LT 2	000007960	\$51
188807404040000	HAHN C BRADLEY & SHANNON J (JT/ROS)	ORO FINO SUB #1 BLK 1 AMENDED LT 3A,	000007703	\$51
188807404090000	SHERLOCK EDWARD J & DELLA B	ORO FINO #1 BLK 1 LT 4	000007702	\$51
188807404110000	CYR JAMI & REUEL	ORO FINO SUB BLK 1 LT 5A C/S 380492	000007763	\$51
188807404130000	SAMPSON GILBERT S	ORO FINO SUB #1 BLK 1 LT 6	000021720	\$51
188807404150000	RENAUD EDWARD G & CAROLYN L	ORO FINO SUB #1 BLK 1 LT 7	000012258	\$51
188807404170000	NELSON WALTER O & ISABEL	ORO FINO SUB #1 BLK 1 LT 8	000012137	\$51
188807404190000	LAY ROBERT W	ORO FINO SUB #1 BLK 1 LT 9	000030906	\$51
188807404210000	SEED DANIEL C & CHERIE E	ORO FINO SUB #1 BLK 1 LT 10	000012132	\$51
188807404230000	LYNCH JAMES P & LINDA L	ORO FINO SUB #1 BLK 1 LT 11	000011781	\$51
188807404250000	LEWIS RICHARD K & ALICE M	ORO FINO SUB #1 BLK 1 LT 12	000011968	\$51
188807404270000	CARLSON MICHELLE ANN	ORO FINO SUB BLK 1 LT 13	000012416	\$51
188807404290000	HUANG ZHI YING & QICI	ORO FINO SUB #1 BLK 1 LT 14	000011947	\$51
188807405010000	ARMSTEAD WESLEY D & JOY L	ORO FINO SUB #2 LT 5	000012105	\$51
188807405030000	LEONARD THOMAS J & LYDIA F	ORO FINO SUB #2 LT 4	000011576	\$51
188807405050000	FAULKNER LYNDA L	ORO FINO SUB #2 LT 3	000011780	\$51
188807405070000	TOBEL FRANK E & KAREN K	ORO FINO SUB #2 LT 3	000011602	\$51
188807405090000	RASOR WILLIAM A JR & MELANIE K	ORO FINO SUB #2 LT 2A C/S 490534/B	000011841	\$51
188818101430000	LASKOWSKI RANDY & DONNA SEBASTIAN	ORO FINO SUB #2 LT 1	000024528	\$51
188818101440000	LAY MONIQUE	SHEPHERD SUB LT 1 COS 460964/E	000026218	\$51
188818101450000	BURKE WILMA	SHEPHERD SUB LT 2 COS #460964/E	000007806	\$51
188818104010000	CLEVELAND CARL L & CARRIE M	SHEPHERD SUB:LT 3	000007725	\$51
188818104030000	EGGEN KEVIN J & CA	ORO FINO # 1 ADDN BLK 2 LT 2	000007672	\$51
188818104050000	CRABBE DON A & SHARON L	ORO FINO SUB #1 BLK 2 LT 3	000007732	\$51
188818104070000	MESSMER KEITH A & ELAINE A	ORO FINO #1 BLK 2 LT 4	000007821	\$51
188818105010000	VANHEMELRYCK DEAN & ROBYN (JT)	ORO FINO SUB # 1 BLK 3 LT 1	000007860	\$51
188818105030000	ORSEF ROBERT SCOTT & AMELIA C	ORO FINO SUB #1 BLK 3 LT 2	000017521	\$51
188818105050000	SOLICH WILLIAM A & MILLICENT M	ORO FINO SUB #1 BLK 3 LT 3	000007965	\$51
188818105070000	SOLICH WILLIAM A & MILLICENT M	ORO FINO SUB #1:BLK 3 LT 4	000023184	\$51
188818105090000	KAPINOS MOLLIE A	ORO FINO SUB #1 BLK 3 LT 5	000007845	\$51

\$2,295

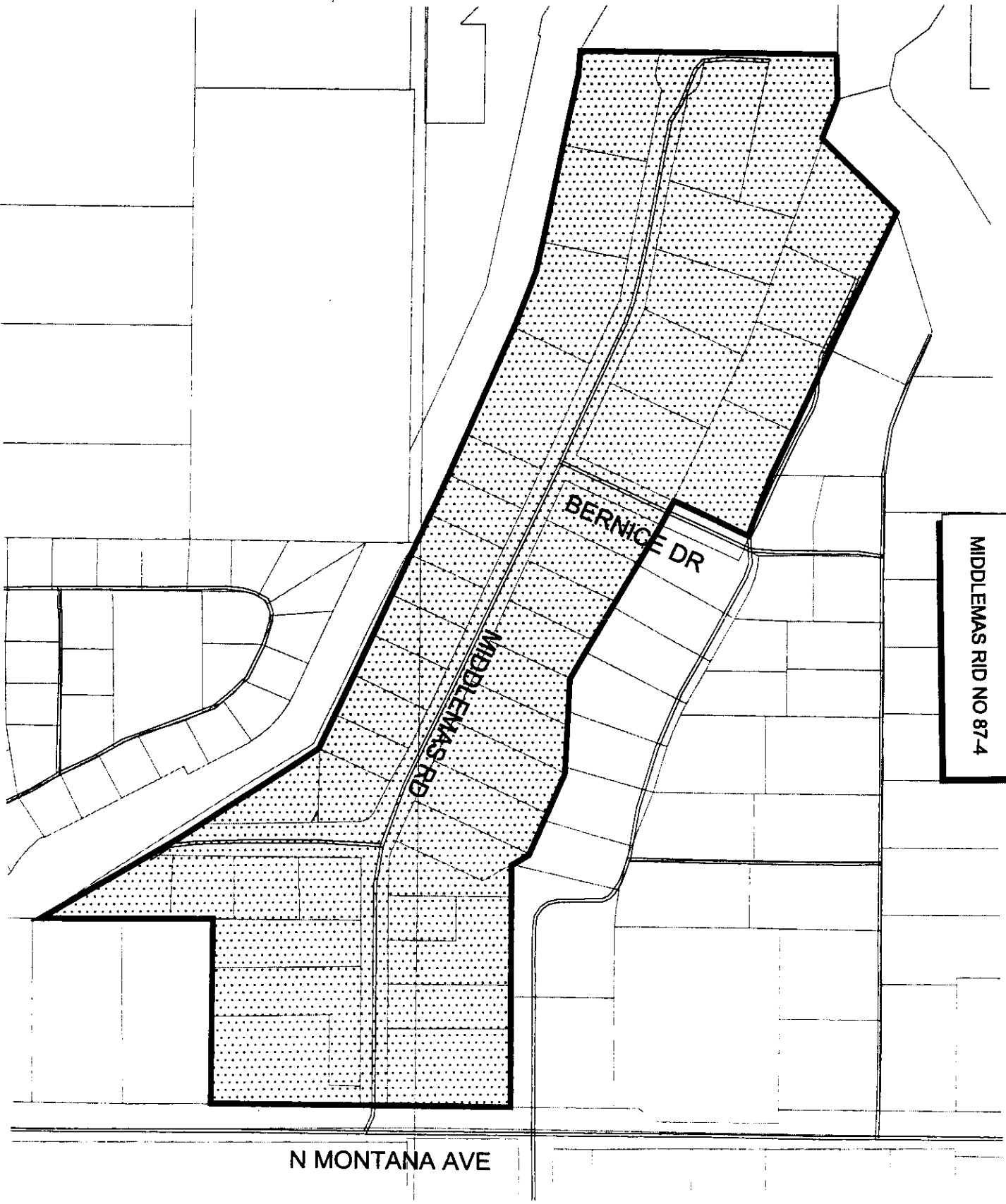

EXHIBIT "B"
MIDDLEMAS RID NO 87-4

N MONTANA AVE



3042620
Page: 3 of 9
06/05/2003 10:14A
Bk-M26 Pg-5266

Lewis & Clark County

COUNTY

Lewis and Clark County
Comm. Development and Planning
Helena MT

May 20, 2003

RE Middlemas Rd Rural Maintenance District
RID Special Assessment for Road Maintenance

We received your letter dated May 2, 2003 regarding the proposed assessed flat fee increase to \$51.00 per lot for the proposed chip and seal that is to be done in 2006.

I feel that this is a too drastic increase of our taxes . I am a retired state employee (due to medical reasons) and am on a fixed income. My husband is going to retire from the state soon and then our income will be marked fixed. As you may realize, this last school ballot resulted in an increase in our taxes again. The assessment of \$51.00 per lot is a very high assessment for any home . Little is done with the money we have already paid into the RID fund . We have the street cleaned once a year and maybe it gets snow-plowed twice a year. Otherwise, nothing is done with the prior years' RID monies. Reasonably , there is should be enough money to complete this project with the RID acct and some from the general county tax fund. Other roads such as McHugh, N. MT , Mill Rd , etc get use of some of the general county tax money and so should we as this is a well used road . Our road services this Oro Fino subdivision as well as the 2nd Oro Subdivision. The latter subdivision uses our road as much as the Middlemas Road home owners. The 2nd sub division has their own road system , but they use ours as it more convenient due to its straight construction verses their curvy construction.

Again I ask that we be assessed at a lower rate. I feel that the \$26.00 we pay now may not be enough and that an increase to \$40.00 would be more reasonable.

Sincerely Your,

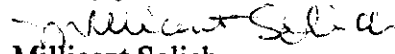

Millicent Solich
1013 Middlemas Rd
Helena MT 59602



COUNTY

3042620

Page: 4 of 9
06/05/2003 10:14A
Bk-M28 Pg-6288



To: L&C Clerk & Rec.
Paulette Deltart

From: Amy Orser

Date: 5/20/03

Re: RID Middlemas Rd.

Dear Mrs. Deltart,

I am unable to attend the meeting this morning as I am at work.

Please reconsider the \$25.00 annual RID increase you are proposing for our street. Along with other taxes, levies, assessments, fees, etc. that have also increased, this additional increase is unaffordable for many. Please table this proposal and propose an evening meeting for the residents to discuss the situation with the county.

Thank you very much.

Very sincerely -
Amy Orser



3042620

Page: 6 of 9
06/05/2003 10:14A
Bk-M28 Pg-6288

Lewis & Clark County

COUNTY

LEWIS AND CLARK COUNTY PLANNING DEPARTMENT

316 North Park Avenue, P. O. Box 1725
Helena, MT 59624; Phone: 447-8374

MEMORANDUM

DATE: May 13, 2003
FILE: MiddlemasRateMemo

TO: Board of County Commissioners

FROM: Marni Bentley, Administrative Assistant

SUBJECT: Middlemas Road RID Rate Hearing

*Public
right
hearing
6/3
5:30*

A rate hearing for the Middlemas Road RID is scheduled for the public meeting on May 20, 2003. Notice of the increase was published in the Helena Independent Record, in accordance with the statutes. In addition, a letter was sent to each owner of property within the district letting them know of the hearing. A draft resolution and rate schedule was made available for review in the Clerk and Recorder's office.

According to information from the Lewis and Clark County Public Works Department, the last chip-seal project was done on these roads in September of 1999. The next chip-seal will be due in August of 2006 and based on current assessments, there will not be enough revenue in the fund to pay for this project. It has been determined that the rates should be increased at this time in anticipation of this project. This will result in a gradual increase and should eliminate the need to borrow money for the project.

As of May 13, 2003, the Planning Department has only received one telephone inquiry regarding the assessments. The caller thought this fee was in addition to the current assessment, however, it is in place of the current assessment. Staff recommends approval of the resolution for an increase in the assessment for the Middlemas Road RID to \$51.00 per year per lot.

What was it before?

CAR's RACI document - Support (shown all)

Any other - MIDDLEMAS ROAD

Miley Solich - " "

RESOLUTION 2003 -

**A RESOLUTION LEVYING AND ASSESSING A TAX UPON ALL
BENEFITED PROPERTY WITHIN THE RURAL MAINTENANCE
DISTRICT NO. 1987-4 AND 4C, MIDDLEMAS ROAD**

WHEREAS, the Board of County Commissioners properly created and established the Middlemas Road Rural Maintenance District No. 1987-4 and 4C through Resolution 1987-78; and

WHEREAS, Section 7-12-2158, MCA, provides that the Board of County Commissioners shall by resolution levy and assess a tax upon all benefited property in a district created for such purpose; and

WHEREAS, Resolution 1987-78 provides a mechanism for assessing benefited properties based upon the benefits received; and

WHEREAS, the property owners of lots within the Middlemas Road RID were notified pursuant to Section 7-12-2159, MCA; and

NOW, THEREFORE, BE IT RESOLVED by the Board of County Commissioners of Lewis and Clark County, that an annual assessment of \$51.00 per lot for road maintenance activities shall be levied and assessed upon all benefited property within the boundaries of Rural Improvement District No. 1987-4 and 4C.

BE IT FURTHER RESOLVED that a description of each parcel of land, the name of each owner, and the amount of annual assessment for each parcel is contained on Exhibit "A" and a map of the district is shown as Exhibit "B", attached hereto and made a part hereof.

BE IT FURTHER RESOLVED that the assessment amount contained on attached Exhibit "A" shall be made in two equal payments by the day and month specified on the annual tax notice. Payments made after the specified dates shall be delinquent.

DATED this _____ day of _____, 2003.

BOARD OF COUNTY COMMISSIONERS
LEWIS AND CLARK COUNTY

Anita L. Varone, Chair

ATTEST:

Paulette J. DeHart, Clerk of Board

File: MiddlemasRateResol



Lewis & Clark County

COUNTY

3042620

Page: 7 of 9
06/05/2003 10:14A
Bk-M28 Pg-6288



Lewis & Clark County

COUNTY

3042620

Page: 8 of 8
05/05/2003 10:14A
BK-126 Pg-8268

EXHIBIT "A" MIDDLEMAS RID 87-4 PROPERTY OWNER LIST

GEocode	PROPERTY OWNER	LEGAL DESCRIPTION	ASSESSOR CODE	ASSESSMENT
188807401020000	MARTIN SHANE K & JILL E (JT/ROS)	ORO FINO NO 5 AMENDED LOT A-2, COS TR NEXT TO LT 1 ORO FINO # 2	0000335228	\$51
188807401050000	WAKEFIELD LYNN H & ANNETTE	ORO FINO SUBD NO 5 AMENDED LOT A-1, COS	000012495	\$51
188807401060000	DELAHUNT KASEY J & KIM D (JT/ROS)	ORO FINO SUBD NO 5 LOT B PER COS #498258	000025047	\$51
188807401070000	KUNTZ RAYMOND J	TR IN SE AKA TR "F"	000027440	\$51
188807401080000	STEFANIK RODNEY L & DEBORAH A	ORO FINO SUB #3 LT C	000026319	\$51
188807402010000	BRANDT TREVER ALLEN	ORO FINO SUB #3 LT D	000019822	\$51
188807402030000	HAVENS SAM M & KATHLEEN A	ORO FINO SUB #3 LT B	000019823	\$51
188807402050000	DOWNING KENNETH A & FAYE T	ORO FINO SUB #3 LT A	000019824	\$51
188807402070000	MANSFIELD DANIEL & PAULA	ORO FINO SUB #1 BLK 3 LT 6	000019825	\$51
188807403010000	ROWSEY KATHY A	ORO FINO SUB #1 BLK 3 LT 7	000007940	\$51
188807403030000	EAST GERALD A & JOHNSON SHERRY	ORO FINO SUB #1 BLK 3 LT 7	000007891	\$51
188807403050000	MANN ARTHUR D & ANN M	ORO FINO SUB #1 BLK 3 LT 8	000012015	\$51
188807403070000	MAGILL ALICE A	ORO FINO SUB #1:BLK 3 LT 9;	000030883	\$51
188807403090000	MAGILL ALICE A	ORO FINO SUB #1 BLK 3 LT 10	000012001	\$51
188807404010000	WILBUR LLOYD F & DORIS E	ORO FINO SUB #1:BLK 1 LT 1 AMENDED	000007686	\$51
188807404030000	MECKLER FRANK R & TERESA A (JT)	ORO FINO SUB #1 AMENDED BLK 1 LT 2	000007960	\$51
188807404050000	HAHN C BRADLEY & SHANNON J (JT/ROS)	ORO FINO SUB #1 BLK 1 AMENDED LT 3A,	000007703	\$51
188807404090000	SHERLOCK EDWARD J & DELLA B	ORO FINO #1 BLK 1 LT 4	000007702	\$51
188807404110000	CYR JAMI & REUEL	ORO FINO SUB BLK 1 LT 5A C/S 380492	000007763	\$51
188807404130000	SAMPSON GILBERT S	ORO FINO SUB #1 BLK 1 LT 6	000021720	\$51
188807404150000	RENAUD EDWARD G & CAROLYN L	ORO FINO SUB #1 BLK 1 LT 7	000012258	\$51
188807404170000	NELSON WALTER O & ISABEL	ORO FINO SUB #1 BLK 1 LT 8	000012137	\$51
188807404190000	LAY ROBERT W	ORO FINO SUB BLK 1 LT 9	000030906	\$51
188807404210000	SEED DANIEL C & CHERIE E	ORO FINO SUB #1 BLK 1 LT 10	000012132	\$51
188807404230000	LYNCH JAMES P & LINDA L	ORO FINO SUB #1 BLK 1 LT 11	000011781	\$51
188807404250000	LEWIS RICHARD K & ALICE M	ORO FINO SUB #1 BLK 1 LT 11	000011968	\$51
188807404270000	CARLSON MICHELLE ANN	ORO FINO SUB #1 BLK 1 LT 12	000012416	\$51
188807404290000	HUANG ZHI YING & QICI	ORO FINO SUB BLK 1 LT 13	000011947	\$51
188807405010000	ARMSTEAD WESLEY D & JOY L	ORO FINO SUB #1 BLK 1 LT 14	000011947	\$51
188807405030000	LEONARD THOMAS J & LYDIA F	ORO FINO SUB # 2 LT 5	000012105	\$51
188807405050000	FAULKNER LYNDAL L	ORO FINO SUB #2 LT 4	000011576	\$51
188807405070000	TOBEL FRANK E & KAREN K	ORO FINO SUB #2 LT 3	000011780	\$51
188807405090000	RASOR WILLIAM A JR & MELANIE K	ORO FINO SUB #2 LT 3	000011602	\$51
188818101430000	LASKOWSKI RANDY & DONNA SEBASTIAN	ORO FINO SUB #2 LT 1	000011841	\$51
188818101440000	LAY MONIQUE	SHEPHERD SUB LT 1 COS #460964/E	000024528	\$51
188818101450000	BURKE WILMA	SHEPHERD SUB LT 2 COS #460964/E	000026218	\$51
188818104010000	CLEVELAND CARR L & CARRIE M	SHEPHERD SUB:LT 3	000007806	\$51
188818104030000	EGGEN KEVIN J & CA	ORO FINO SUB BLK 2 LT 1A COS 490533	000007725	\$51
188818104050000	CRABBE DON A & SHARON L	ORO FINO # 1 ADDN BLK 2 LT 2	000007672	\$51
188818104070000	MESSMER KEITH A & ELAINE A	ORO FINO SUB #1 BLK 2 LT 3	000007732	\$51
188818105010000	VANHAMEL RYCK DEAN & ROBYN (JT)	ORO FINO #1 BLK 2 LT 4	000007821	\$51
188818105030000	ORSER ROBERT SCOTT & AMELIA C	ORO FINO SUB # 1 BLK 3 LT 1	000007860	\$51
188818105050000	SOLICH WILLIAM A & MILLICENT M	ORO FINO SUB #1 BLK 3 LT 2	000017521	\$51
188818105070000	SOLICH WILLIAM A & MILLICENT M	ORO FINO SUB #1 BLK 3 LT 3	000007965	\$51
188818105090000	KAPINOS MOLLIE A	ORO FINO SUB #1:BLK 3 LT 4	000023184	\$51
		ORO FINO SUB #1 BLK 3 LT 5	000007845	\$51

\$2,295

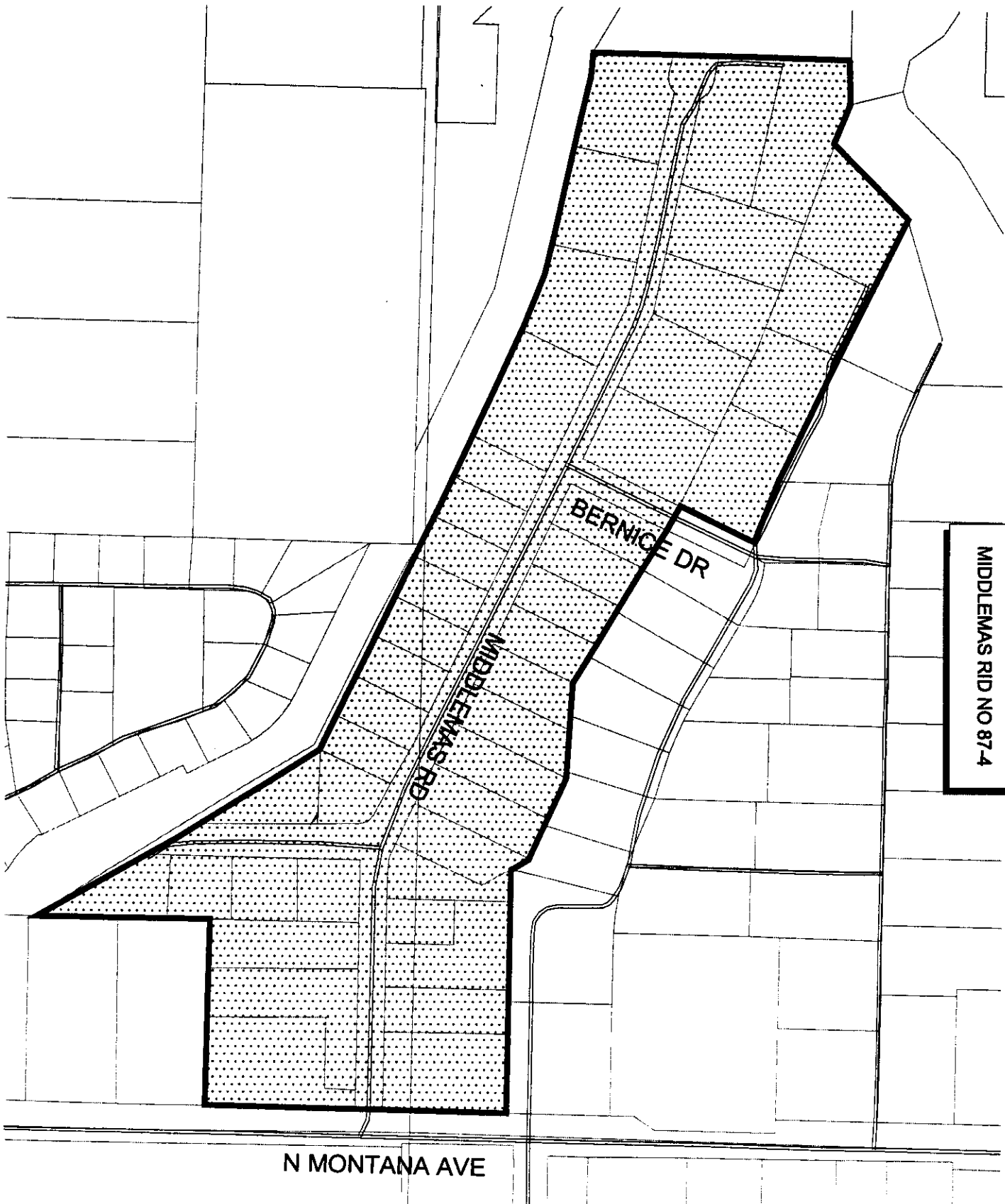

EXHIBIT "B"
MIDDLEMAS RID NO 87-4

N MONTANA AVE



3042620
Page: 9 of 9
06/05/2003 10:14A
Bk-M28 Pg-6268

Lewis & Clark County

COUNTY