

A RESOLUTION LEVYING AND ASSESSING A TAX UPON ALL BENEFITED PROPERTY WITHIN THE RURAL IMPROVEMENT DISTRICT NO. 2000-1, GOLDEN ESTATES

WHEREAS, the Board of County Commissioners properly created and established the Golden Estates Rural Improvement District No. 2000-1 through Resolution 2000-113; and

WHEREAS, Section 7-12-2158, MCA, provides that the Board of County Commissioners shall by resolution levy and assess a tax upon all benefited property in a district created for such purpose; and

WHEREAS, Resolution 2000-113 provides a mechanism for assessing benefited properties based upon the benefits received; and

WHEREAS, Section 7-12-2161, MCA, provides that the Board of County Commissioners may change the boundaries of a maintenance district; and

WHEREAS, Golden Estates III has been final platted and now benefits from the use of Yuhas Road and Traufer Avenue and should be incorporated into the Rural Improvement District; and

WHEREAS, the developer of Golden Estates III has petitioned the Board of County Commissioners to annex the subdivision into the existing RID for the purpose of maintaining the internal access roads; and

WHEREAS, the property owners of lots within the existing RID and the owners of the lots proposed for annexation were notified pursuant to Section 7-12-2159, MCA; and

NOW, THEREFORE, BE IT RESOLVED by the Board of County Commissioners of Lewis and Clark County, that an annual assessment of \$64.76 per lot for road maintenance activities shall be levied and assessed upon all benefited property within the boundaries of Rural Improvement District No. 2000-1.

BE IT FURTHER RESOLVED that the lots in Golden Estates III be annexed into the district and be assessed for road maintenance activities.

BE IT FURTHER RESOLVED that a description of each parcel of land, the name of each owner, and the amount of annual assessment for each parcel is contained on Exhibit "A" and a map of the district is shown as Exhibit "B", attached hereto and made a part hereof.

BE IT FURTHER RESOLVED that the assessment amount contained on attached Exhibit "A" shall be made in two equal payments by the day and month specified on the annual tax notice. Payments made after the specified dates shall be delinquent.

DATED this 17 day of June, 2003.



BOARD OF COUNTY COMMISSIONERS
LEWIS AND CLARK COUNTY

Amita L. Varone
Amita L. Varone, Chair

ATTEST:

Paulette J. DeHart
Paulette J. DeHart, Clerk of Board
File: GoldenAnnexResol



Lewis & Clark County

COUNTY

3043566
Page: 1 of 5
06/18/2003 12:27P
Bk-M28 Pg-7174

EXHIBIT "A"

GOLDEN ESTATES RID 2000-1

RID

GEOCODE	PROPERTY LOCATION	PROPERTY OWNER	LEGAL	ASSESSMENT
188818110970000	3700 YUHAS AVENUE	PERPIGNANO ANTHONY & LISA	GOLDEN ESTATES III	\$64.76
188818110950000	3708 YUHAS AVENUE	SMITH LARRY KIM	GOLDEN ESTATES III	\$64.76
188818110930000	3710 YUHAS AVENUE	YUHAS RON	GOLDEN ESTATES III	\$64.76
188818110910000	3716 YUHAS AVENUE	SMITH LARRY KIM	GOLDEN ESTATES III	\$64.76
188818110890000	3720 YUHAS AVENUE	HAMLIN CONSTRUCTION	GOLDEN ESTATES III	\$64.76
188818110870000	3724 YUHAS AVENUE	MCLAUGHLIN DENNIS	GOLDEN ESTATES III	\$64.76
188818110850000	3726 YUHAS AVENUE	GEORGE LEO F & CINDI	GOLDEN ESTATES III	\$64.76
188818110810000	3730 YUHAS AVENUE	WALKER MAUREENA C & MESSENGER DAVID	GOLDEN ESTATES III	\$64.76
188818110790000	3732 YUHAS AVENUE	SMITH LARRY KIM	GOLDEN ESTATES III	\$64.76
188818110770000	3736 YUHAS AVENUE	HAMLIN CONSTRUCTION	GOLDEN ESTATES III	\$64.76
188818110750000	3738 YUHAS AVENUE	GOLDEN EAGLE CONSTRUCTION	GOLDEN ESTATES III	\$64.76
188818110730000	3740 YUHAS AVENUE	YUHAS RON	GOLDEN ESTATES III	\$64.76
188818110710000	3742 YUHAS AVENUE	HAMLIN CONSTRUCTION	GOLDEN ESTATES III	\$64.76
188818110690000	3780 TRAUFRER AVENUE	YUHAS RON	GOLDEN ESTATES III	\$64.76
188818110670000	3790 TRAUFRER AVENUE	HAMLIN CONSTRUCTION	GOLDEN ESTATES III	\$64.76
188818110650000	3795 TRAUFRER AVENUE	WARREN MICHAEL & MARYA	GOLDEN ESTATES III	\$64.76
188818110630000	3785 TRAUFRER AVENUE	BOYNTON BRETT A	GOLDEN ESTATES III	\$64.76
188818110610000	3748 YUHAS AVENUE	HAMLIN CONSTRUCTION	GOLDEN ESTATES III	\$64.76
188818110590000	3754 YUHAS AVENUE	MILLER TODD & JILL	GOLDEN ESTATES III	\$64.76
188818110570000	3762 YUHAS AVENUE	O'BRIAN CORY & RACHEL ANN	GOLDEN ESTATES III	\$64.76
188818110550000	3766 YUHAS AVENUE	HEWITT BERNARD & TOMIKO	GOLDEN ESTATES III	\$64.76
188818110470000	3799 YUHAS AVENUE	HAMLIN CONSTRUCTION	GOLDEN ESTATES III	\$64.76
188818110430000	3793 YUHAS AVENUE	HAMLIN CONSTRUCTION	GOLDEN ESTATES III	\$64.76
188818110410000	3787 YUHAS AVENUE	YUHAS RON	GOLDEN ESTATES III	\$64.76
188818110390000	3781 YUHAS AVENUE	SMITH LARRY KIM	GOLDEN ESTATES III	\$64.76
188818110370000	3775 YUHAS AVENUE	LAWRENCE CHAD & STEFANA	GOLDEN ESTATES III	\$64.76
188818110340000	3763 YUHAS AVENUE	HAMLIN CONSTRUCTION	GOLDEN ESTATES III	\$64.76
188818110320000	3759 YUHAS AVENUE	YUHAS RON	GOLDEN ESTATES III	\$64.76
188818110300000	3751 YUHAS AVENUE	HAMLIN CONSTRUCTION	GOLDEN ESTATES III	\$64.76
188818110280000	3747 YUHAS AVENUE	YUHAS RON	GOLDEN ESTATES III	\$64.76
188818110260000	3743 YUHAS AVENUE	YUHAS RON	GOLDEN ESTATES III	\$64.76
188818110240000	3741 YUHAS AVENUE	YUHAS RON	GOLDEN ESTATES III	\$64.76
188818110210000	3739 YUHAS AVENUE	HAMLIN CONSTRUCTION	GOLDEN ESTATES III	\$64.76
188818110190000	3735 YUHAS AVENUE	YUHAS RON	GOLDEN ESTATES III	\$64.76
188818110170000	3731 YUHAS AVENUE	YUHAS RON	GOLDEN ESTATES III	\$64.76
188818110150000	3729 YUHAS AVENUE	HAMLIN CONSTRUCTION	GOLDEN ESTATES III	\$64.76
188818110120000	3725 YUHAS AVENUE	KOCH KOURTNEY & CANDICE	GOLDEN ESTATES III	\$64.76
188818110100000	3723 YUHAS AVENUE	YUHAS RON	GOLDEN ESTATES III	\$64.76
188818110080000	3717 YUHAS AVENUE	RYLKOV MAX	GOLDEN ESTATES III	\$64.76
188818110060000	3713 YUHAS AVENUE	HAMLIN CONSTRUCTION	GOLDEN ESTATES III	\$64.76



Leas & Clark County

COUNTY

3043566

Page: 2 of 5
06/18/2009 12:27P
BK-128 Pg-7174

EXHIBIT "A"

GEOCODE	PROPERTY LOCATION	PROPERTY OWNER	LEGAL	RID	ASSESSMENT
188818110040000	3709 YUHAS AVENUE	HAMLIN CONSTRUCTION	GOLDEN ESTATES III	LOT 41	\$64.76
188818110010000	3701 YUHAS AVENUE	SMITH LARRY KIM	GOLDEN ESTATES III	LOT 42	\$64.76
188818101230000	790 FAW	RE YUHAS RALPH G & HAZEL	TR PER C/S# 446436/O		\$64.76
188818101250000	720 FAW	RE FORTRESS OF JOY INC	KING MINOR, LOT 1		\$64.76
188818101300000	750 FAW	RE DIRKS DENNIS D & SUSAN K	KING MINOR, LOT 2		\$64.76
188818101320000	770 FAW	RE SILVONEN DICK J & CYNTHIA J	KING MINOR, LOT 3		\$64.76
188818101340000	0 UNKNOWN	KING MARC MATTHEW & MICHELLE	KING MINOR, LOT 4		\$64.76
188818106010000	3830 TRAUFRER	KERINS JAMES M & CORINA M	GOLDEN ESTATES II	LOT 4-1	\$64.76
188818106030000	815 FAW	RE GREENWOOD CASEY &	GOLDEN ESTATES II	LOT 4-2	\$64.76
188818106050000	825 FAW	RE ASHBY DAVID W & ANGELA M	GOLDEN ESTATES II	LOT 4-3	\$64.76
188818106070000	835 FAW	RE HAMPTON KEITH D & PAMELA E	GOLDEN ESTATES II	LOT 4-4	\$64.76
188818106090000	845 FAW	RE FULLER JAMES E & GINA R	GOLDEN ESTATES II	LOT 4-5	\$64.76
188818106110000	855 FAW	RE FLYNN LAWRENCE J & PENNIE CATHERINE L	GOLDEN ESTATES II	LOT 4-6	\$64.76
188818106150000	865 FAW	RE WRIGHT TYLER S	GOLDEN ESTATES II	LOT 4-7	\$64.76
188818107010000	3835 YUHAS	A FONTAINE JOSEPH A	GOLDEN ESTATES II	LOT 1-21	\$64.76
188818107030000	3845 YUHAS	A BENNETT MARK J & LAURA E	GOLDEN ESTATES II	LOT 1-20	\$64.76
188818107050000	3855 YUHAS	A HOLSHUE MARLENE M & MOLLY E	GOLDEN ESTATES II	LOT 1-19	\$64.76
188818107070000	3865 YUHAS	A STOVALL JAY O SR & JUANITA J	GOLDEN ESTATES II	LOT 1-18	\$64.76
188818107090000	3875 YUHAS	A ANASON RONALD J & SHARON	GOLDEN ESTATES II	LOT 1-17	\$64.76
188818107110000	3885 YUHAS	A FULLER VERTA M	GOLDEN ESTATES II	LOT 1-16	\$64.76
188818107130000	3895 YUHAS	A PETERSON TAMMY JO	GOLDEN ESTATES II	LOT 1-15	\$64.76
188818107150000	3905 YUHAS	A MOHN DENICE L	GOLDEN ESTATES II	LOT 1-14	\$64.76
188818107170000	3915 YUHAS	A JOHNSON CURTIS L & EDNA M	GOLDEN ESTATES II	LOT 1-13	\$64.76
188818107190000	3925 YUHAS	A EICHLER DEBRA S	GOLDEN ESTATES II	LOT 1-12	\$64.76
188818107210000	3935 YUHAS	A ALVINO MANDY L	GOLDEN ESTATES II	LOT 1-11	\$64.76
188818107230000	3945 YUHAS	A MIRANTI LINDA M	GOLDEN ESTATES II	LOT 1-10	\$64.76
188818107250000	3955 YUHAS	A HADDON STEVEN C & JOANNA C	GOLDEN ESTATES II	LOT 1-9	\$64.76
188818107270000	3930 TRAUFRER	LARSON KEITH O & BARBARA	GOLDEN ESTATES II	LOT 1-8	\$64.76
188818107290000	3920 TRAUFRER	MOUSSEAU PAUL J & JANINE S	GOLDEN ESTATES II	LOT 1-7	\$64.76
188818107310000	3910 TRAUFRER	BUGNI MATTHEW R & KATHERINE T (JT/ROS)	GOLDEN ESTATES II	LOT 1-6	\$64.76
188818107330000	3900 TRAUFRER	STEVISON THOMAS W & PHYLLIS M (JT/ROS)	GOLDEN ESTATES II	LOT 1-5	\$64.76
188818107350000	3890 TRAUFRER	TROYER TED J	GOLDEN ESTATES II	LOT 1-4	\$64.76
188818107370000	3880 TRAUFRER	BINGHAM SHAUNA R	GOLDEN ESTATES II	LOT 1-3	\$64.76
188818107390000	3870 TRAUFRER	FORMO MARVIN L & LORENA R (JT)	GOLDEN ESTATES II	LOT 1-2	\$64.76
188818107410000	3860 TRAUFRER	BELCHER TRAVIS M	GOLDEN ESTATES II	LOT 1-1	\$64.76
188818108010000	810 FAW	RE RITTER ROSS	GOLDEN ESTATES II	LOT 3-9	\$64.76
188818108030000	820 FAW	RE DOBBINS DAVID S & SARA	GOLDEN ESTATES II	LOT 3-8	\$64.76
188818108050000	830 FAW	RE CARPENTER GERALD P & DONA	GOLDEN ESTATES II	LOT 3-7	\$64.76
188818108070000	840 FAW	RE O'MARA JOHN R & JENNIFER L	GOLDEN ESTATES II	LOT 3-6	\$64.76
188818108090000	850 FAW	RE MCLEAN DAVID M & DARCY R	GOLDEN ESTATES II	LOT 3-5	\$64.76

Clark County
COUNTY
3043566
Page: 3 of 5
06/18/2009 12:27P
BK-112B Pg-7174

EXHIBIT "A"	GEOCODE	PROPERTY LOCATION	PROPERTY OWNER	LEGAL	RID	ASSESSMENT
			GOLDEN ESTATES RID 2000-1			
			PROPERTY OWNER			
188818108110000	835	ONYX	PILANE MATTHEW R & HOLLY A	GOLDEN ESTATES II	LOT 3-4	\$64.76
188818108130000	825	ONYX	PI ABRAHAMSON MICHAEL T & STACEY L	GOLDEN ESTATES II	LOT 3-3	\$64.76
188818108150000	815	ONYX	PI HOUSE TIM & TY	GOLDEN ESTATES II	LOT 3-2	\$64.76
188818108170000	805	ONYX	PI HELFERT AARON L & KATHIE M	GOLDEN ESTATES II	LOT 3-1	\$64.76
188818109010000	810	ONYX	PI NORTHY WILLIAM T & JULIE M	GOLDEN ESTATES II	LOT 2-3	\$64.76
188818109030000	820	ONYX	PI ROBERTSON SCOTT & JANINE	GOLDEN ESTATES II	LOT 2-4	\$64.76
188818109050000	830	ONYX	PI FLOERCHINGER MARK & FRANKS AIMEE	GOLDEN ESTATES II	LOT 2-5	\$64.76
188818109120000	3930	YUHAS	A BRANDT THANE G & KATHRYN L (JT)	GOLDEN ESTATES II	LOT 2-2	\$64.76
188818109140000	0	UNKNOWN	SWINGLEY JEFFREY K & ROXANNE L	GOLDEN ESTATES II	LOT 2-1	\$64.76
						\$5,763.64



3043566
 Page: 4 of 5
 06/18/2003 12:27P
 Bk-M28 Pg-7174



3043566

Page: 5 of 5
08/18/2003 12:27P
Bk-M28 Pg-7174



EXHIBIT "B"

Existing Golden Estates II
RID No. 2000-1

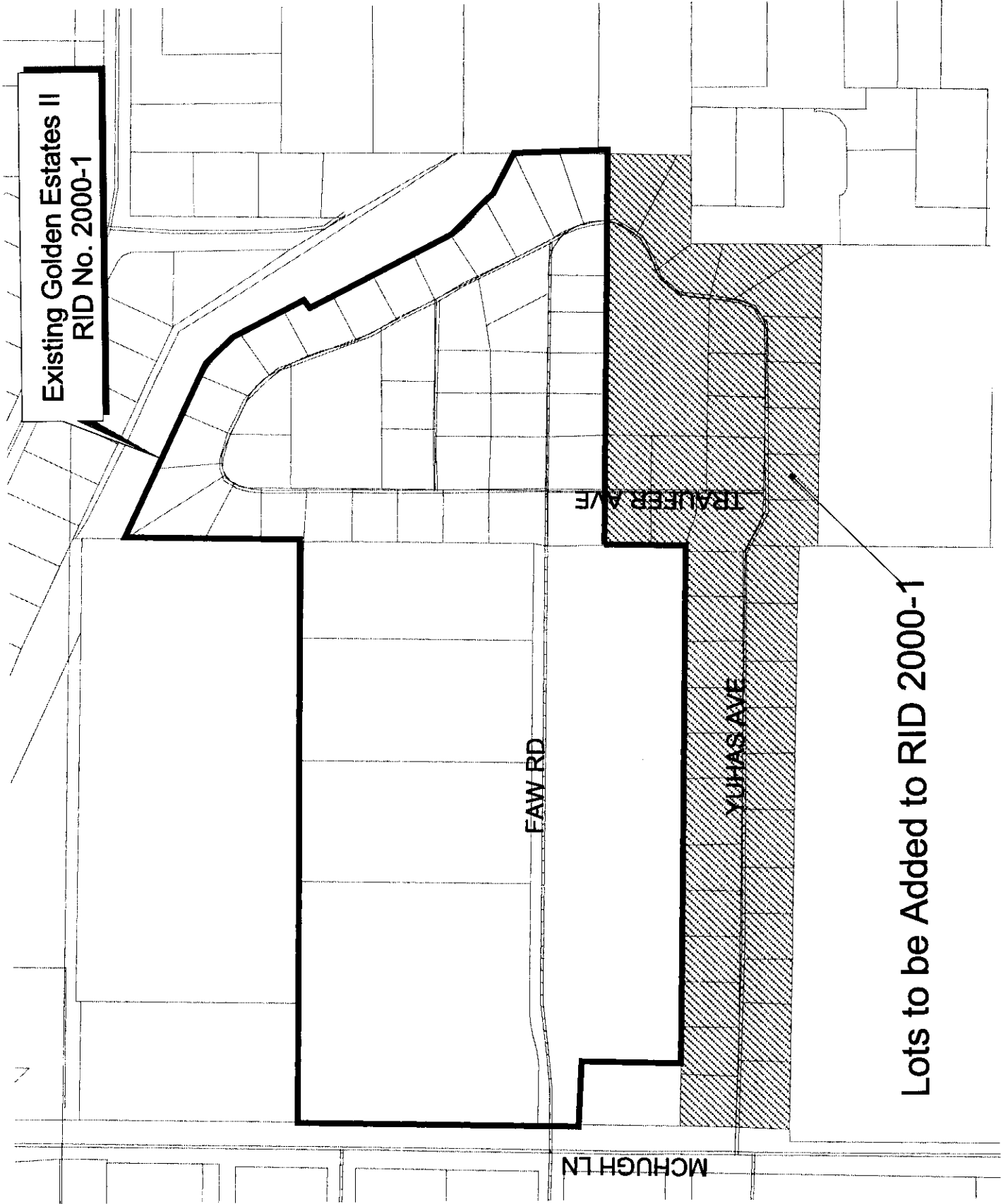

Lots to be Added to RID 2000-1

MCHUGH LN

FAW RD

YUHAS AVE

TRAILER AVE