

RESOLUTION 2004- 55

**A RESOLUTION TO CREATE RURAL IMPROVEMENT DISTRICT NO. 2004-2
FOR THE FAWN MEADOW ESTATES MAJOR SUBDIVISION**

WHEREAS, a resolution of intention to create Rural Improvement District No. 2004-2 was adopted by the Board of County Commissioners on April 1, 2004, as Resolution 2004-46; and

WHEREAS legal notice of the passage of Resolution 2004-46 was mailed to property owners in the proposed district and printed in the local newspaper in accordance with the statutory requirements; and

WHEREAS, on April 27, 2004, the Board of County Commissioners held a public hearing and proceeded to hear all protests, comments, and other matters relating to the proposed district, and determined that the boundaries of the district benefit area and the method of assessment were equitable; and

WHEREAS, it was determined that there was not sufficient protest to bar proceedings; said protests constituting 0% of the cost of the proposed work.

NOW, THEREFORE, BE IT RESOLVED by the Lewis and Clark County Board of County Commissioners that it does hereby create the Fawn Meadow Estates Rural Improvement District No. 2004-2, for the purpose of equitably funding road improvements and maintenance on Fawn Meadow Drive, Ed Rose Drive, Catrina Court and the mailbox turnout.

BE IT FURTHER RESOLVED that said maintenance district will include those parcels of land abutting and/or accessing the roads in the Fawn Meadow Estates Major Subdivision shown on Exhibit "A" and listed on Exhibit "B", attached hereto and made a part hereof.

BE IT FURTHER RESOLVED that the improvements include a chip-seal application to the roads listed above.

BE IT FURTHER RESOLVED that the annual costs for said improvements are \$2,145.21 for a period of ten (10) years. Each lot shall benefit equally and shall be assessed \$76.61 annually for said improvements to the internal roads. All funds collected for the improvement district shall be spent solely for the road improvements within the proposed district.

BE IT FURTHER RESOLVED that the maintenance shall include contributions to a reserve account for future surface treatment (e.g. chipseal) and other maintenance and repair as necessary to preserve the road surfaces, and that such maintenance shall be administered by the County.

BE IT FURTHER RESOLVED that the annual costs for said maintenance are \$1,663.67. Each lot shall benefit equally and shall be assessed \$59.42 annually for said maintenance of the internal roads. All funds collected for the maintenance district shall be spent solely for the road maintenance activities within the proposed district.

BE IT FURTHER RESOLVED that the maintenance district shall remain in effect in perpetuity or until such action by the Board of County Commissioners otherwise dissolves the district.

DATED this 27 day of April, 2004.

BOARD OF COUNTY COMMISSIONERS
LEWIS AND CLARK COUNTY

Michael A. Murray, Chairman

ATTEST:

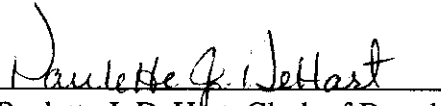
Paulette J. DeHart, Clerk of Board

Attachments: Exhibit "A" & Exhibit "B"

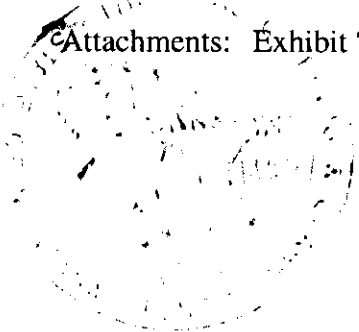

3063483

Page: 2 of 4
04/30/2004 01:25P
Bk-M30 Pg-6013

Lewis & Clark County

COUNTY

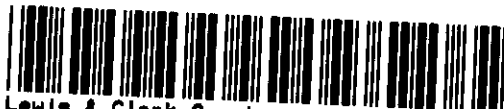

3063483

Page: 3 of 4
04/30/2004 01:25P
Bk-M30 Pg-6013

Lewis & Clark County

COUNTY

FRONTAGE DR

MUNGER RD

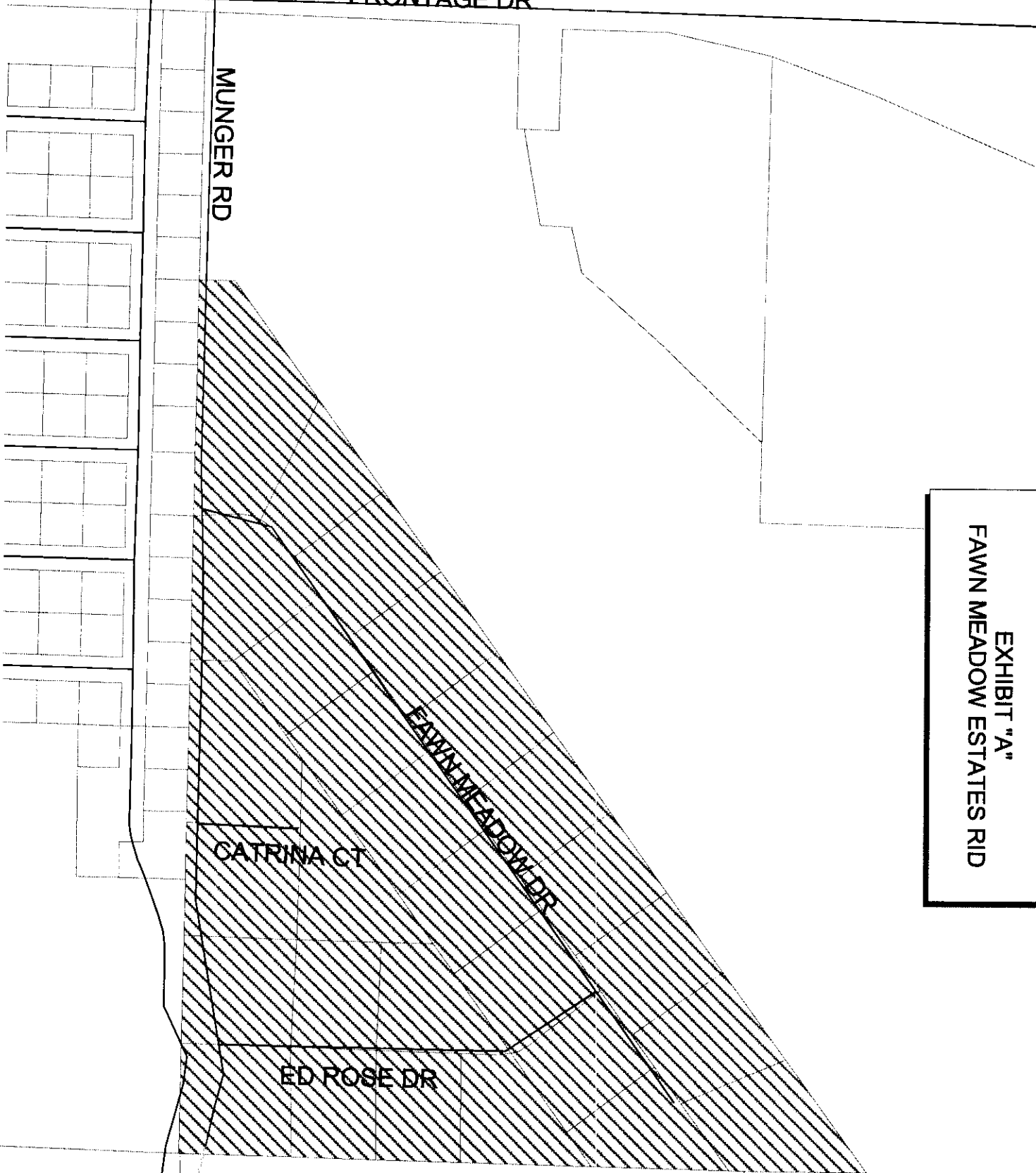

EXHIBIT "A"
FAWN MEADOW ESTATES RID



EXHIBIT "B"

FAWN MEADOW ESTATES RID PROPERTY OWNER LIST

Fawn Meadow Drive, Ed Rose Drive, Catrina Court and the mailbox turnout only

ASSESSMENTS

GEOCODE	PROPERTY LOCATION	PROPERTY OWNER	LEGAL	ASSESSMENTS	
				IMPROVEMENT 10 years only	MAINTENANCE on-going
188805402010000	3902 CATRINA CT	BECK JAMES R & LIA	FAWN MEADOW SUBD LT 26 COS #3001911	\$76.61	\$59.42
188805402030000	3927 CATRINA CT	SWARENS C S & M J (JT)	FAWN MEADOW SUBD LT 28 COS #3001911	\$76.61	\$59.42
188805402050000	3903 CATRINA CT	GOLDEN EAGLE CONSTRUCTION INC	FAWN MEADOW SUBD LT 27 COS #3001911	\$76.61	\$59.42
188805402070000	3904 ED ROSE DR	GOLDEN EAGLE CONSTRUCTION INC	FAWN MEADOW SUBD LT 24 COS #3001911	\$76.61	\$59.42
188805402090000	3922 ED ROSE DR	HAMILN CONSTRUCTION & DEVELOPMENT CO	FAWN MEADOW SUBD LT 22 COS 3001911	\$76.61	\$59.42
188805402110000	3946 ED ROSE DR	HORTON JOHN H JR & VICKI A (JT/ROS)	FAWN MEADOW SUBD LT 20, COS #3001911,	\$76.61	\$59.42
188805402130000	3965 FAWN MEADOW DR	LUNDSTROM KEVIN D & STEPHANIE LARSON-	FAWN MEADOW SUBD LT 12 COS #3001911	\$76.61	\$59.42
188805402150000	3953 FAWN MEADOW DR	SCHLAUCH STEVEN A & TERESA A	FAWN MEADOW SUBD LT 10 COS #3001911	\$76.61	\$59.42
188805402170000	3949 FAWN MEADOW DR	PALMER ROBERT B	FAWN MEADOW SUBD LT 8, COS #3001911,	\$76.61	\$59.42
188805402190000	3937 FAWN MEADOW DR	TRENARY GREG & LYNN	FAWN MEADOW SUBD LT 6 COS # 3001911	\$76.61	\$59.42
188805402210000	3925 FAWN MEADOW DR	BUTLER PETER & BRIDGET E (JT)	FAWN MEADOW SUBD LT 4 COS #3001911	\$76.61	\$59.42
188805402230000	3917 FAWN MEADOW DR	MOONEY MICHAEL P & JENNIFER G (JT)	FAWN MEADOW SUBD LT 2 COS #3001911	\$76.61	\$59.42
188805403010000	3905 ED ROSE DR	URBAN ERIC & SARAH	FAWN MEADOW SUBD LT 25 COS #3001911	\$76.61	\$59.42
188805403030000	3923 ED ROSE DR	SHELTON CARY L & JULIANNE J	FAWN MEADOW SUBD LT 23 COS #3001911	\$76.61	\$59.42
188805403050000	3947 ED ROSE DR	MCBURNETT MATT & JASEY	FAWN MEADOW SUBD LT 21 COS #3001911	\$76.61	\$59.42
188805403070000	3995 ED ROSE DR	HERRERA RONALD L & NINA S (JT/ROS)	FAWN MEADOW SUBD LT 19, COS #3001911,	\$76.61	\$59.42
188805403090000	3977 FAWN MEADOW DR	TAPPE STEPHEN M & APRIL D	FAWN MEADOW SUBD LT 14 COS #3001911	\$76.61	\$59.42
188805403110000	3989 FAWN MEADOW DR	HULL THEODORE J & MICHELLE M	FAWN MEADOW SUBD LT 16 COS #3001911	\$76.61	\$59.42
188805403150000	3992 FAWN MEADOW DR	SMITH CHARLES A & SHANNON R (JT)	FAWN MEADOW SUBD LT 18 COS #3001911	\$76.61	\$59.42
188805403170000	3988 FAWN MEADOW DR	BRAY KENNETH J & VONNI R	FAWN MEADOW SUBD LT 17 COS 3001911	\$76.61	\$59.42
188805403190000	3976 FAWN MEADOW DR	SIMKINS DAVE L & COLLEEN D (JT/ROS)	FAWN MEADOW SUBD LT 15, COS #3001911,	\$76.61	\$59.42
188805403210000	3964 FAWN MEADOW DR	RHINE DENNIS L & GERALDINE R	FAWN MEADOW SUBD LT 13 COS #3001911	\$76.61	\$59.42
188805403230000	3952 FAWN MEADOW DR	GALLAGHER W A & JENNIFER	FAWN MEADOW SUBD LT 11 COS #3001911	\$76.61	\$59.42
188805403250000	3948 FAWN MEADOW DR	LIEBERG DANIEL L & JANET G	FAWN MEADOW SUBD LT 9 COS #3001911	\$76.61	\$59.42
188805403270000	3936 FAWN MEADOW DR	GALLAGHER W A & JENNIFER	FAWN MEADOW SUBD LT 7 COS #3001911	\$76.61	\$59.42
188805403290000	3924 FAWN MEADOW DR	CATES DENNIS P & KATHI A	FAWN MEADOW SUBD LT 5 COS #3001911	\$76.61	\$59.42
188805403310000	3912 FAWN MEADOW DR	JANICEK ROBERT J & DIANA K	FAWN MEADOW SUBD LT 3 COS #3001911	\$76.61	\$59.42
188805403330000	3900 FAWN MEADOW DR	LINDLEY RUSSELL E	FAWN MEADOW SUBD LT 1 COS #3001911	\$76.61	\$59.42

File: FawnMeadowOnlyRID.xls

\$2,145.21

\$1,663.67

3063483
 Page: 4 of 4
 04/30/2004 01:25P
 Lewis & Clark County Bk-M30 Pg-8013