

RESOLUTION 1996 - 67

**A RESOLUTION TO AMEND THE BOUNDARY OF RID NO. 94-2
EAGLE RIDGE ROAD**

WHEREAS, Rural Improvement District No. 94-2 was established by the Board of County Commissioners pursuant to Resolution No. 1994-116, for the purpose of funding road maintenance activities for Eagle Ridge Road; and

WHEREAS, the boundaries of said District included several contiguous tracts in single ownership (Rice), identified as Parcels 10873, 10874, and 11093 on Exhibit "A" of Resolution No. 1994-116, which were accessed from Eagle Ridge Road; and

WHEREAS, Parcel 10873 has been transferred to a separate owner and a new access from Sunset Road has been developed to serve the property; and

WHEREAS, the new landowner (Douglas Williams) has requested that the Board of County Commissioners remove Parcel 10873 from RID No. 94-2 because it no longer benefits from the road maintenance activities associated with Eagle Ridge Road.

NOW, THEREFORE, BE IT RESOLVED by the Lewis and Clark County Board of County Commissioners that Parcel 10873 (also identified as GEOCODE 1994-30-1-01-26-0000) no longer benefits from the road maintenance activities associated with Eagle Ridge Road and should be removed from the assessment list for the District.

BE IT FURTHER RESOLVED that the boundary of RID No. 94-2, as amended by this resolution, is shown on Exhibit "A", attached hereto and made a part hereof.

DATED this 23rd day of July, 1996.

BOARD OF COUNTY COMMISSIONERS
LEWIS AND CLARK COUNTY

Michael J. Griffith, Chairman

ATTEST:

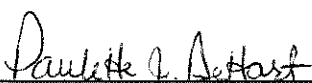

Paulette J. DeHart, Clerk of Board

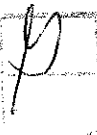
File: 2716 EagleRID.amd

INDEXED 

BOOK 148 PAGE 2529
No fee
95 JUL 24 PM 12:45
PAULETTE DEHART CLK & REC
LEWIS & CLARK CO
HELENA, MT
550549

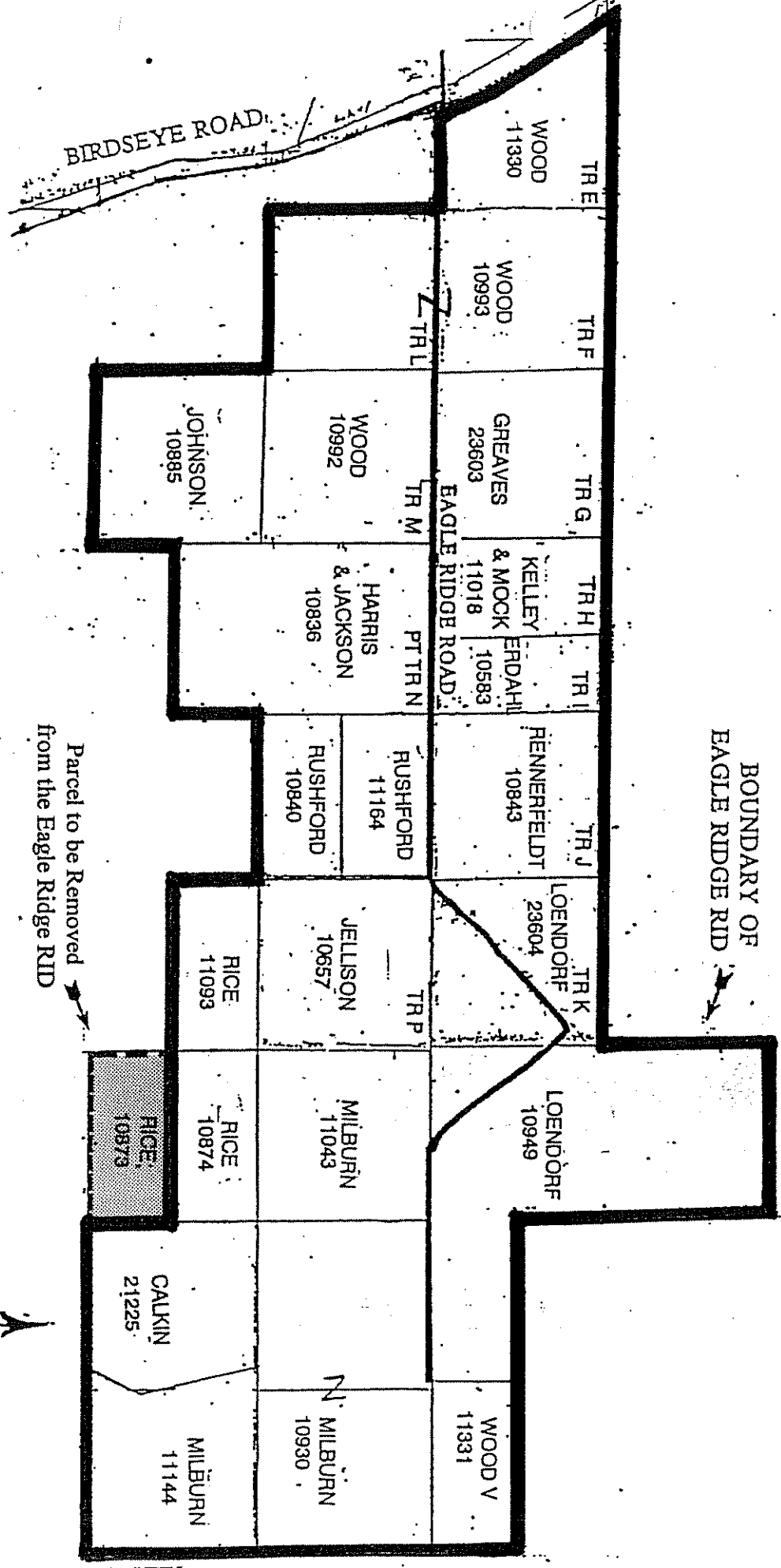
EXHIBIT "A"



Parcel to be Removed from the Eagle Ridge RID

BOUNDARY OF EAGLE RIDGE RID

BIRDSEYE ROAD

TR L

TR M

PT TR N

RUSHFORD 11164

TR P

MILBURN 11043

N MILBURN 10930

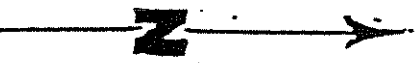

JUN 01 1996

BY _____ MM
FILE _____

405 1/2 Madison Ave.
Helena, Montana 59601
May 29, 1996

*Raz -
Talk to me on this
please M*

Mr. Mike Murray, Chairman
Lewis & Clark County Commission
Helena, Montana 59624

Mr. Murray:

I have recently purchased a piece of unimproved property and am writing to you regarding a RID that it will be taxed on. I would like to apply to have the property removed from the Eagle Ridge Rural Improvement District which is administered by the county for road maintenance and such.

The reason why I would like to be removed from the tax rolls on this piece of property is that I have no access, legal or otherwise, to any part of the said property from Eagle Ridge Road. The only available access is from Sunset Road off of Birdeye, roughly about a mile closer to town.

The reason why the property is still on Eagle Ridge Road's RID is that Kent and Bernadette Rice had approximately 15 acres which they later subdivided when they decided to sell and build near Canyon Ferry. They elected to do nothing about the 5 acre land parcels tax status, as far as RID's were concerned, and left that to the buyer of said properties. That is why I am writing now to try to effect this change. I purchased this 5 acre parcel on May 24, 1996.

Here are the many descriptions of my property:

5780 Sunset Road
10873 on Exhibit "A" map
S2SEWNNE 30-11-4W
GEO code : 1994-30-1-01-26-0000

Enclosed you will find a map of the property. I hope that this is adequate to get this process started, so that I can get this land removed from the Eagle Ridge RID tax. If not, please write or call and let me know what else might be needed. My phone number is 449-6751. Thank you for your time and consideration in this matter.

Sincerely yours,

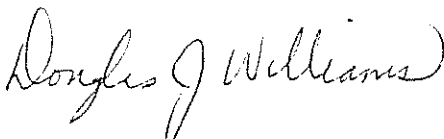

Douglas J. Williams