

RECEIVED  
MAY 08 1992 *Rozz*

RESOLUTION 1992 - 51  
LEWIS & CLARK COUNTY  
PLANNING DEPARTMENT

A RESOLUTION OF INTENTION TO CREATE A RURAL IMPROVEMENT DISTRICT  
FOR ROAD IMPROVEMENTS AND ROAD MAINTENANCE  
FOR COLORADO GULCH ROAD

WHEREAS, a petition has been received from the landowners in the area served by Colorado Gulch Road requesting that the Board of County Commissioners create a Rural Improvement District for the purpose of funding road improvements and on-going maintenance of the road; and

WHEREAS, the petition included a map of the road to be improved and the benefitting properties, a description and cost estimates for the proposed improvements and maintenance, and was signed by 48.7% of the affected property owners; and

WHEREAS, the Board of County Commissioners has the authority to propose Rural Improvement Districts for the purpose of funding road improvements and/or maintenance, pursuant to Section 7-12-2101, et. seq., MCA.

NOW, THEREFORE, BE IT RESOLVED by the Lewis and Clark County Board of County Commissioners that it does hereby establish its intention to create Rural Improvement District No. 92-1 for the purpose of funding road improvements and road maintenance within said district.

BE IT FURTHER RESOLVED that said district will include all lands located within the W 1/2 and the W 1/2, E 1/2 of Section 6 and all of Section 7, T9N, R4W; the E 1/2 and the E 1/2, SW 1/4 of Section 1, the NE 1/4 and the S 1/2 of Section 12, and all of Section 13, T9N, R5W; and a portion of the S 1/2 of Section 31, T10N, R4W, P.M.M. of Lewis and Clark County; the benefitting lands are identified on Exhibit A, attached hereto and made a part hereof.

BE IT FURTHER RESOLVED that the improvements will consist of grading, sloping, and compacting the existing road surface, providing drainage, making certain safety improvements, and installing two layers of chip seal (3/4 inch per layer) for a finished top width of approximately 20 to 22 feet, extending approximately three miles south of U.S. Highway 12.

BE IT FURTHER RESOLVED that the maintenance shall include crack sealing, resurfacing, and other maintenance and repair as necessary to preserve the road surfaces, and that such maintenance shall be administered by the County Road Foreman, unless the Board enters into a contractual agreement with a representative body of landowners in the Colorado Gulch Rural Improvement District.

BE IT FURTHER RESOLVED that assessments for the improvements and subsequent maintenance of the improvement shall be assessed upon each lot within the district. It is proposed that developed lots would be assessed for 80% of the costs and undeveloped lots would be assessed for 20% of the costs. Such assessments will be based upon the assessed valuation of land, improvements, and personal property valuations to distinguish developed and undeveloped lots. Then thresholds and limits of assessed valuation will be applied resulting in a flat fee assessment for developed lots and another flat fee assessment for undeveloped lots. Estimated costs of improvements are \$149,807; estimated annual costs for improvements (including interest and administration) are \$28,190 for a period of seven years. Estimated

costs of maintenance at the end of seven years are \$60,984; estimated annual costs for maintenance (including interest and administration) are \$15,050 for a period of seven additional years. Estimated annual maintenance costs are \$8,712 for subsequent years.

Based upon the assessment method described, individual lot assessments (approximate) would be as follows:

Term	Developed Lot		Undeveloped Lot	
	Annually	Monthly	Annually	Monthly
Years 1 through 7	\$256.32	\$21.36	\$131.16	\$10.93
Years 8 through 14	\$216.00	\$18.00	\$110.52	\$ 9.21
Subsequent years	\$ 79.20	\$ 6.60	\$ 40.56	\$ 3.38

All funds collected for the district shall be spent solely for the road improvement and maintenance activities within the proposed district.

DATED this 25th day of April, 1992

BOARD OF COUNTY COMMISSIONERS  
LEWIS AND CLARK COUNTY

Blake J. Wordal  
Blake J. Wordal, Chairman

Linda Stoll-Anderson  
Linda Stoll-Anderson

David E. Fuller  
David E. Fuller

ATTEST:

Kim Harris  
Kim Harris, Clerk of Board

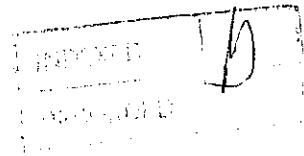

484852

CLERK  
LEWIS & CLARK CO., MONT.

1992 MAY -1 AM 11:25

EXHIBIT "A"

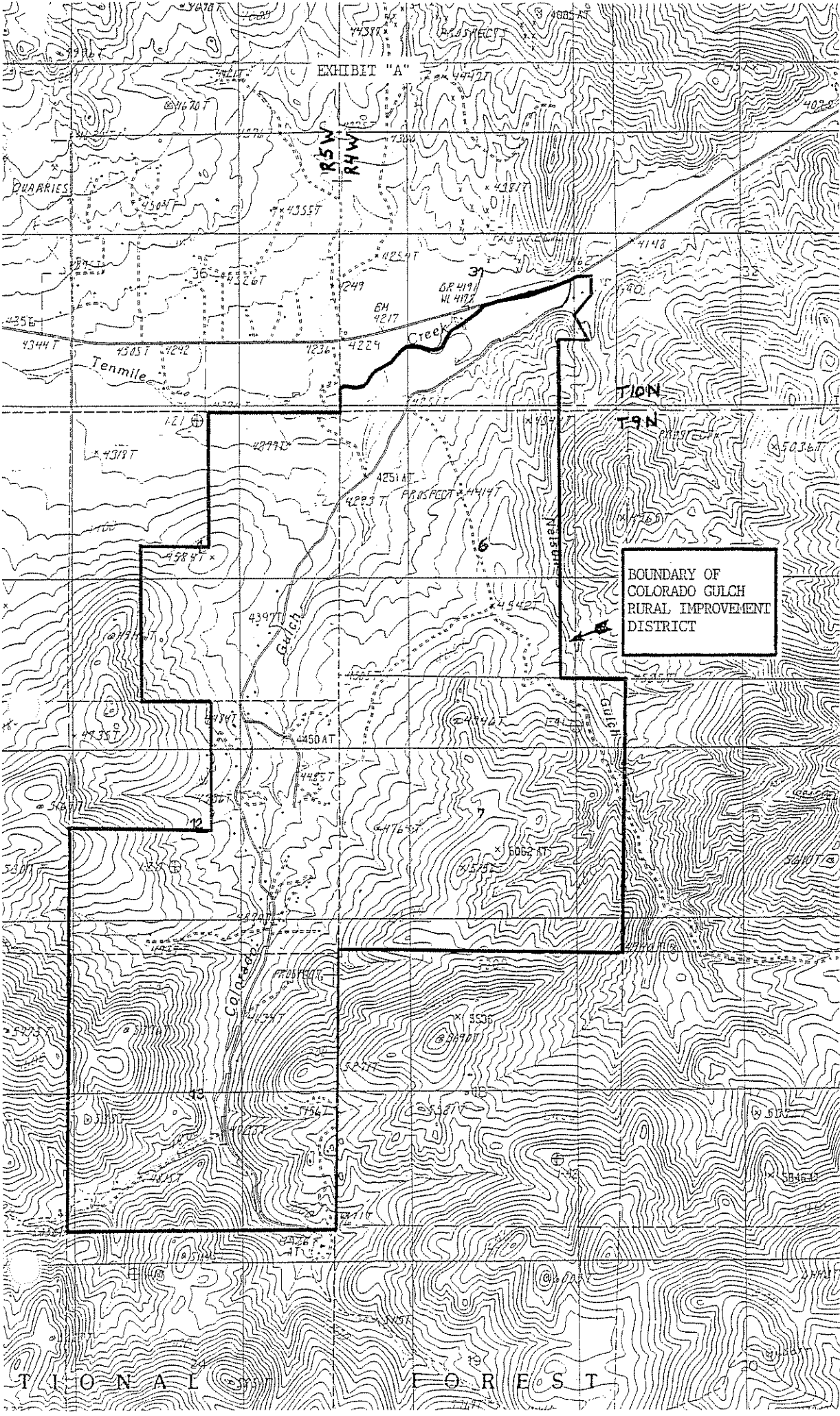

BOUNDARY OF  
COLORADO GULCH  
RURAL IMPROVEMENT  
DISTRICT

