

A RESOLUTION OF INTENTION TO CREATE A RURAL IMPROVEMENT DISTRICT FOR BROADWATER ESTATES SUBDIVISION

WHEREAS, a request has been received from the developer of the Broadwater Estates Subdivision, requesting that the Board of County Commissioners create a Rural Improvement District for the purpose of maintaining the roads in the Broadwater Estates Major Subdivision, located in portions of Sections 21 and 28, T10N, R4W, P.M.M., Lewis and Clark County, as shown on the attached Exhibit "A"; and

WHEREAS, the Board of County Commissioners has the authority to propose Rural Improvement Districts for the purpose of funding road improvements and/or maintenance, pursuant to Section 7-12-2101, et. seq., MCA.

NOW, THEREFORE, BE IT RESOLVED by the Lewis and Clark County Board of County Commissioners that it does hereby establish its intention to create the Broadwater Estates Rural Improvement District No. 2004-4, for the purpose of maintaining the roads in the Broadwater Estates Major Subdivision, Lewis and Clark County, as shown on the attached Exhibit "A".

BE IT FURTHER RESOLVED that said maintenance district will include those parcels of land abutting and/or accessing the roads shown on Exhibit "A" and listed on Exhibit "B", attached hereto and made a part hereof. All lots within the district would benefit equally and would be assessed a flat fee for the maintenance.

BE IT FURTHER RESOLVED that the engineer for the improvements is Stahly Engineering and Associates.

BE IT FURTHER RESOLVED that the Broadwater Estates Major Subdivision has received preliminary plat approval and the maintenance district is required as part of that approval.

BE IT FURTHER RESOLVED that the proposed maintenance activities could include a contribution to a reserve account for future surface treatment (e.g. chipseal), snow plowing, sanding, sweeping, weed control, drainage control, street identification and traffic control signing, and other maintenance and repair as necessary to preserve the road surfaces, and that such maintenance shall be administered by the County. The County will serve only to coordinate the necessary work, collect the assessments, and disburse payments for the district; it is anticipated that the maintenance would be performed by a private contractor.

BE IT FURTHER RESOLVED that the estimated annual costs for said maintenance are \$6,850.84. Each lot shall benefit equally and shall be assessed a flat fee of approximately \$97.87 per lot annually for said maintenance. All funds collected for the maintenance district shall be spent solely for the road maintenance activities within the proposed district.

BE IT FURTHER RESOLVED that the district will be created but a rate hearing will not be held until after final plat approval.



BE IT FURTHER RESOLVED that the district shall remain in effect in perpetuity or until such action by the Board of County Commissioners otherwise dissolves the district.

BE IT FURTHER RESOLVED that any owner of property within the proposed district may make protest against the creation of the districts, pursuant to Section 7-12-2109, MCA.

DATED this 29 day of June, 2004.

BOARD OF COUNTY COMMISSIONERS
LEWIS AND CLARK COUNTY

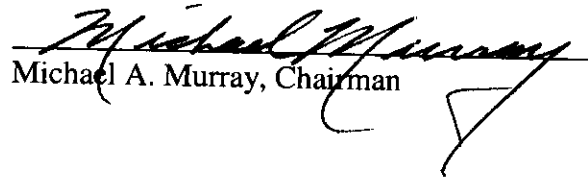
Michael A. Murray, Chairman

ATTEST:

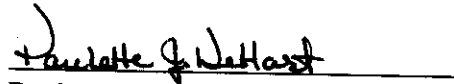
Paulette J. DeHart, Clerk of Board

Attachments: Exhibit "A"
Exhibit "B"

File: BroadwaterEstRIDIntentRes



3067157
Page: 2 of 4
07/02/2004 10:44A
Bk-M30 Pg-9498

Lewis & Clark County

COUNTY

EXHIBIT "A"

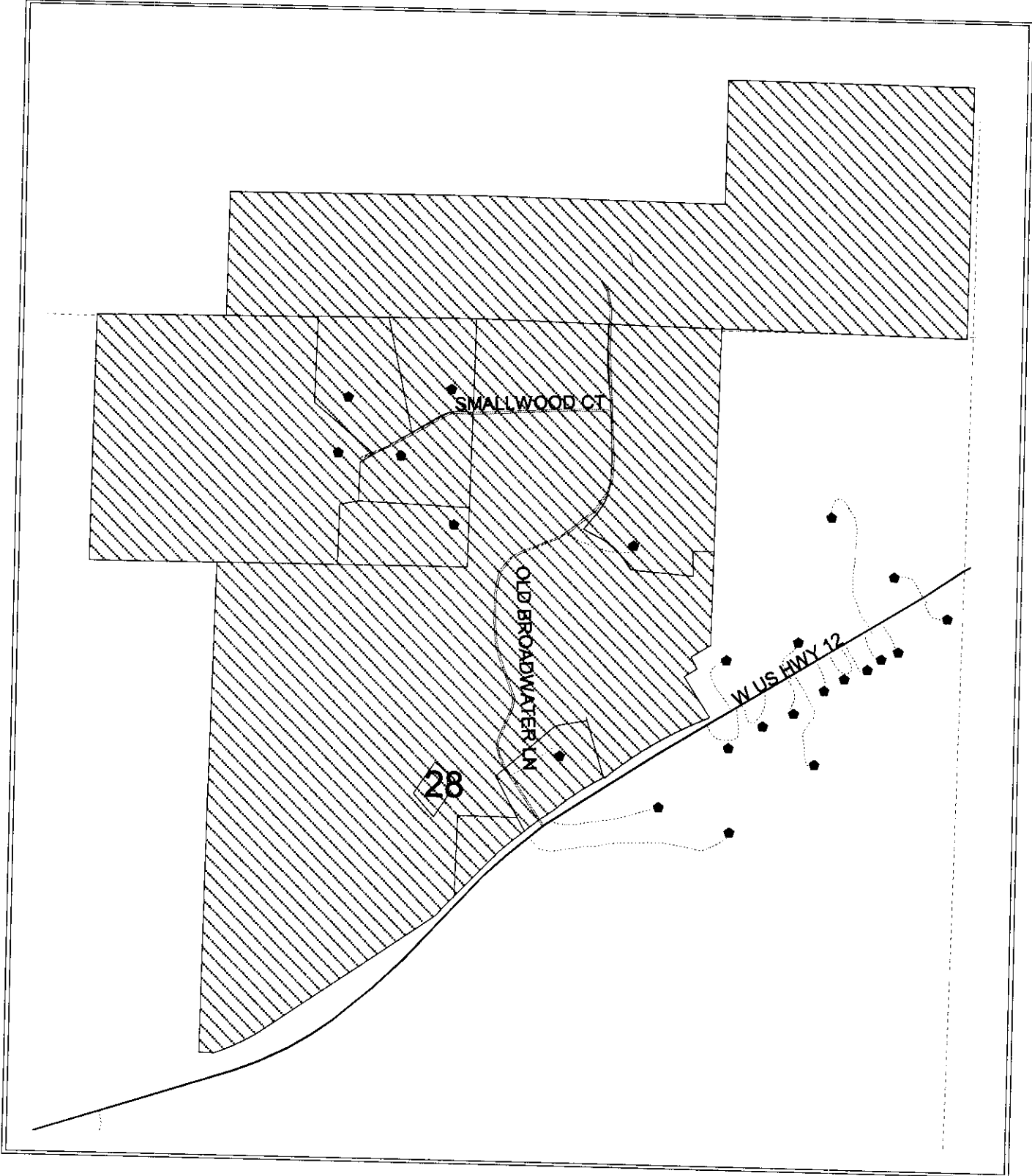

- Address-points.shp
- Gpsroad-cl.shp
- D
- P
- U
- ▨ Proposed Broadwater Estates RID
- Section Number
- Section Line



Lewis & Clark County

COUNTY

3067157
 Page: 3 of 4
 07/02/2004 10:44A
 Bk-M30 Pg-9498

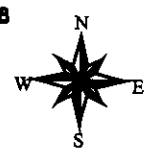

BROADWATER ESTATES RID

GEOCODE	PROPERTY LOCATION	PROPERTY OWNER	LEGAL DESCRIPTION	PROPOSED ASSESSMENT
188721301010000	0 UNKNOWN	WAGNER MICHAEL A & GAYLYNN	S2SESW S2SWSE SESE 80.00 AC	\$97.87
188728102010000	4920 WUS HWY 12	BROADWATER ATHLETIC CLUB	PT SWNE PARC A COS #526873/T 4.40 AC	\$97.87
188728102150000	4930 WUS HWY 12	GRUBER FRANK D & BONITA M	** W2SWNE	\$5,872.15
188728102200000	4930 WUS HWY 12	HITZERTH ROBERT W & DONNA	PT NE 4	\$97.87
188728202010000	0 UNKNOWN	WILLIAMS JAMES W	IN SESENW PARC B COS #526873/T .78 AC	\$97.87
188728202050000	5005 SMALLWOOD CT	LITTLE ROBERT A & MCATEE SHIRLEY A	SUMMERSTONE MINOR SUBD LT D1-B	\$97.87
188728202100000	5000 SMALLWOOD CT	STROM ORLAN T & TRINA J	SUMMERSTONE MINOR SUBD LT D1-E	\$97.87
188728202200000	5030 SMALLWOOD CT	DALY JAMES JOSEPH & SUSAN W (JT/ROS)	SUMMERSTONE MINOR SUBD LT D1-D	\$97.87
188728202300000	5040 SMALLWOOD CT	MARSHIK JOEL M & PHYLLIS D	SUMMERSTONE MINOR SUBD LT D1-C	\$97.87
188728202400000	5045 SMALLWOOD CT	DHANE WALTER G & MARY E	SUMMERSTONE MINOR SUBD LT D1-A	\$97.87
188728401150000	0 UNKNOWN	GRUBER FRANK D & BONITA M	TR IN NWNWSE	\$97.87

File: BroadwaterEstRID.xls \$6,850.84

** To be divided into 60 lots per Broadwater Estates Major Subdivision

EXHIBIT "B"

3067157
 Page: 4 of 4
 07/02/2004 10:44A
 COUNTY Bk-M30 Pg-9498

Lewis & Clark County