

RESOLUTION 2023 - 17

A RESOLUTION TO DECLARE VALLEY DRIVE A COUNTY ROAD

WHEREAS, the Board of County Commissions has the authority to approve the Resolution declaring Valley Drive a County Road pursuant to 7-14-2101(4)(b)(i), MCA; and

WHEREAS, Valley Drive was petitioned and surveyed and declared a public highway on November 5, 1909, by the Board of County Commissioners.

WHEREAS, the County received a request from the staff of Lewis and Clark County to make Valley Drive a County Road.

NOW, THEREFORE, BE IT RESOLVED by the Board of County Commissioners hereby declare Valley Drive a County Road, as depicted on attached Exhibits A and B, and as kept in the official records of Lewis and Clark County.

DATED this 23RD day of March, 2023.



LEWIS AND CLARK COUNTY
BOARD OF COMMISSIONERS

A handwritten signature in blue ink that reads "Tom Rolfe".

Tom Rolfe, Chair

Attest:

A handwritten signature in blue ink that reads "Amy Reeves".

Amy Reeves, Clerk of the Board

Attachment: Exhibit A
Exhibit B



The Board met pursuant to adjournment.

There were present.

Jos. J. Hindson, Chairman.

T. Wesley Richardson, Commissioner.

M. F. Root, Commissioner.

Martin Doty, Clerk.

The following bills were examined and allowed.

2133	S. A. Cooney, M. D.	Livery B. of H.	General	12 50
2134	A. E. Shaw	Wood Indigents	Poor	4 50
2135	Prosser & Schaffer	Mdse. Indigents	"	15 00
2136	Helena Electric Co.	Supplies C. H.	General	6 00
2137	A. P. Curtin B. & S. Co.	Supplies C. H.	General	1 50
2138	Union Laundry Co.	Laundry C. H.	"	2 20
2139	Common Bros Co.	Mdse. Indigents	Poor	17 90
2140	J. A. Staffer	Supplies Roads	Bridge	4 00
2141	Frank Gibson	Hauling Trout Creek Bridge	Bridge	24 00
2142	Jos. L. Hughes	Bal on contract	Road	160 00
2143	" " "	" " "	Bridge	225 00

The balance of the morning was spent discussing County affairs.

Adjourned at 12 Noon until 2 P. M.

Reassembled at 2 P. M. Present the same as in the morning.

The following action was taken by the Board in the matter of the change in the County road running North from East Helena. " The within road having been surveyed and the plat and field notes having been filed in the office of the County Clerk & Recorder of Lewis & Clark County, the same is hereby declared a public highway and the Clerk is ordered to record petition, Viewers report plat and field notes in books provided for that purpose November. 5, 1909.

Jos. J. Hindson, Chairman.

The balance of the afternoon was spent discussing County affairs and road matters.

Adjourned at 5 P. M. until Nov 8th 1909 at 10 A. M.

Read and approved this 16th day of Dec 1909

Attest.

Martin Doty
Clerk.

J. J. Hindson

Chairman.



EAST HELENA - VALLEY ROAD

5-28

B-6

EAST HELENA VALLEY ROAD.
MEADOWS ROAD.
Scale 1/4" = 100ft

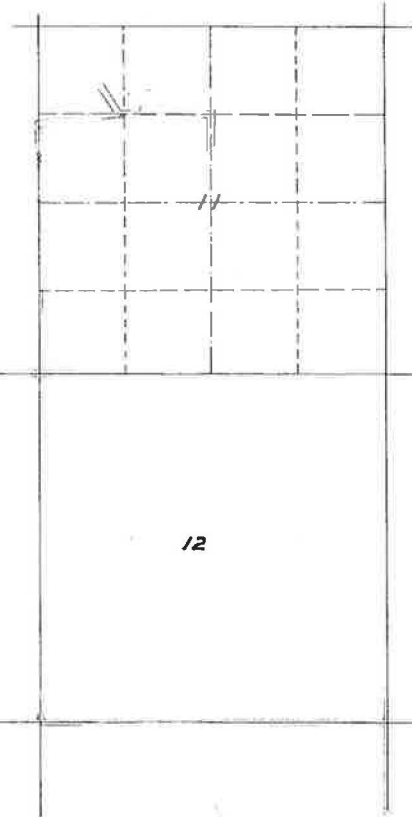

25

24

13

12

1

EAST HELENA



SHEET No 1

