

RESOLUTION 2022 - 19

**RESOLUTION TO CREATE THE LAMBKINS RURAL IMPROVEMENT DISTRICT
FOR IMPROVEMENT NO. 2022-4**

WHEREAS, a resolution of intention to create the Lambkins Rural Improvement District (the District) was adopted by the Lewis and Clark County Board of Commissioners (Commission) on February 24, 2022, as Resolution 2022-14; and

WHEREAS, legal notice of the passage of Resolution 2022-14 was mailed to property owners and persons of interest in property within the District, and published in the local newspaper in accordance with Section 7-12-2105, MCA, and 7-1-2121, MCA; and

WHEREAS, it was determined that there was not sufficient protest to bar proceedings as per Section 7-12-2112, MCA; and

WHEREAS, the designated items set forth in Section 7-12-21-03(2), MCA, are as follows:

- (a) The designated number of the District is 2022-4.
- (b) The benefited properties to be included in the District and the boundary of the District are identified on Exhibit "A".
- (c) The County Engineer or a designee will have charge of the work. The general character of improvements includes asphalt patching and chip sealing on hard surface roads included within the District. The estimated costs for improvements total \$59,396 and will be paid for with a seven (7) year debt service, with \$0.00504/ sq. ft. assessed annually to each benefited property (average of \$83/property). Improvement costs are detailed in Exhibit "B".
- (d) The general character of maintenance includes, but is not limited to crack sealing, pothole patching, and chip sealing to preserve the road surfaces. Each property is estimated to be assessed \$0.001972/sq. ft. (average of \$32), annually.
- (e) Costs shall be assessed equally, as described in Section 7-12-2151(1)(d), MCA.
- (f) Pursuant to Section 7-12-2103(2)(f), MCA, if an increase in the number of benefited lots, tracts, or parcels within the boundaries of the district during the term of bonded indebtedness, the assessment per lot, tract, or parcel then in the district will be recalculated.

NOW, THEREFORE, BE IT RESOLVED that the Commission does hereby create the Lambkins Rural Improvement District No. 2022-4 for the purpose of equitably funding improvements for roadways in the District.

BE IT FURTHER RESOLVED that the Lewis and Clark County Public Works Department is authorized and responsible for coordinating proposed improvements detailed in Exhibit "B" for roadways within the District.

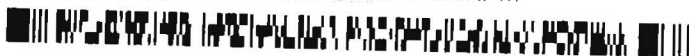

DATED this 1st day of April, 2022.

LEWIS AND CLARK COUNTY
BOARD OF COMMISSIONERS

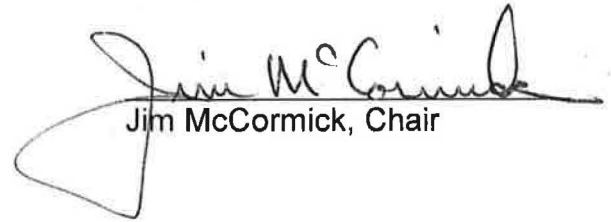
Jim McCormick, Chair





Amy Reeves, Clerk of the Board

Attachments:
Exhibit "A"
Exhibit "B"

Exhibit A

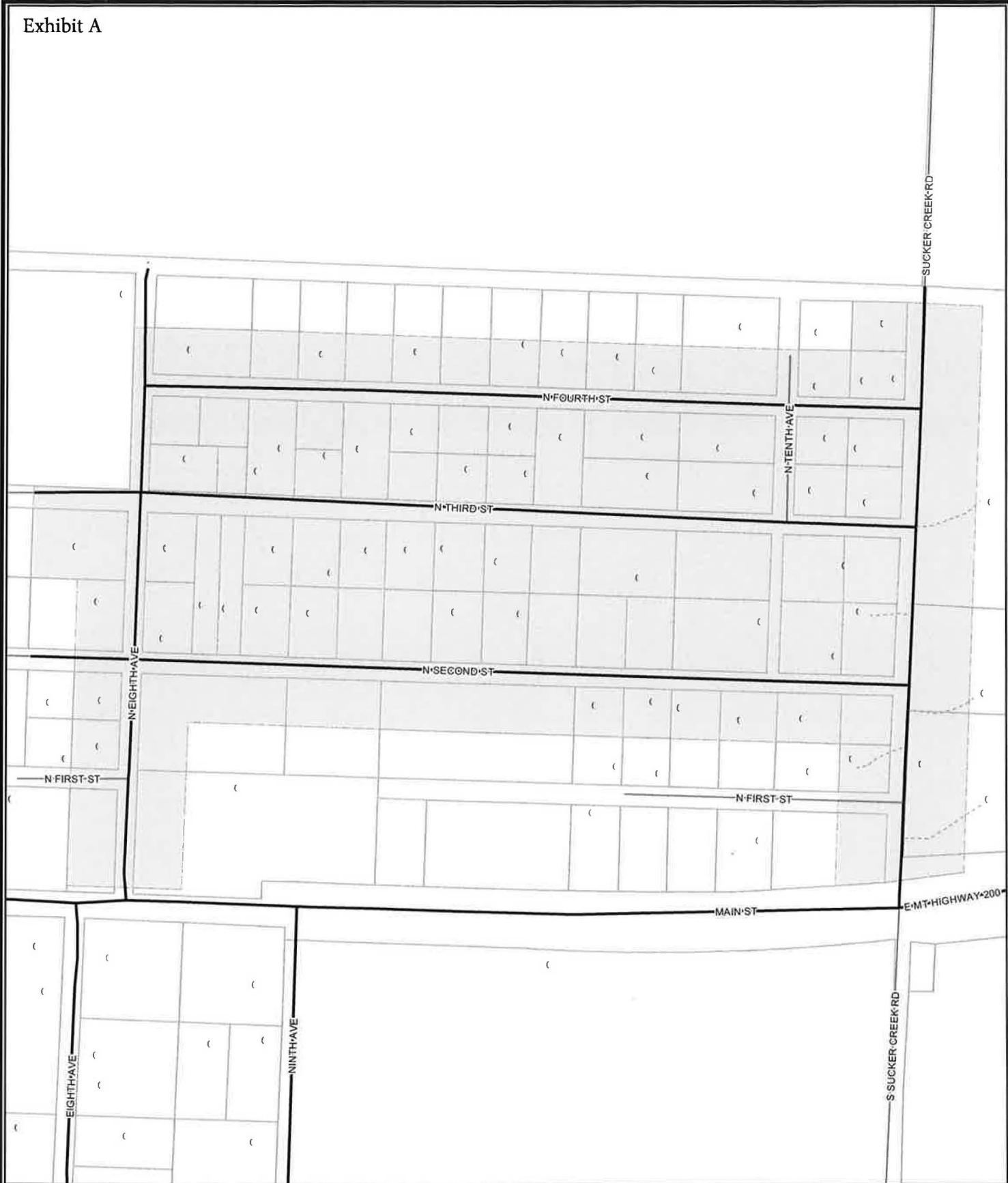

- () Address Points
- +— Railroads
- ROAD SURFACE**
- Alley
- - - Driveway
- ~ Paved
- ~ Unpaved
- Parcel Boundaries

Lewis & Clark County Road Improvement Districts Lambkins Addition RID



Map Document: G:\ArcProjects\RIDs_county_MapSeries\811.mxd
Updated: August 23, 2007



CITY OF HELENA - LEWIS & CLARK COUNTY
GEOGRAPHIC INFORMATION SERVICES
room 147 city-county building
316 N PARK AVE
HELENA, MONTANA 59624
406-447-8389
www.co.lewis-clark.mt.us

Exhibit "B"

LEWIS AND CLARK COUNTY
PUBLIC WORKS DEPARTMENT ESTIMATE

PROJECT: Lambkins RID
PROJECT DESCRIPTION: Chip Seal Improvement
PREPARED BY: Jesse Whitford
DATE: 1/14/2021

Road Name	Description of Limits	Width (ft)	Length (ft)	Area (sq ft)	Volume (sq yd)	Asphalt Patch (ton)	Chip & Seal (sq yd)	Sweeping (sq yd)	Crack Seal (ft)
Hard Surfaced Roads									
8th Street North	Hwy. 200 to North end	21	1,039	21,819	2,424	7	2,424	2,424	0
2nd Street North	8th St. N. to Sucker Cr.	20	1,717	34,340	3,816	11	3,816	3,816	0
3rd Street North	8th St. N. to Sucker Cr.	20	1,824	36,480	4,053	12	4,053	4,053	0
4th Street North	8th St. N. to Sucker Cr.	20	1,597	31,940	3,549	10	3,549	3,549	0
TOTALS			6,177	124,579	13,842	39	13,842	13,842	0

Mobilization, bonding and insurance are included in Chip Seal Unit price.

Item	Total	Unit	Cost/Unit	Total Cost
Asphalt Patch	39	ton	\$ 355.25	\$ 13,854.75
Chip & Seal	13,842	sq yd	\$ 2.75	\$ 38,065.50
Sweeping	13,842	sq yd	\$ 0.15	\$ 2,076.30
Crack Seal	0	ft	\$ 2.03	\$ -
CONSTRUCTION TOTAL				\$ 53,996.55
Contingency			10%	\$ 5,399.66
Subtotal				\$ 59,396.21
Mobilization, Bonding & Insurance			0%	\$ -
Traffic Control			0%	\$ -
Subtotal				\$ 59,396.21
Design & Construction Engineering			0%	\$ -
PROJECT TOTAL				\$59,396.21