

**RESOLUTION 2022 - 16**

**RESOLUTION OF INTENTION TO CREATE THE AUGUSTA RURAL IMPROVEMENT DISTRICT FOR IMPROVEMENT NO. 2022-5**

**WHEREAS**, the Lewis and Clark County Board of Commissioners may order and create a Rural Improvement District (RID) whenever the public interest or convenience may require, Section 7-12-2102, MCA; and

**WHEREAS**, it is the policy of the Board to follow public process for creating an RID when a petition has been received to create an RID; and

**WHEREAS**, a petition for the Augusta Rural Improvement District, No. 2022-5 (the District) was submitted for the purpose of funding improvements on hard surface roads within Augusta; and

**WHEREAS**, the designated items set forth in Section 7-12-21-03(2), MCA, are as follows:

- (a) The designated number of the District is 2022-5.
- (b) The benefited properties to be included in the District and the boundary of the District are identified on Exhibit "A".
- (c) The County Engineer or a designee will have charge of the work. The general character of improvements includes asphalt patching and chip sealing on hard surface roads included within the District. The estimated costs for improvements total \$120,667 and will be paid for with a seven (7) year debt service, with \$18.33 assessed annually to each benefited property. Improvement costs are detailed in Exhibit "B".
- (d) The general character of maintenance includes, but is not limited to, crack sealing, pothole patching, and chip sealing to preserve the road surfaces. Each property is estimated to be assessed \$45.13, annually.
- (e) Costs shall be assessed equally, as described in Section 7-12-2151(1)(d), MCA.
- (f) Pursuant to Section 7-12-2103(2)(f), MCA, if an increase in the number of benefited lots, tracts, or parcels within the boundaries of the district during the term of bonded indebtedness, the assessment per lot, tract, or parcel then in the district will be recalculated.

**NOW, THEREFORE, BE IT RESOLVED** that the Board of County Commissioners does hereby establish its intention to create the Augusta Rural Improvement District No. 2022-5 for the purpose of equitably funding improvements on roadways within the District.

**BE IT FURTHER RESOLVED** that the Lewis and Clark County Public Works Department is authorized and responsible for coordinating proposed improvements for roadways within the District.

**BE IT FURTHER RESOLVED** that written protests will be received from persons owning real property within the proposed district for thirty (30) days after the first publication of notice, and that said protests must contain the printed landowner's name and address as it appears on the last assessment roll.



DATED this 3 day of March, 2022.

LEWIS AND CLARK COUNTY  
BOARD OF COMMISSIONERS

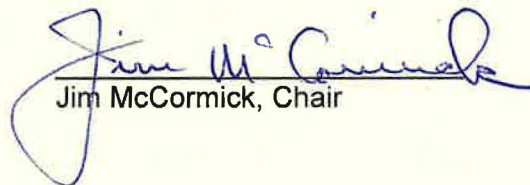
  
Jim McCormick, Chair

ATTEST:

  
\_\_\_\_\_  
Amy Reeves, Clerk of the Board

Attachments:

Exhibit "A"

Exhibit "B"



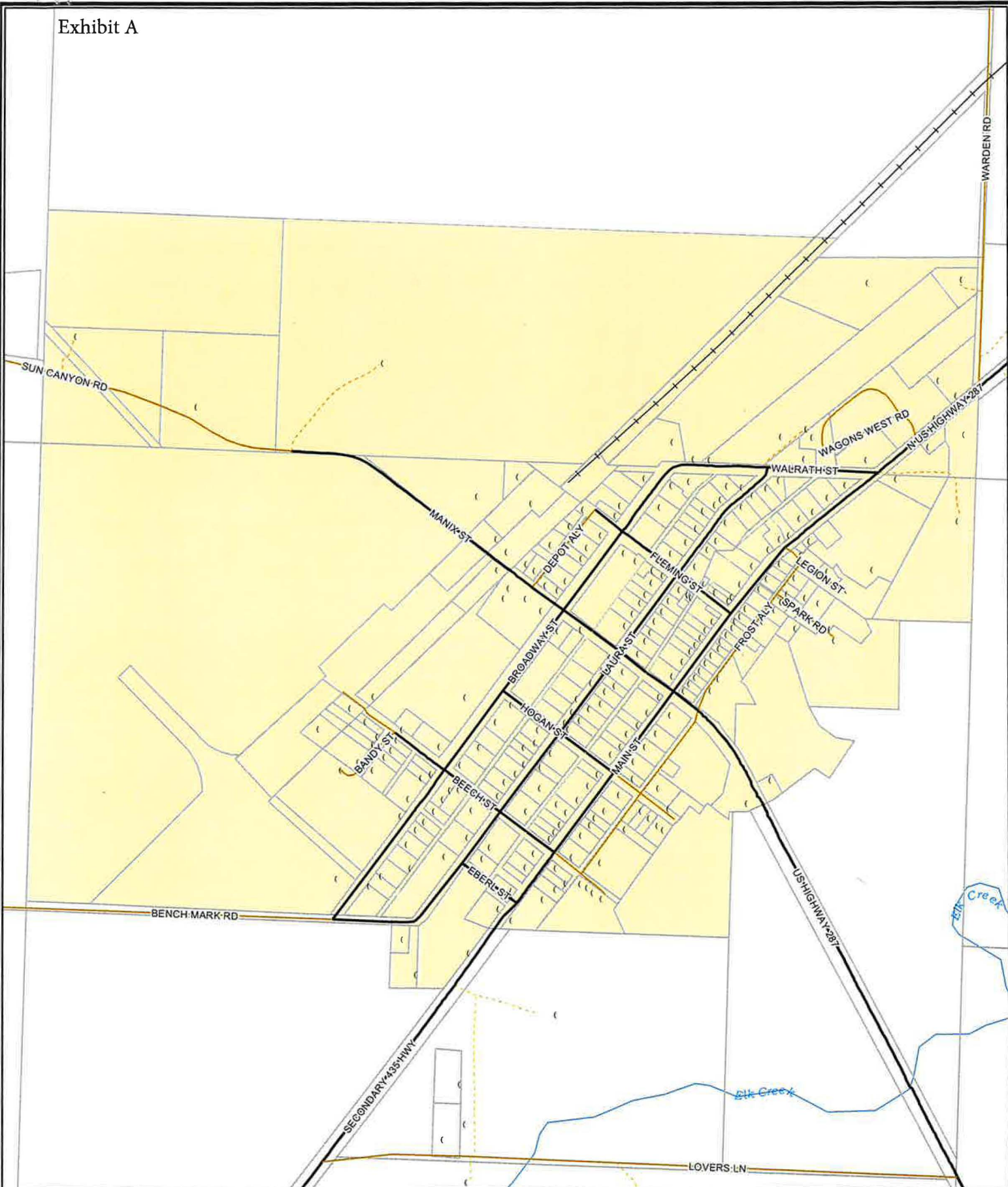

- ( ) Address Points
- Railroads
- ROAD SURFACE**
- Alley
- - - Driveway
- Paved
- Unpaved
- Parcel Boundaries

# Lewis & Clark County Road Improvement Districts

## Augusta RID

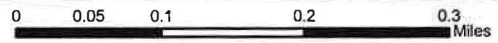

Map Document: G:\ArcProjects\RIDs\_county\_MapGenes&11.mxd  
 Updated: August 23, 2007



**CITY OF HELENA - LEWIS & CLARK COUNTY**  
 GEOGRAPHIC INFORMATION SERVICES  
 room 147 city-county building  
 316 N PARK AVE  
 HELENA, MONTANA 59624  
 406-447-8389  
[www.co.lewis-clark.mt.us](http://www.co.lewis-clark.mt.us)

Exhibit 'B'

**LEWIS AND CLARK COUNTY**  
**PUBLIC WORKS DEPARTMENT ESTIMATE**

**PROJECT:** AUGUSTA RID  
**PROJECT DESCRIPTION:** Chip Seal Improvement  
**PREPARED BY:** Jesse Whitford  
**DATE:** 1/14/2021

Road Name	Description of Limits	Width (ft)	Length (ft)	Area (sq ft)	Volume (sq yd)	Asphalt Patch: 40 Ton/Mile	Chip & Seal (sq yd)	Sweep (sq yd)	Crack Seal (ft)	Cost Per Road
<b>Hard Surfaced Roads</b>										
Walrath/Broadway	Hwy 287 to Benchmark Rd.	24	4,224	101,376	11,264	32	11,264	11,264	760	\$45,609.07
Laura	Walrath to Eberl	22	2,820	62,040	6,893	20	6,893	6,893	48	\$27,212.13
Fleming	Hwy 287 to Depot Alley	23	1,063	24,449	2,717	8	2,717	2,717	48	\$10,826.62
Hogan	Main to Broadway	23	710	16,330	1,814	5	1,814	1,814	0	\$7,042.11
Beech	Main to Bandy	23	1,316	30,268	3,363	10	3,363	3,363	48	\$13,412.39
School	In Front of School	50	250	12,500	1,389	4	1,389	1,389	0	\$5,453.13
										\$0.00
<b>TOTALS</b>			<b>10,383</b>	<b>246,963</b>	<b>27,440</b>	<b>78</b>	<b>27,440</b>	<b>27,440</b>	<b>904</b>	<b>\$109,200.20</b>

Asphalt costs are per ton.  
 Mobilization, bonding and insurance are included in Chip Seal Unit price.  
 Sweeping is paid per sy.

Item	Total	Unit	Cost/Unit	Total Cost
Asphalt Patch		78 tons	\$ 350.00	\$ 27,709.50
Chip & Seal	27,440	sq yd	\$ 2.71	\$ 74,362.40
Sweeping	27,440	sq yd	\$ 0.15	\$ 4,177.74
Crack Seal		904 ft	\$ 2.00	\$ 1,835.12
<b>CONSTRUCTION TOTAL</b>				<b>\$ 109,706.03</b>
Contingency			10%	\$ 10,970.60
Subtotal				\$ 120,676.63
Mobilization, Bonding & Insurance			0%	\$ -
Traffic Control			0%	\$ -
Subtotal				\$ 120,676.63
Design & Construction Engineering			0%	\$ -
<b>PROJECT TOTAL</b>				<b>\$120,676.63</b>