

## RESOLUTION 2015-101

### RESOLUTION TO CREATE THE EMERALD RIDGE RURAL IMPROVEMENT DISTRICT NO. 2015-5

WHEREAS, A Resolution of Intention to Create the Emerald Ridge Rural Improvement District No. 2015-5 (the "District") was adopted by the Board of County Commissioners on June 9, 2015, as resolution 2015-77; and

WHEREAS, legal notice of the passage of Resolution 2015-77 was posted for the proposed district, mailed to property owners in the proposed district, and printed in the local newspaper in accordance with MCA 7-1-2121; and

WHEREAS, on July 23, 2015, the Board of County Commissioners held a public hearing and proceeded to hear all protests, comments, and other matters relating to the proposed district, and determined that the boundaries of the district benefit area and the method of assessment were equitable; and

WHEREAS, owners of property in the proposed district to be assessed for 98.66% of the cost of the proposed program as determined by the method of assessment described Resolution 2015-77 have waived the right to protest the creation of a Rural Improvement District for the purpose of improving and/or maintaining the roads that access the proposed district including related right-of-way, drainage structures, and traffic control signs, as recorded in Bk-M32 Pg-4715, Bk-M29 Pg-8092, and Bk-M28 Pg-9861; and

WHEREAS, it was determined that there was not sufficient protest to bar proceedings as per MCA 7-12-2112; and

NOW, THEREFORE, BE IT RESOLVED by the Lewis and Clark County Board of Commissioners that it does hereby create the Emerald Ridge Rural Improvement District No. 2015-5 for the purpose of equitably funding road maintenance and improvements.

BE IT FURTHER RESOLVED that the said District will include those parcels of land abutting and/or accessing the roads shown on Exhibit "A".

BE IT FURTHER RESOLVED that the maintenance activities include, but are not limited to:

1. Street sweeping;
2. Culvert cleaning;
3. Monetary contributions toward a future chip seal;
4. Crack seal;
5. Miscellaneous work as necessary to preserve roadways.



BE IT FURTHER RESOLVED that the estimated cost for said maintenance is \$4,370.94 per year, as shown on Exhibit "B". Each lot shall benefit equally and shall be assessed a flat fee of approximately \$58.28 per parcel per year. All maintenance funds collected for the district will be spent solely on road maintenance within the proposed district.

BE IT FURTHER RESOLVED that the Lewis and Clark County Department of Public Works is authorized and responsible for coordinating improvements and maintenance as described on Exhibit "B" for roadways within the district as shown on Exhibit "A".

BE IT FURTHER RESOLVED that the improvements include, but are not limited to:

1. Chip seal;
2. Crack seal.

BE IT FURTHER RESOLVED that the estimated cost for said improvements is \$95,000.76, to be funded by a debt service assessment of \$180.95 per parcel per year levied for a period of seven (7) years, as shown on Exhibit "B". All improvement funds collected for the district will be spent solely on road improvements within the district.

BE IT FURTHER RESOLVED that the District shall remain in effect in perpetuity or until such action by the Board of County Commissioners otherwise dissolves the district.

NOW, THEREFORE LET IT BE RESOLVED, by the Lewis and Clark County Board of County Commissioners that it does hereby approve the creation of the Emerald Ridge Rural Improvement District No. 2015-5.

DATED this 23 day of July, 2015.

LEWIS AND CLARK COUNTY  
BOARD OF COMMISSIONERS

  
Andy Hunthausen, Chairman

ATTEST:

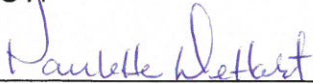
  
\_\_\_\_\_

Paulette J. DeHart, Clerk of Board



Attachments: Exhibit "A"  
Exhibit "B"

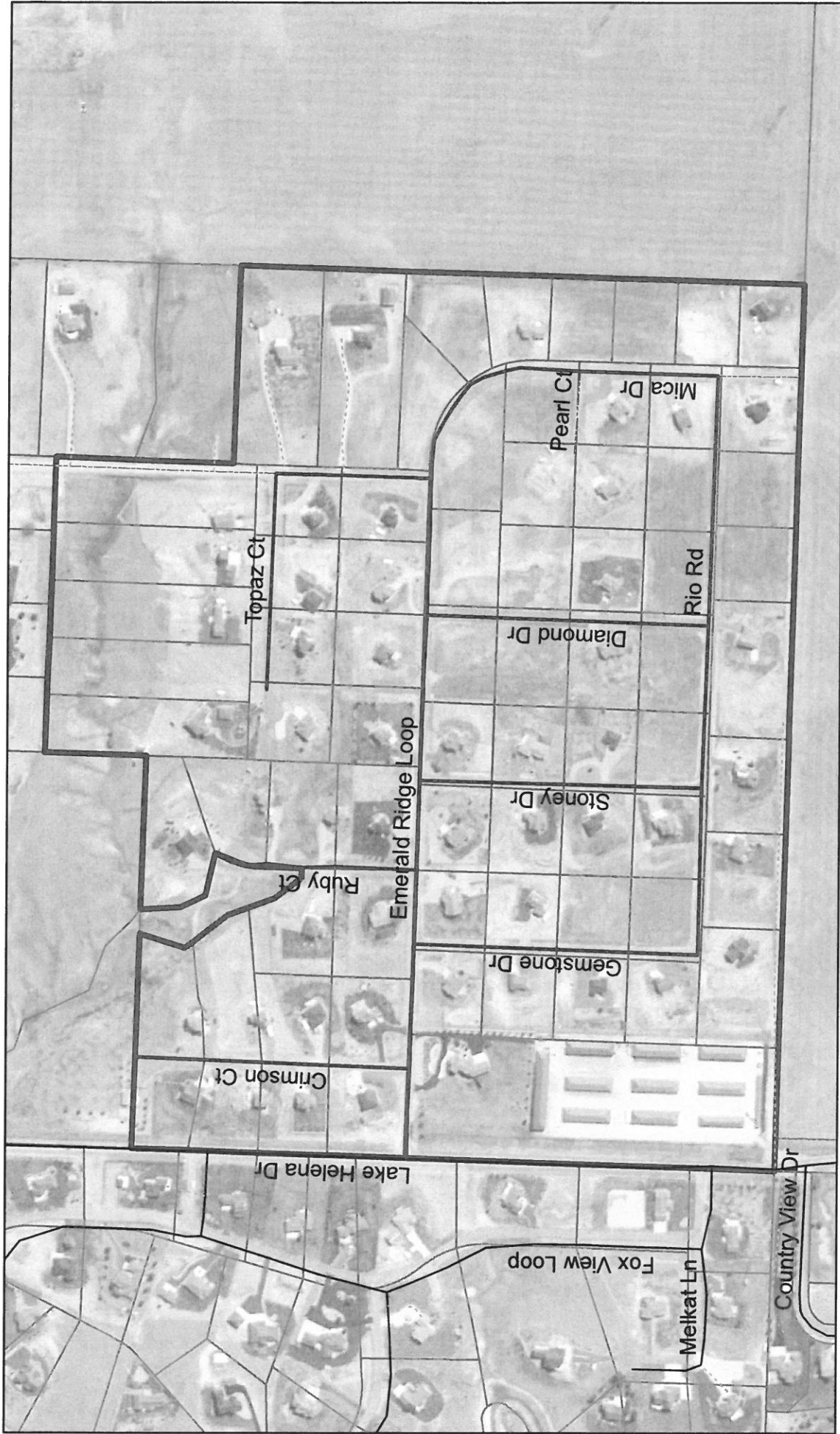

**Exhibit "A": Emerald Ridge Rural Improvement District Map**



**Legend**

-  Roads Within Scope of Service
-  RID Boundary
-  Parcel Boundaries

Lewis & Clark County  
 Community Development and Planning  
 316 N Park Ave  
 Helena, Montana 59623  
 406-447-8375

**Exhibit "B": Emerald Ridge Rural Improvement District Cost Estimate**

Construction		\$69,067.60
Construction Contingency (10%)		6,906.76
		<u>75,974.36</u>
Mobilization, Insurance & Bonding (8%)		\$0.00
Traffic Control (4%)		\$0.00
		<u>75,974.36</u>
Design & Construction Engineering (18%)		0.00
<b>Total Estimated Construction Cost</b>		<b><u>\$75,974.36</u></b>
RID Reserve (5%) MCA 7-12-2181 & 7-12-2182		3,998.65
<b>Total Estimated Loan Amount</b>		<b><u>\$79,973.01</u></b>

Value of Loan	\$79,973.01		
<b>Period (years)</b>	<b>7</b>	Total Int	\$15,027.75
Payments per Period	1	Total Princ	<u>\$79,973.01</u>
Interest Rate (7-12-2176)	4.50%	Total	<u>\$95,000.76</u>
Number of Assessments	75		

**ANNUAL ESTIMATED IMPROVEMENT ASSESSMENT** **\$180.95**

Payment Number	Interest Payment	Principal Payment	Total Payment	Amount Remaining
				79,973.01
1	3,598.79	9,972.75	13,571.54	70,000.26
2	3,150.01	10,421.53	13,571.54	59,578.73
3	2,681.04	10,890.49	13,571.54	48,688.24
4	2,190.97	11,380.57	13,571.54	37,307.67
5	1,678.85	11,892.69	13,571.54	25,414.98
6	1,143.67	12,427.86	13,571.54	12,987.12
7	584.42	12,987.12	13,571.54	0.00
8	0.00	0.00	0.00	0.00
9	0.00	0.00	0.00	0.00
10	0.00	0.00	0.00	0.00
11	0.00	0.00	0.00	0.00
12	0.00	0.00	0.00	0.00
13	0.00	0.00	0.00	0.00
14	0.00	0.00	0.00	0.00
15	0.00	0.00	0.00	0.00
<b>Total</b>	<b><u>\$15,027.75</u></b>	<b><u>\$79,973.01</u></b>	<b><u>\$95,000.76</u></b>	