

RESOLUTION 2019-24

A RESOLUTION OF THE BOARD OF COUNTY COMMISSIONERS OF LEWIS AND CLARK COUNTY, MONTANA FOR A PUBLIC HEARING TO LEVY AND ASSESS THE 4X4 RURAL IMPROVEMENT DISTRICT NO. 2018-01

WHEREAS, the Lewis and Clark County Board of Commissioners (Commission) are authorized to levy and assess a tax upon all benefited property owners in a Rural Improvement District through a Resolution to Levy and Assess, whenever the public interest or convenience may require, Section 7-12- 2158, MCA; and

WHEREAS, on January 22, 2019, the Board of County Commissioners created the 4x4 Rural Improvement District (District), through Resolution 2019-14, for the purposes of soil stabilization and dust control of the 4x4 Road, as requested by the petitioners; and

WHEREAS, the properties within the 4x4 Rural Improvement District (listed in Exhibit "C") are benefitted properties and their benefit is proportional to the fee to be assessed; and

WHEREAS, this resolution provides an equitable method for assessing benefitted properties in the District based upon the benefits received per 7-12-2151(d), MCA; and

WHEREAS, the designated items set forth in Section 7-12-2103(2), MCA are as follows; The designated number of the 4x4 Rural Improvement District is 2018-01; and

- (a) The roads proposed to be improved and maintained within the boundary of the District are shown on Exhibit "A"; and
- (b) The general character of improvements includes, but is not limited to, soil stabilization and dust control of the 4x4 Road, as detailed by Exhibit "B"; and
- (c) The estimated annual cost of maintenance is \$9,021.60, or \$74.56 per benefitted property, per year, as detailed by Exhibit "B"; and
- (d) The County Engineer or a designee is the engineer to have charge of the work; and
- (e) The costs shall be assessed equally, as described in Section 7-12-2151(d), MCA: "each lot, tract, or parcel of land in the district may be assessed an equal amount based upon the total cost of the improvements [and maintenance]"; and
- (f) Pursuant to Section 7-12-2103(2), MCA, "if an increase occurs in the number of benefitted lots, tracts, or parcels within the boundaries of the [amended] district during the term of the bonded indebtedness, the assessment per lot, tract, or parcel then in the district will be recalculated as provided in [Section]7-12-2151(4)",MCA; and

WHEREAS, that the Lewis and Clark County Department of Public Works is authorized and responsible for coordinating proposed improvements and maintenance detailed on Exhibit "B"



for roadways within the District; and

NOW, THEREFORE, BE IT RESOLVED by the Board of County Commissioners:

- 1) That the Board of County Commissioners considers it both advisable and necessary to approve Resolution 2019-24 to levy and assess the property owners within the 4x4 Rural Improvement District, for the purposes of providing services, including and not limited to, soil stabilization and dust control for the 4x4 Road as requested by the petitioners.

- 2) That a Public Hearing was held on February 26, 2019 at 9:00 a.m. in the Chambers of the Board of County Commissioners, at the City-County Building, Helena, Montana, for the purpose of gathering and receiving testimony, input and comments from all interested and or affected users, citizens, persons, associations, corporations, and/or companies.

- 3) Notice of the Public Hearing was published in the Independent Record and the Blackfoot Valley Dispatch, two times with at least six days separating each publication.

INTRODUCED at a regular meeting of the Board of County Commissioners on this 26th Day of February, 2019 by Commission Member Jim McCormick.

PASSED AND APPROVED BY THE BOARD OF COUNTY COMMISSIONERS on this 26th Day of February, 2019.

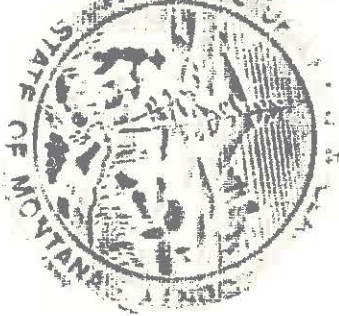

LEWIS AND CLARK COUNTY
BOARD OF COMMISSIONERS

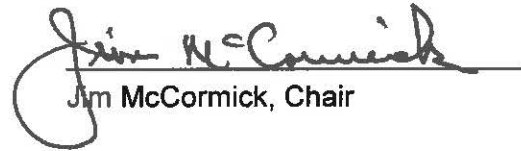
Jim McCormick, Chair

Attest:

Paulette DeHart, Clerk to the Board

Attachments:

- Exhibit "A" to Resolution 2019-24: Map of the 4x4 Rural Improvement District
- Exhibit "B" to Resolution 2019-24: Estimated Maintenance Cost Spreadsheet
- Exhibit "C" to Resolution 2019-24: Properties within the 4x4 Rural Improvement District

Exhibit "A"

TO RESOLUTION 2019-24: MAP OF THE 4X4 RURAL IMPROVEMENT DISTRICT

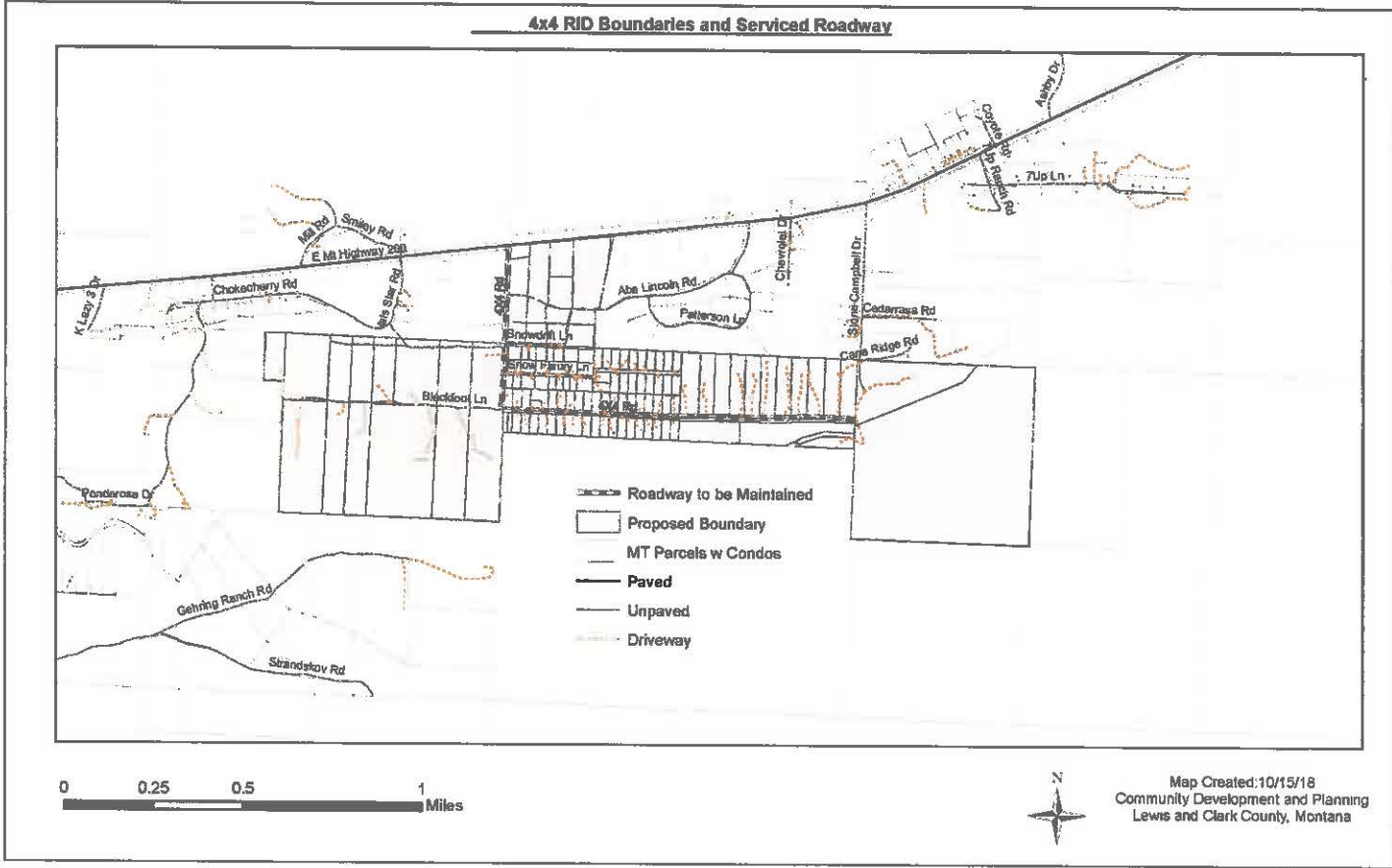

Exhibit "B"

TO RESOLUTION 2019-24: ESTIMATED MAINTENANCE COST SPREADSHEET

4 x 4 Road: Lincoln				
ANNUAL ESTIMATED IMPROVEMENT & MAINTENANCE ASSESSMENT				
Dust Control				\$8,592.00
Grading				\$0.00
Number of Assessments				121
Sub Total				\$8,592.00
5% Admin. Fee (not to exceed \$500)				\$429.60
Total Annual Maintenance Fee				\$9,021.60
ANNUAL ESTIMATED MAINTENANCE ASSESSMENT				\$74.56

Exhibit "C"

TO RESOLUTION 2019-24: PROPERTY OWNERS WITHIN THE 4X4 RURAL IMPROVEMENT DISTRICT

No.	PARCELID	Legal Descr	Owner Name	ESTIMATED MAINTENANCE ASSESSMENT/YEAR
1	0523372120100000	S21, T14 N, R08 W, C.O.S. 553954/B, TRACT 2A, IN E2NW4	BERKHOF RONALD J & DONNA MAE	\$74.56
2	05233722104010000	LEMIRE ACRES SECTION 3, S22, T14 N, R08 W, Lot 1, MAKE FLEETWOOD, MODEL BROADMORE, 14X70 1975	BLANCHER LEROY & LYNDA	\$74.56
3	05233722203010000	TODD ACRES, S22, T14 N, R08 W, BLOCK 1, Lot 1	BLOTKAMP DREW T	\$74.56
4	05233721103150000	S21, T14 N, R08 W, C.O.S. 529869/B, TRACT 5A, IN NW4NE4	BLOWERS GEORGE J JR	\$74.56
5	05233722201170000	TODD ACRES, S22, T14 N, R08 W, BLOCK 2, Lot 10A, MAKE GUERDON, MODEL AMERICAN, COS #607241/AS 26X48 1993	BRIGHAM CASSANDRA E	\$74.56
6	05233715302070000	MOUNTAIN VIEW ESTATES, S15, T14 N, R08 W, Lot A10, COS #3153955	BROWN ARNIE & MICHAEL	\$74.56
7	05233722207090000	DIDRIKSEN TRACTS, S22, T14 N, R08 W, BLOCK 1, E162' OF LT 4	BUSHNELL KENNETH R	\$74.56
8	05233722202010000	LEMIRE ACRES SECTION 1, S22, T14 N, R08 W, BLOCK 2, Lot 1	BUSHNELL KENNETH R	\$74.56
9	05233722202030000	LEMIRE ACRES SECTION 1, S22, T14 N, R08 W, BLOCK 2, Lot 2	BUSHNELL KENNETH R	\$74.56
10	05233722202050000	LEMIRE ACRES SECTION 1, S22, T14 N, R08 W, BLOCK 2, Lot 3	BUSHNELL KENNETH R	\$74.56
11	05233722203100000	TODD ACRES, S22, T14 N, R08 W, BLOCK 1, Lot 6	BUSTER CURTISS G & ROBERTA	\$74.56
12	05233722203080000	TODD ACRES, S22, T14 N, R08 W, BLOCK 1, Lot 4 - S, N 170' LT 4, LT 5 LESS W 30' OF S 128'	BUSTER CURTISS G & ROBERTA	\$74.56
13	05233722207250000	DIDRIKSEN TRACTS, S22, T14 N, R08 W, BLOCK 1, Lot 12	CANNON STEVEN G & LEONA M	\$74.56
14	05233722205060000	DIDRIKSEN TRACTS, S22, T14 N, R08 W, BLOCK 2, Lot 4, E2 OF LOT	CARPENTER RONALD M	\$74.56
15	05233722104190000	LEMIRE ACRES SECTION 3, S22, T14 N, R08 W, Lot 10	CHRISTIAN CHURCH THE	\$74.56
16	05233722104210000	LEMIRE ACRES SECTION 3, S22, T14 N, R08 W, Lot 11	CHRISTIAN CHURCHES OF MONTANA	\$74.56
17	05233723201010000	S23, T14 N, R08 W, C.O.S. 606692, TRACT A, IN N2NW4	CHRISTIAN CHURCHES OF MONTANA	\$74.56

18	05233722205040000	DIDRIKSEN TRACTS, S22, T14 N, R08 W, BLOCK 2, Lot 3	COOK KARI LI	\$74.56
19	05233722204110000	LEMIRE ACRES SECTION 1, S22, T14 N, R08 W, BLOCK 1, Lot 6, COS#220508	CORRIGAN DANIEL L	\$74.56
20	05233722204070000	LEMIRE ACRES SECTION 1, S22, T14 N, R08 W, BLOCK 1, Lot 4	CRAIG KATHRYN M	\$74.56
21	05233722206050000	LEMIRE ACRES SECTION 2, S22, T14 N, R08 W, BLOCK 2, Lot 3	CRAIG KATHRYN M	\$74.56
22	05233722206070000	LEMIRE ACRES SECTION 2, S22, T14 N, R08 W, BLOCK 2, Lot 4	CRAIG KATHRYN M	\$74.56
23	05233722206090000	LEMIRE ACRES SECTION 2, S22, T14 N, R08 W, BLOCK 2, Lot 5	CRAIG KATHRYN M	\$74.56
24	05233722207010000	DIDRIKSEN TRACTS, S22, T14 N, R08 W, BLOCK 1, Lot 1	DAVIS TERRY	\$74.56
25	05233722207030000	DIDRIKSEN TRACTS, S22, T14 N, R08 W, BLOCK 1, W2 OF LT 2	DAVIS TERRY	\$74.56
26	05233722101150000	LEMIRE ACRES SECTION 1, S22, T14 N, R08 W, BLOCK 2, Lot 8, TITLE # M938372, MAKE GUERDON, MODEL HACIENCA, 24X52 1977	DEMPSEY RICHARD O & RUBY K	\$74.56
27	05233722207150000	DIDRIKSEN TRACTS, S22, T14 N, R08 W, BLOCK 1, Lot 7	DENNIS TOM	\$74.56
28	05233715301090000	MOUNTAIN VIEW ESTATES, S15, T14 N, R08 W, Lot A-8, PHASE II COS #3153955	DICKINSON ROBIN L	\$74.56
29	05233722103170000	LEMIRE ACRES SECTION 1, S22, T14 N, R08 W, BLOCK 1, Lot 9	DUFF THOMAS D & VICKI L	\$74.56
30	05233722103190000	LEMIRE ACRES SECTION 1, S22, T14 N, R08 W, BLOCK 1, Lot 10	DUFF THOMAS D & VICKI L	\$74.56
31	05233715302010000	MOUNTAIN VIEW ESTATES, S15, T14 N, R08 W, Lot A-4, COS #3153955	EMERALD POOL HOLDINGS LLC	\$74.56
32	05233722207040000	DIDRIKSEN TRACTS, S22, T14 N, R08 W, BLOCK 2, E2 OF LT 2	ERICKSON ROGER	\$74.56
33	05233722203140000	TODD ACRES, S22, T14 N, R08 W, BLOCK 1, Lot 8	FRANSEN MICHAEL W & ANGELA K	\$74.56
34	05233721101200000	S21, T14 N, R08 W, C.O.S. 520169/B, TRACT 6A, IN N2NE4	FRANK PLUMLEE ROBERT P & KAREN V	\$74.56

35	05233722207060000	DIDRIKSEN TRACTS, S22, T14 N, R08 W, BLOCK 1, W 3/4 OF LT 3	FRY SCOTT K & KRISTIE K	\$74.56
36	05233722104150000	LEMIRE ACRES SECTION 3, S22, T14 N, R08 W, Lot 8	GARDNER EARL D	\$74.56
37	05233721101100000	S21, T14 N, R08 W, C.O.S. 497368/E, TRACT 4, IN W2W2NE4	GARMAN KURT & SHANNON	\$74.56
38	05233715301110000	MOUNTAIN VIEW ESTATES, S15, T14 N, R08 W, Lot A-14, PHASE II LOT COS #3153955	GILLILAND JASON & LORI	\$74.56
39	05233722104110000	LEMIRE ACRES SECTION 3, S22, T14 N, R08 W, Lot 6	GREFANY KADE DEE & PATRICK	\$74.56
40	05233722204090000	LEMIRE ACRES SECTION 1, S22, T14 N, R08 W, BLOCK 1, Lot 5	GUNNESS REBECCA A &	\$74.56
41	05233715301010000	MOUNTAIN VIEW ESTATES, S15, T14 N, R08 W, Lot A-2, COS #3153955 PHASE II	GYGER STEVEN PAUL & DEBRA JO	\$74.56
42	05233722202110000	LEMIRE ACRES SECTION 1, S22, T14 N, R08 W, BLOCK 2, Lot 6	HAGEN MICHAEL T & MARY K	\$74.56
43	05233722201020000	TODD ACRES, S22, T14 N, R08 W, BLOCK 2, Lot 2	HAGEN WAYNE A & CRAIG M & STEVEN D	\$74.56
44	05233722203060000	TODD ACRES, S22, T14 N, R08 W, BLOCK 1, Lot 4 - 5, S 128.4 LT 4 W 30 OF S 129 LT 5	HEMMER SUSAN M & F RAYMOND	\$74.56
45	05233715302030000	MOUNTAIN VIEW ESTATES, S15, T14 N, R08 W, Lot A-5, COS #3121365 PHASE1	HIEB GREGORY JAMES & JANINE L	\$74.56
46	05233722208110000	LEMIRE ACRES SECTION 2, S22, T14 N, R08 W, BLOCK 1, Lot 6, COS# 220609	HILPERT GREGORY P & SHEILA	\$74.56
47	05233722107100000	LEMIRE ACRES SECTION 3, S22, T14 N, R08 W, TRACT 14 COS #248146	HOPKINS CHARLES M JR & SHERYL	\$74.56
48	05233722104030000	LEMIRE ACRES SECTION 3, S22, T14 N, R08 W, Lot 2	JENKINS KEVIN	\$74.56
49	05233722203030000	TODD ACRES, S22, T14 N, R08 W, BLOCK 1, Lot 2	JOHNSON ROBERT R & CHRISTINE P	\$74.56
50	05233715303020000	MOUNTAIN VIEW ESTATES, S15, T14 N, R08 W, Lot A-13, COS #3153955	JORGENSEN WYATT R	\$74.56
51	05233715302090000	MOUNTAIN VIEW ESTATES, S15, T14 N, R08 W, Lot A-6, COS #3153955	JORGENSEN RHETT A	\$74.56
52	05233722205080000	DIDRIKSEN TRACTS, S22, T14 N, R08 W, BLOCK 2	KING JEFFREY G & LISA M	\$74.56

53	05233722201010000	TODD ACRES, S22, T14 N, R08 W, BLOCK 2, Lot 1-A, COS #3142099	LABELLE THOMAS I TRUSTEE	\$74.56
54	05233722104050000	LEMIRE ACRES SECTION 3, S22, T14 N, R08 W, Lot 3	LAY WILLIAM A & BEVERLY L	\$74.56
55	05233722205030000	DIDRIKSEN TRACTS, S22, T14 N, R08 W, BLOCK 2, Lot 1-A, COS #589426	LEE DOUGLAS W	\$74.56
56	05233722205010000	DIDRIKSEN TRACTS, S22, T14 N, R08 W, BLOCK 2, Lot 1-B, COS #589426	LEE DOUGLAS W	\$74.56
57	05233722107050000	LEMIRE ACRES SECTION 3, S22, T14 N, R08 W, Lot 13	LEWIS & CLARK CO PARK	\$74.56
58	05233722204130000	LEMIRE ACRES SECTION 1, S22, T14 N, R08 W, BLOCK 1, Lot 7	LINCOLN PROPERTY TRUST	\$74.56
59	05233722103150000	LEMIRE ACRES SECTION 1, S22, T14 N, R08 W, BLOCK 1, Lot 8	LINCOLN PROPERTY TRUST	\$74.56
60	05233721101250000	S21, T14 N, R08 W, C.O.S. 529869/B, TR 5B IN W2NE	LUNDBERG ERNIE & RENEE RENE	\$74.56
61	05233721101300000	S21, T14 N, R08 W, C.O.S. 527351/B, TRACT 8A, IN E2NE4	LUNDBERG ERNIE & RENEE RENE	\$74.56
62	05233722107010000	LEMIRE ACRES SECTION 3, S22, T14 N, R08 W, Lot 12	MAVIS JOHN B	\$74.56
63	05233722202130000	LEMIRE ACRES SECTION 1, S22, T14 N, R08 W, BLOCK 2, Lot 7	MCMICKLE JOHN C & VICKIE D	\$74.56
64	05233722202070000	LEMIRE ACRES SECTION 1, S22, T14 N, R08 W, BLOCK 2, Lot 4	MEIER STEPHEN L & KALANICK SANDRA L & MEIER SUSAN D	\$74.56
65	05233722203050000	TODD ACRES, S22, T14 N, R08 W, BLOCK 1, Lot 3	MENEELY SCOTT & DINA SAINATO	\$74.56
66	05233722204050000	LEMIRE ACRES SECTION 1, S22, T14 N, R08 W, BLOCK 1, Lot 3	MERTES CALVIN A & GAYLA	\$74.56
67	05233722206110000	LEMIRE ACRES SECTION 2, S22, T14 N, R08 W, BLOCK 2, Lot 6, MAKE ROLLOHOME, MODEL ROLLOHOME, 12X60 1962	MEYER MICHAEL K REVOCABLE TRUST	\$74.56
68	05233723201100000	S23, T14 N, R08 W, C.O.S. 606692/T, TRACT B, IN NW4	MITCHELL JOHN T	\$74.56
69	05233722207110000	DIDRIKSEN TRACTS, S22, T14 N, R08 W, BLOCK 1, Lot 5, MAKE MARLETTE, MODEL MARLETTE, 24X65 1975	NENEMAN TOM & CAROLS	\$74.56

70	05233722207130000	DIDRIKSEN TRACTS, S22, T14 N, R08 W, BLOCK 1, Lot 6	NENEMAN TOM & CAROL S	\$74.56
71	05233722205050000	DIDRIKSEN TRACTS, S22, T14 N, R08 W, BLOCK 2, Lot 4, W2 OF LOT	OEHMCKE SHANE (1/4 INT) &	\$74.56
72	05233722206130000	LEMIRE ACRES SECTION 2, S22, T14 N, R08 W, BLOCK 2, Lot 7	O'LEARY REBECCA	\$74.56
73	05233722208070000	LEMIRE ACRES SECTION 2, S22, T14 N, R08 W, BLOCK 1, Lot 4	OLSON ASHLEY MARIE	\$74.56
74	05233722208090000	LEMIRE ACRES SECTION 2, S22, T14 N, R08 W, BLOCK 1, Lot 5, MAKE DMH, MODEL DETROITER, 12X60 1971	OLSON BRITTANY RAE	\$74.56
75	05233715303010000	MOUNTAIN VIEW ESTATES, S15, T14 N, R08 W, Lot A-12, COS #3121365 PHASE1	OVERSTREET MICHAEL TONY & KRISTIE K	\$74.56
76	05233721101500000	OPRE MINOR SUBD, S21, T14 N, R08 W, Lot 10A-2, COS 607787/S	PARSONS FAMILY ENTERPRISES LLC	\$74.56
77	05233722104090000	LEMIRE ACRES SECTION 3, S22, T14 N, R08 W, Lot 5	PATTISON ROBERT M & SHELLEY J	\$74.56
78	05233722105150000	LEMIRE ACRES SECTION 2, S22, T14 N, R08 W, BLOCK 2, Lot 8	PAYNE MICHAEL F & TINA M	\$74.56
79	05233722208030000	LEMIRE ACRES SECTION 2, S22, T14 N, R08 W, BLOCK 1, Lot 2	PAYNE ROBERT K & KRISTI S	\$74.56
80	05233722208050000	LEMIRE ACRES SECTION 2, S22, T14 N, R08 W, BLOCK 1, Lot 3	PAYNE ROBERT K & KRISTI S	\$74.56
81	05233715301050000	MOUNTAIN VIEW ESTATES, S15, T14 N, R08 W, Lot A-7, PHASE II COS #3153955	PLUMMER CODY A & TARA M	\$74.56
82	05233722207210000	DIDRIKSEN TRACTS, S22, T14 N, R08 W, BLOCK 1, Lot 10, MAKE UNKNOWN, MODEL UNKNOWN, 8X48 1957	QUIGLEY CHRISTEN L & ROBERT J	\$74.56
83	05233722106190000	LEMIRE ACRES SECTION 2, S22, T14 N, R08 W, BLOCK 1, Lot 10, MAKE KARSTEN, MODEL UNKNOWN	ROBINSON DANIEL A & KATHLEEN S	\$74.56
84	05233722204010000	LEMIRE ACRES SECTION 1, S22, T14 N, R08 W, BLOCK 1, Lot 1	ROBINSON DEE JAY	\$74.56
85	05233722205100000	DIDRIKSEN TRACTS, S22, T14 N, R08 W, BLOCK 2, Lot 6	ROBINSON DEE JAY	\$74.56
86	05233722204030000	LEMIRE ACRES SECTION 1, S22, T14 N, R08 W, BLOCK 1, Lot 2	ROBINSON DEE JAY	\$74.56
87	05233722206030000	LEMIRE ACRES SECTION 2, S22, T14 N, R08 W, BLOCK 2, Lot 1 - 2, MAKE UNKNOWN, MODEL AMERICAN, S2 OF LTS 10X51 1961	ROBINSON DEE JAY	\$74.56

88	0523372203160000	TODD ACRES, S22, T14 N, R08 W, BLOCK 1, Lot 9	ROBINSON DEE JAY & RICHARD GUY	\$74.56
89	0523372203180000	TODD ACRES, S22, T14 N, R08 W, BLOCK 1, Lot 10	ROBINSON RICHARD GUY	\$74.56
90	0523372201130000	TODD ACRES, S22, T14 N, R08 W, BLOCK 2, Lot 8A, COS #607241/AS	RUFF ROBERT M & SUZANNE	\$74.56
91	0523372207170000	DIDRIKSEN TRACTS, S22, T14 N, R08 W, BLOCK 1, Lot 8 - 9	SALLIN JESSE F	\$74.56
92	0523372120120000	S21, T14 N, R08 W, C.O.S. 553954/B, TRACT 1A, IN NE4NW4	SCHULKE THOMAS W JR & DINA RAE	\$74.56
93	05233721201150000	S21, T14 N, R08 W, C.O.S. 514979/A, TRACT A, IN NE4NW4	SCHULKE THOMAS W JR & DINA RAE	\$74.56
94	05233715302110000	MOUNTAIN VIEW ESTATES, S15, T14 N, R08 W, Lot A-3, COS #3153955	SIMPSON TERRY	\$74.56
95	0523372203070000	TODD ACRES, S22, T14 N, R08 W, BLOCK 2, Lot 4, COS 152463	SWEENEY CHRISTOPHER L & BROOKE R	\$74.56
96	05233722201090000	TODD ACRES, S22, T14 N, R08 W, BLOCK 2, Lot 5, COS 152463	SWEENEY CHRISTOPHER L & BROOKE R	\$74.56
97	05233722201030000	TODD ACRES, S22, T14 N, R08 W, BLOCK 2, Lot 1-B, COS #3142099	TABARACCI CHARLENE M & WOHLER MARLENE	\$74.56
98	05233722202090000	LEMIRE ACRES SECTION 1, S22, T14 N, R08 W, BLOCK 2, Lot 5	TAMS TONY D & KATHY F	\$74.56
99	05233722201050000	TODD ACRES, S22, T14 N, R08 W, BLOCK 2, Lot 3, C/S 152463	THIELMANN SCOTT LELAND	\$74.56
100	05233722206010000	LEMIRE ACRES SECTION 2, S22, T14 N, R08 W, BLOCK 2, Lot 1 - 2, N2 OF LTS	THORNLEY WILBUR M	\$74.56
101	05233722208010000	LEMIRE ACRES SECTION 2, S22, T14 N, R08 W, BLOCK 1, Lot 1	THOROUGHMAN JAMES L & DEBRA K & CONNIE	\$74.56
102	05233721101400000	OPRE MINOR SUBD, S21, T14 N, R08 W, Lot 10A-1, COS607787/5	TURNER JOSEPH W & REGINA R	\$74.56
103	05233722105170000	LEMIRE ACRES SECTION 2, S22, T14 N, R08 W, BLOCK 2, Lot 9	UFER ROBERTA LYNN TRUSTEE	\$74.56
104	05233722106150000	LEMIRE ACRES SECTION 2, S22, T14 N, R08 W, BLOCK 1, Lot 8	VAN DIEST STANLEY & SHIRLEY	\$74.56
105	05233722207230000	DIDRIKSEN TRACTS, S22, T14 N, R08 W, BLOCK 1, Lot 11	VINES MERLE L	\$74.56

106	05233722205020000	DIDRIKSEN TRACTS, S22, T14 N, R08 W, BLOCK 2, Lot 2	VINES MERLE L & THOMAS A	\$74.56
107	05233722106170000	LEMIRE ACRES SECTION 2, S22, T14 N, R08 W, BLOCK 1, Lot 9, COS# 220609	VONADA ROBERT J & PATRICIA L	\$74.56
108	05233715302050000	MOUNTAIN VIEW ESTATES, S15, T14 N, R08 W, Lot A-11, COS #3121365 PHASE1	WALTER CLIFF & CONNIE K	\$74.56
109	05233722207080000	DIDRIKSEN TRACTS, S22, T14 N, R08 W, BLOCK 1, E2 E2 LT 3 & W50' OF LT 4	WALTER CLIFFORD D & CONNIE K	\$74.56
110	05233722104130000	LEMIRE ACRES SECTION 3, S22, T14 N, R08 W, Lot 7	WEAVER LISA R	\$74.56
111	05233722208130000	LEMIRE ACRES SECTION 2, S22, T14 N, R08 W, BLOCK 1, Lot 7, MAKE CHICKASHA, MODEL INVADER, 12X43 1970	WEBSTER JEROME W	\$74.56
112	05233722105190000	LEMIRE ACRES SECTION 2, S22, T14 N, R08 W, BLOCK 2, Lot 10, MAKE UNKNOWN, MODEL REGENT HOMES, 16X58 2001	WILLIAMSON ROCHELLE ANN	\$74.56
113	05233722101170000	LEMIRE ACRES SECTION 1, S22, T14 N, R08 W, BLOCK 2, Lot 9	WILMOT MICHAEL D & LOUISE A	\$74.56
114	05233722101190000	LEMIRE ACRES SECTION 1, S22, T14 N, R08 W, BLOCK 2, Lot 10	WILMOT MICHAEL D & LOUISE A	\$74.56
115	05233722201100000	TODD ACRES, S22, T14 N, R08 W, BLOCK 2, Lot 6, COS #152463	WILMOT RICHARD L & PAULA M TRUSTEES	\$74.56
116	05233722201110000	TODD ACRES, S22, T14 N, R08 W, BLOCK 2, Lot 7	WILMOT RICHARD L & PAULA M TRUSTEES	\$74.56
117	05233722104070000	LEMIRE ACRES SECTION 3, S22, T14 N, R08 W, Lot 4	WINKLER DAVID L & LINDA J	\$74.56
118	05233722205070000	DIDRIKSEN TRACTS, S22, T14 N, R08 W, BLOCK 2, Lot 5, W2 OF LT	WISCH JERRY LEE	\$74.56
119	05233715301070000	MOUNTAIN VIEW ESTATES, S15, T14 N, R08 W, Lot A-9, PHASE II COS #3153955	WISEMAN ROBERT M & BARBARA L	\$74.56
120	05233722203120000	TODD ACRES, S22, T14 N, R08 W, BLOCK 1, Lot 7	WWFC LLC	\$74.56
121	05233721101050000	S21, T14 N, R08 W, C.O.S. 497358/E, TRACT 3, IN W2W2NE4	ZADICK NANCY G	\$74.56
ESTIMATED TOTAL ANNUAL MAINTENANCE COST FOR 4X4 RID				\$9,021.76